

7

9022

STATE OF INDIANA  
LAKE COUNTY

**MORTGAGE/DEED OF TRUST ASSIGNMENT**

99086051

99 OCT 19 PM 1:18  
6903634753

For value received, CONSECO BANK, INC. ("Assignor"), a corporation organized and existing under the laws of the State of Utah, hereby assigns to GREEN TREE FINANCIAL SERVICING CORPORATION, its successors and assigns, all right, title and interest in an to a certain Mortgage/Deed of Trust dated May 8, 1999, made by Joseph R. Soy Jr. and Michelle Soy, as mortgagor(s), to Conseco Bank, Inc., as mortgagee, as filed in the offices of the County Recorder, County of Lake, State of Indiana, Book \_\_\_\_\_ Page \_\_\_\_\_, together with the Note secured by such mortgage/deed of trust on the following described property situated in the above county and state, to wit:

See attached exhibit A for legal description. Rec. Bk \_\_\_\_\_ Pg \_\_\_\_\_

Instrument # 99047036

Dated this day of JUN 30 1999

CONSECO BANK, INC

By: Julie Larson  
Julie Larson, Authorized Agent

State of Arizona )  
)ss  
County of Maricopa)

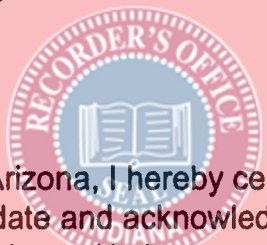

As a Notary Public for the State of Arizona, I hereby certify that Julie Larson personally came before me on this date and acknowledged that she is an Authorized Agent of Conseco Bank, Inc. a Utah corporation, and that by authority duly given and as act of the corporation, the foregoing instrument was signed in its name by him/her.

JUN 30 1999

Witness my hand and official seal dated this day of \_\_\_\_\_

[WHEN RECORDED RETURN TO]  
NTC ATTN: DARRELL COLON  
101 N. BRAND BLVD., SUITE #1800  
GLENDALE, CALIFORNIA 91203  
GREENTREE LOAN: 6903634753

W. R.  
Notary Public

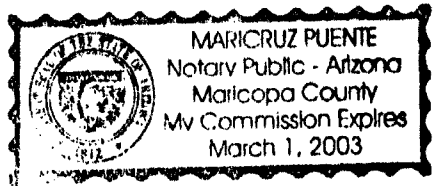

12.00  
299911

**EXHIBIT A**

**Legal Description:**

THE REAL ESTATE AND PREMISES COMMONLY KNOWN AS 3236 165TH STREET, HAMMOND,  
COUNTY OF LAKE, STATE OF INDIANA, AND MORE PARTICULARLY DESCRIBED AS FOLLOWS,  
TO WIT:

LOTS 7 AND 8 IN BLOCK 3 IN THE BALDWIN ADDITION TO GARY, IN THE CITY OF  
HAMMOND, AS PER PLAT THEREOF, RECORDED IN PLAT BOOK 10, PAGE 35, IN THE OFFICE  
OF THE RECORDER LAKE COUNTY, INDIANA.

Parcel ID: 32-5-7

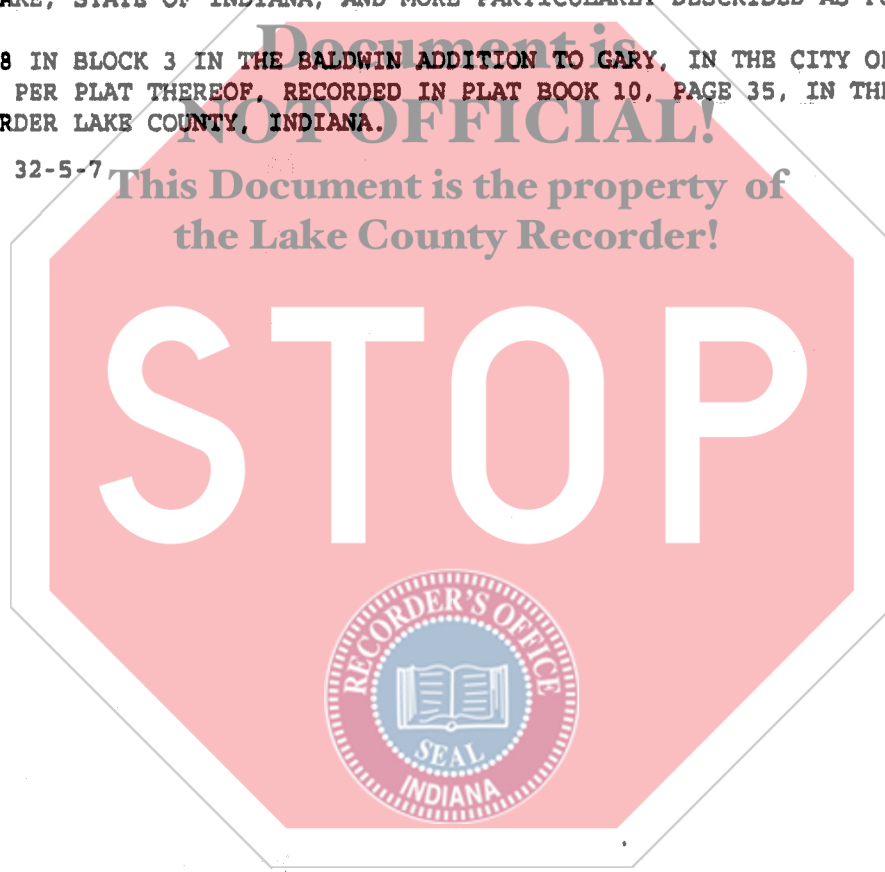

*JLS* *MS*