

STATE OF INDIANA
LAKE COUNTY
FILED FOR RECORD

99 OCT 15 AM 9:28

MORRIS W. CARTER
RECORDER

99085047

ASSIGNMENT OF MORTGAGE

Recording Requested By / Return To:

SMI
Attn: Sherry Doza
P.O. Box 540817, Houston, TX 77254-0817

For Good and Valuable Consideration, the sufficiency of which is hereby acknowledged, the undersigned, CAPSTEAD INC., a Delaware corporation whose address is 2711 N. Haskell Avenue, Suite 1000, Dallas, TX 75204 (Assignor) by these presents does convey, grant, bargain, sell, assign, transfer and set over the described mortgage, together with the certain note(s) described therein with all interest, all liens, and any rights due or to become due thereon to: GMAC MORTGAGE CORPORATION, a Pennsylvania corporation 3451 Hammond Avenue, Waterloo, IA 50702 (Assignee) Said mortgage is recorded in the State of IN, County of Lake on 11/22/93 as Instrument/series/file: 93077884 Original Mortgagor--: DAVID E. KOLISZ, SHERRY A. KOLISZ Original Mortgagee--: LAMPA ENTERPRIZE Date of mortgage: 11/12/93

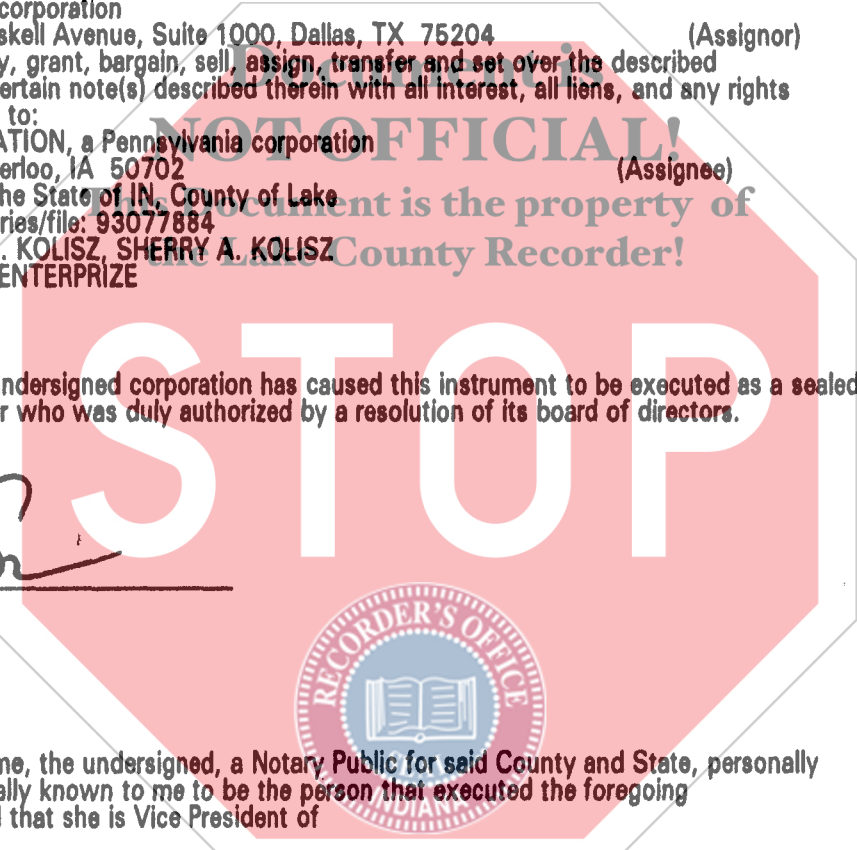

IN WITNESS WHEREOF, the undersigned corporation has caused this instrument to be executed as a sealed instrument by its proper officer who was duly authorized by a resolution of its board of directors. Dated: August 16, 1999 CAPSTEAD INC.

By: [Signature]
Sherry Doza
Vice President

State of Texas
County of Harris

On August 16, 1999, before me, the undersigned, a Notary Public for said County and State, personally appeared Sherry Doza, personally known to me to be the person that executed the foregoing instrument, and acknowledged that she is Vice President of CAPSTEAD INC., and that she executed the foregoing instrument and affixed its corporate seal pursuant to a resolution of its board of directors and that such execution was done as the free act and deed of CAPSTEAD INC..

Notary: [Signature]
My Commission Expires

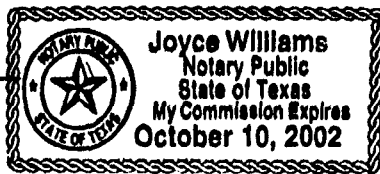

Prepared by: E.N. Harrison, Peelle Management Corp., P.O. Box 1710, Campbell, CA
SMI Track#: 02 - 32339 1st LN#: 0650716475 Invest#: 704531208
FINAL SA.track3 caps682 90682 12 091399 CIN FHL 13-089 IN Lake 103 Seq# 1275

17753



Loan#: 306216620

10-
017303