

STATE OF INDIANA  
LAKE COUNTY  
FILED FOR RECORD

99084902

99 OCT 14 PM 1:33

MORRIS W. CARTER  
RECORDER



# Lake County Trust Company

## This Indenture Witnesseth

That LAKE COUNTY TRUST COMPANY, AS TRUSTEE under the provisions of a Trust Agreement dated July 8, 1977 and known as Trust No. 2557 of Lake County, and State of Indiana, does hereby grant, bargain, sell and convey to:

Chris Lozanovski and Sabrina D. Lozanovski, Husband and Wife

for the sum of ten dollars (\$10.00) and other good and valuable consideration the following described Real Estate in Lake County, in the State of Indiana, to wit:

SEE ATTACHED LEGAL DESCRIPTION.

Commonly known as 2911 East 109th Avenue, Crown Point, IN. 46307

Subject to: Covenants and restrictions; natural and manmade drainage ways; and easements for drainage, streets and utilities and building lines, and other as set forth in the plat, and all other documents of record; and all taxes and assessments (if any).

Mail tax statements and recorded deed to: Chris & Sabrina D. Lozanovski  
5860 East 106th Avenue  
Crown Point, IN. 46307

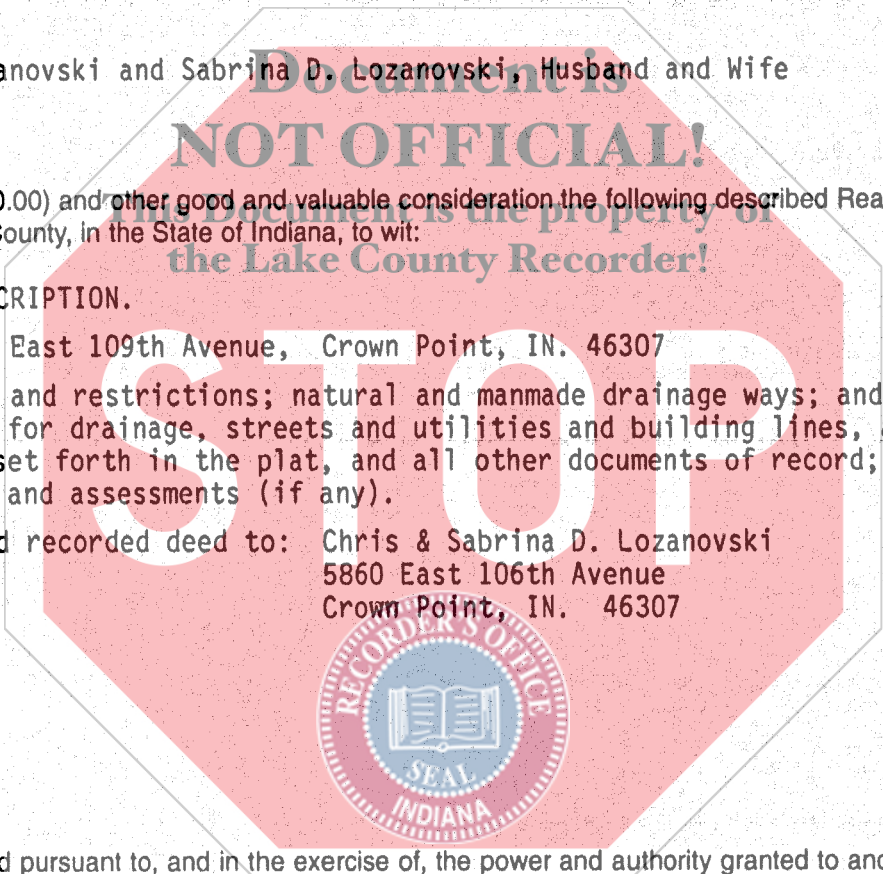

This Deed is executed pursuant to, and in the exercise of, the power and authority granted to and vested in the said Trustee by the terms of said Deed or Deeds in Trust delivered to the said Trustee in pursuance of the Trust Agreement above mentioned, and subject to all restrictions of record.

IN WITNESS WHEREOF, The said LAKE COUNTY TRUST COMPANY, as Trustee, by Elaine M. Sievers as Trust Officer, and Judy Abraham as Assistant Secretary, has hereunto set its hand and seal this 8th day of October, 19 99.

LAKE COUNTY TRUST COMPANY, as Trustee as aforesaid,

By: Elaine M. Sievers  
Elaine M. Sievers Trust Officer

Attest  
Judy Abraham  
Judy Abraham Assistant Secretary

Thomas Simstad  
11471 Lakewood St.  
Crown Point, In 46307

DULY ENTERED FOR TAXATION SUBJECT TO  
FINAL ACCEPTANCE FOR TRANSFER.

OCT 14 1999

PETER BENJAMIN  
LAKE COUNTY AUDITOR

000086

12.00  
per  
case

STATE OF INDIANA }  
COUNTY OF LAKE } SS:

Before me, the undersigned, a Notary Public in and for said County and State personally appeared the within named  
Elaine M. Sievers, as Trust Officer and Judy Abraham

as Assistant Secretary of the Lake County Trust Company, who acknowledge the execution of the foregoing instrument as the free and voluntary act of said corporation, and as their free and voluntary act, acting for such corporation, as Trustee.

Witness my hand and seal this 8th day of October, 1999

  
Sandra L. Stiglitz Notary Public

My Commission Expires: 1-21-2000

Resident of Lake County

This instrument prepared by: Elaine M. Sievers, Attorney at Law

Revised 12/96

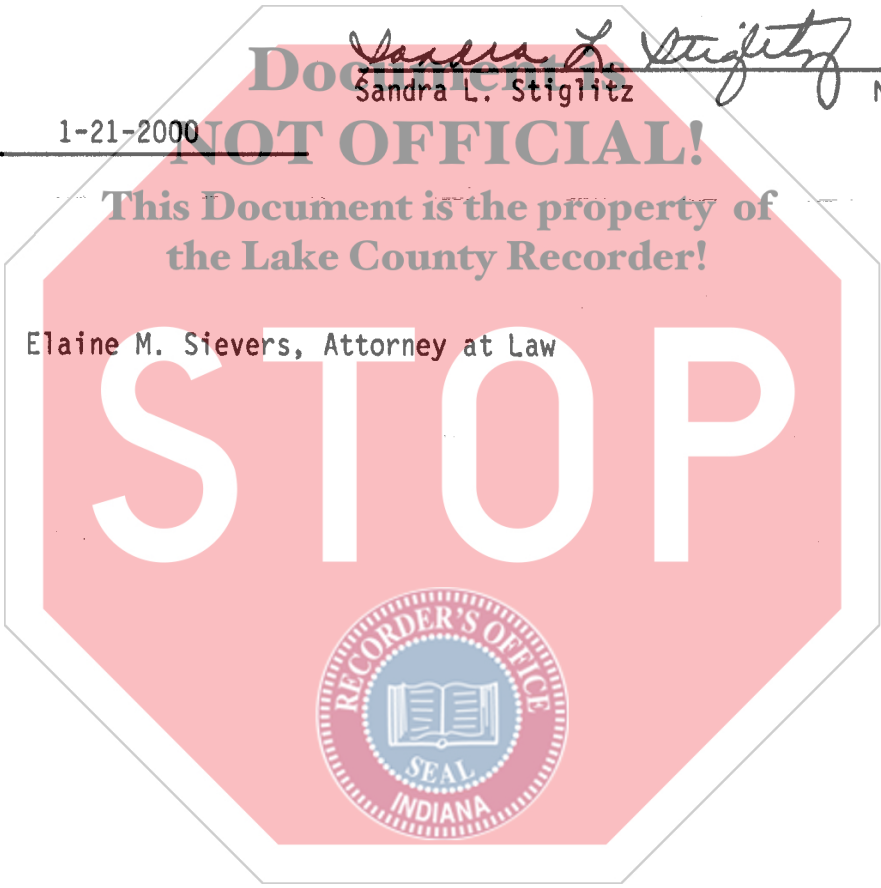

**PARCEL "A":**

PART OF THE NORTHEAST QUARTER OF THE NORTHEAST QUARTER OF SECTION 11, TOWNSHIP 34 NORTH, RANGE 8 WEST OF THE SECOND PRINCIPAL MERIDIAN, IN CENTER TOWNSHIP, LAKE COUNTY, INDIANA, MORE PARTICULARLY DESCRIBED AS FOLLOWS: (BEARINGS IN THIS DESCRIPTION ARE BASED ON A LINE CONNECTING THE MONUMENTS AT THE NORTHWEST AND NORTHEAST CORNERS OF SECTION 11 BEING NORTH 89 DEGREES 58 MINUTES 25 SECONDS EAST) BEGINNING AT A PK NAIL AT A POINT ON THE NORTH LINE OF SAID NORTHEAST QUARTER OF THE NORTHEAST QUARTER OF SECTION 11 AND 165 FEET EAST OF THE NORTHWEST CORNER THEREOF (SAID POINT BEING SOUTH 89 DEGREES 58 MINUTES 25 SECONDS WEST, 1155.95 FEET FROM A MONUMENT AT THE NORTHEAST CORNER OF SAID SECTION 11); THENCE NORTH 89 DEGREES 58 MINUTES 25 SECONDS EAST, 520.00 ALONG SAID NORTH LINE; THENCE SOUTH 00 DEGREES 06 MINUTES 15 SECONDS WEST, 136.18 FEET PARALLEL TO THE WEST LINE OF SAID NORTHEAST QUARTER OF THE NORTHEAST QUARTER OF SECTION 11; THENCE SOUTH 89 DEGREES 58 MINUTES 25 SECONDS WEST, 35.00 FEET PARALLEL TO SAID NORTH LINE; THENCE SOUTH 00 DEGREES 06 MINUTES 15 SECONDS WEST, 149.82 FEET PARALLEL TO SAID WEST LINE; THENCE SOUTH 89 DEGREES 58 MINUTES 25 SECONDS WEST, 485.00 FEET PARALLEL TO SAID NORTH LINE; THENCE NORTH 00 DEGREES 06 MINUTES 15 SECONDS EAST, 286.00 FEET PARALLEL TO SAID WEST LINE TO THE POINT OF BEGINNING, CONTAINING 3.29 ACRES, MORE OR LESS.

A:\parcel-A-B-C-legal descriptions

