

Chicago Title Insurance Company

2

STATE OF INDIANA
LAKE COUNTY
FILED FOR RECORD

99082680

99 OCT -7 AM 9:52

MORRIS W. CARTER
RECORDER

Parcel No. (26) 36-102-22

H-199004909LD

WARRANTY DEED

ORDER NO. 199004909

THIS INDENTURE WITNESSETH, That NORMA MORES

of Cobb County, in the State of Georgia (Grantor)
to Cheryl K. Scott CONVEY(S) AND WARRANT(S)

of Lake County, in the State of INDIANA (Grantee)
for the sum of ONE DOLLAR AND 00/100 Dollars (\$ 1.00)

and other valuable consideration, the receipt and sufficiency of which is hereby acknowledged, the following described real estate in Lake County, State of Indiana:

Lot 18 and the North Half of Lot 19 in Block 3 in South Park Subdivision, in the City of Hammond, as per plat thereof, recorded in Plat Book 11 page 18 in the Office of the Recorder of Lake County, Indiana.

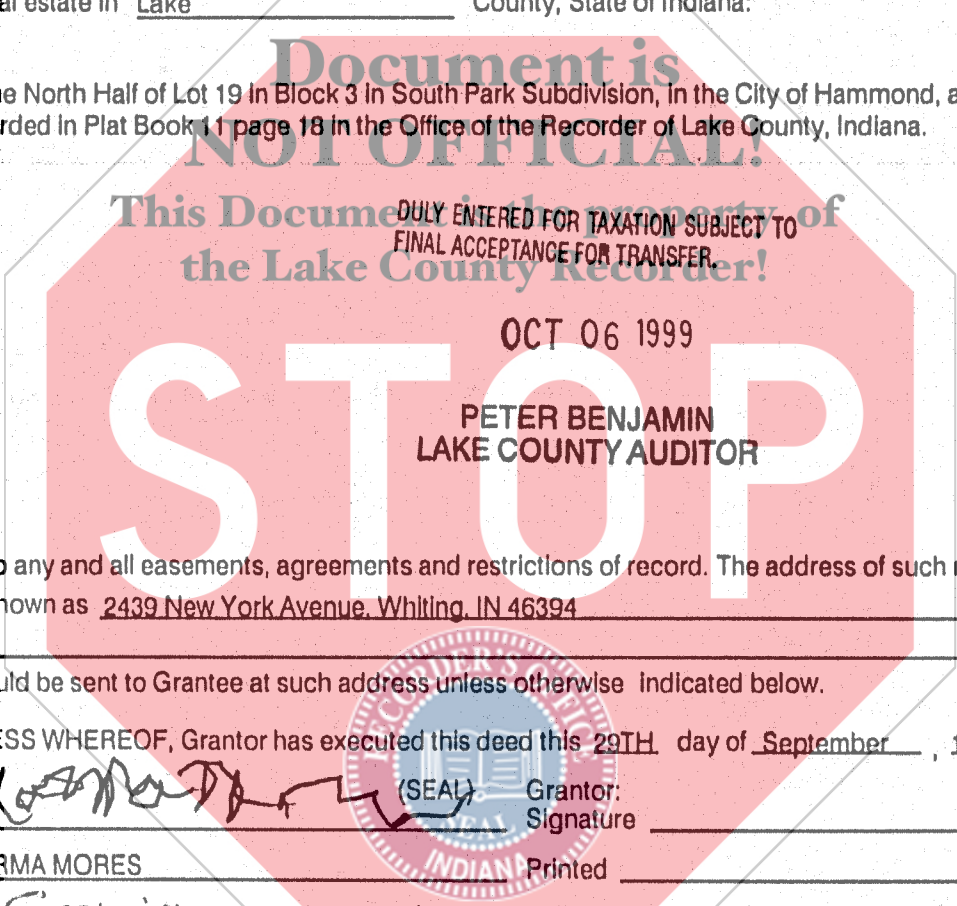

Subject to any and all easements, agreements and restrictions of record. The address of such real estate is commonly known as 2439 New York Avenue, Whiting, IN 46394

Tax bills should be sent to Grantee at such address unless otherwise indicated below.

IN WITNESS WHEREOF, Grantor has executed this deed this 29TH day of September, 1999.

Grantor: [Signature] (SEAL) Grantor: _____ (SEAL)
Signature

Printed NORMA MORES Printed _____

STATE OF Georgia } SS: ACKNOWLEDGEMENT
COUNTY OF Cobb

Before me, a Notary Public in and for said County and State, personally appeared NORMA MORES who acknowledge the execution of the foregoing Warranty Deed, and who, having been duly sworn, stated that any representation therein contained are true. Witness my hand and Notarial Seal this 29TH day of September, 1999.

My commission expires:
Notary Public, Cobb County, Georgia
My Commission Expires November 9, 2001

Signature [Signature]
Printed Marcia Sullivan Notary Name
Resident of _____ County, Indiana.

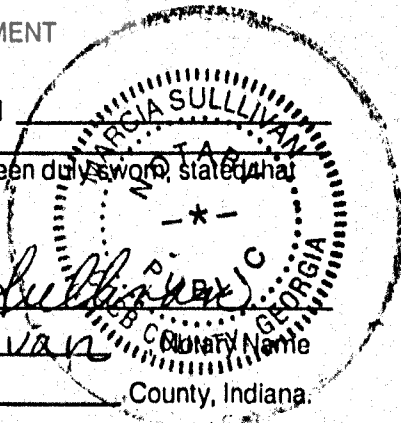

This instrument prepared by NORMA MORES

Return deed to 2439 New York Avenue, Whiting, IN 46394

Send tax bills to 2439 New York Avenue, Whiting, IN 46394

000422

10.00
per
L