

STATE OF INDIANA
LAKE COUNTY
FILED FOR RECORD

99081650

99 OCT -5 AM 9:20

MORRIS W. CARTER
RECORDER

Parcel No. 19-85-5 & 6

WARRANTY DEED

ORDER NO. 099205757 *Hjt.*

THIS INDENTURE WITNESSETH, That ~~GRANOR~~ Frances Vega _____ (Grantor)

of Lake County, in the State of INDIANA CONVEY(S) AND WARRANT(S)
to SAMUEL T. PEDROZA _____ (Grantee)

of Lake County, in the State of INDIANA, for the sum of _____
TEN AND 00/100 Dollars (\$ 10.00)

and other valuable consideration, the receipt and sufficiency of which is hereby acknowledged, the following described real estate in Lake County, State of Indiana:

Lots 10 and 11 in Block 1 in Third Subdivision to East Gary, in the City of Lake Station, as per plat thereof, recorded in Plat Book 10 page 36, in the Office of the Recorder of Lake County, Indiana.

SUBJECT TO PAST AND CURRENT YEAR REAL ESTATE TAXES

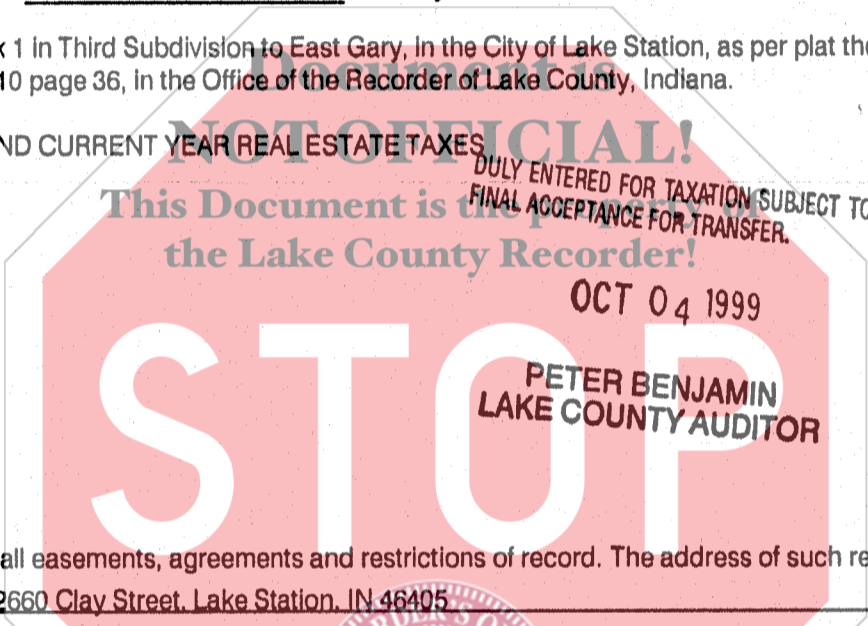

Subject to any and all easements, agreements and restrictions of record. The address of such real estate is commonly known as 2660 Clay Street, Lake Station, IN 46405

Tax bills should be sent to Grantee at such address unless otherwise indicated below.

IN WITNESS WHEREOF, Grantor has executed this deed this 30TH day of September, 1999.

Grantor: Frances Vega (SEAL) Grantor: _____ (SEAL)
Signature _____ Signature _____

Printed FRANCES VEGA Printed _____

STATE OF INDIANA }
COUNTY OF LAKE } SS: ACKNOWLEDGEMENT

Before me, a Notary Public in and for said County and State, personally appeared FRANCES VEGA

who acknowledge the execution of the foregoing Warranty Deed, and who, having been duly sworn, stated that any representation therein contained are true.

Witness my hand and Notarial Seal this 8TH day of December, 1999

My commission expires:
DECEMBER 8, 1999

Signature Jacalyn L. Smith
Printed JACALYN L. SMITH, Notary Name
Resident of LAKE County, Indiana.

This instrument prepared by ATTY. THOMAS K HOFFMAN

Return deed to 2660 Clay Street, Lake Station, IN 46405

Send tax bills to 2660 Clay Street, Lake Station, IN 46405

000120 *10.00 E.P. T.*