

1

STATE OF INDIANA
LAKE COUNTY
FILED FOR RECORD

99081507

99 OCT -4 PM 1:05

Send tax bills to:
505 West 56th Place
Merrillville, Indiana 46410

File No: 9913082 MORRIS W. CARTER
RECORDER

WARRANTY DEED

This Indenture Witnesseth, That Sandra J. English, (Grantor) of Lake County, in the State of Indiana,

Conveys and Warrants to

Richard E. Crook III and Denise Jackson Crook, husband and wife, (Grantee) of Lake County, in the State of Indiana,

for the sum of Ten & 00/100 Dollars (\$10.00) and other valuable consideration, the receipt and sufficiency of which is hereby acknowledged, the following described real estate in Lake County, in the State of Indiana:

LOT 12, BLOCK 1, IN MEADOWLAND ESTATES, PART NO. 2 OF UNIT NO. 2, AS PER PLAT THEREOF, RECORDED IN PLAT BOOK 31, PAGE 7 IN THE OFFICE OF THE RECORDER OF LAKE COUNTY, INDIANA.

Parcel No. 36-15-254-12

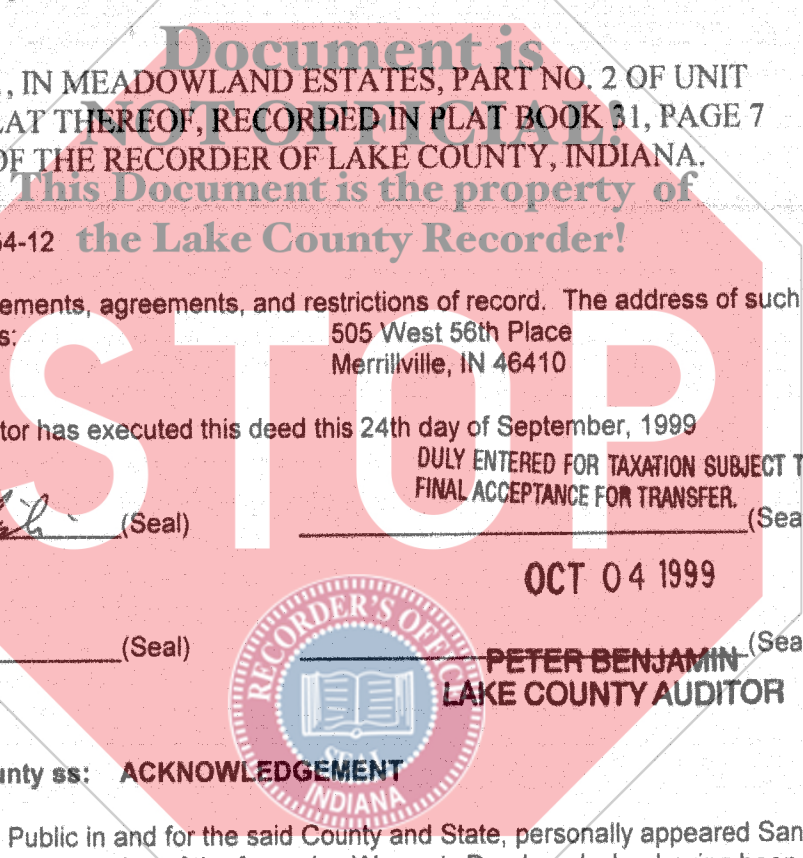

Subject To any and all easements, agreements, and restrictions of record. The address of such real estate is commonly known as:

505 West 56th Place
Merrillville, IN 46410

In Witness Whereof, Grantor has executed this deed this 24th day of September, 1999

DULY ENTERED FOR TAXATION SUBJECT TO
FINAL ACCEPTANCE FOR TRANSFER.

Sandra J. English (Seal)
Sandra J. English

OCT 04 1999

_____ (Seal)

PETER BENJAMIN (Seal)
LAKE COUNTY AUDITOR

State of Indiana, Lake County ss: ACKNOWLEDGEMENT

Before me, a Notary Public in and for the said County and State, personally appeared Sandra J. English, who acknowledged the execution of the foregoing Warranty Deed, and who, having been duly sworn, stated that any representations therein contained are true.

Witness my hand and notarial seal this 24 day of September, 1999

My commission expires:

David M. Bengs

, Notary Public
Residing in County, Indiana

DAVID M BENG
NOTARY PUBLIC STATE OF INDIANA
LA PORTE COUNTY
MY COMMISSION EXP. MAY 24, 2001

This instrument prepared by: David M. Bengs, Attorney at Law.
Return to:

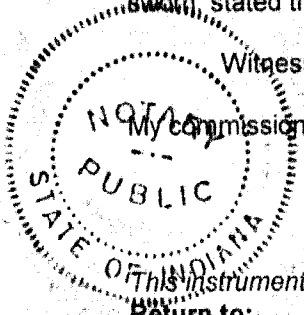

000225

HOLD FOR
Title Express, Inc.
8585 Broadway • Ste. 680
Merrillville, IN 46410

10.00
E.P.
CL#1813