

3

STATE OF INDIANA
LAKE COUNTY
IN THE COURT OF COMMON PLEAS OF PHILADELPHIA COUNTY
FAMILY COURT DIVISION
99075687
CIVIL ACTION - LAW
99 SEP 14 PM 4:03

GWENDOLYN FINCH BEARD
MONTE W. CARTER
RECORDED DECEMBER TERM, 1993

vs. : NO. 8508
ROGER BEARD : IN DIVORCE: SECTION 3301(d)
IRRETRIEVABLE BREAKDOWN
TWO YEAR SEPARATION

JUDICIAL OFFICE IN SUBJECT TO
FINAL ACCEPTANCE FOR TRANSFER

SEP 14 1999

Document is
NOT OFFICIAL!
DECREE and ORDER

This Document is the property of
the Lake County Recorder

PETER BENJAMIN
LAKE COUNTY AUDITOR

NOW, to wit, this 20th day of February, 1996,

it is hereby ORDERED and DECREED that GWENDOLYN FINCH BEARD,
PLAINTIFF, (hereinafter "WIFE"), and ROGER BEARD, DEFENDANT,
(hereinafter "HUSBAND"), are divorced from the bonds of matrimony.

In disposition of the economic claims of the parties, it
is further ORDERED as follows:

1. WIFE is awarded all right, title, and interest in the
real property located at 4416 Johnson Street, Gary, Indiana. WIFE
shall assume sole responsibility for the mortgage, taxes, and other
expenses and obligations associated with said property and shall
indemnify and hold HUSBAND harmless with respect thereto. The
Prothonotary of Philadelphia County is hereby authorized and
empowered, upon Praecept of WIFE, to execute a deed transferring to
WIFE all of HUSBAND'S right, title, and interest in said premises,
which deed shall have the same force and effect as if HUSBAND had
personally signed same.

2. WIFE is awarded all furnishings/personal property

000870

13.00
P.P.
CS

located in the former marital residence at 4416 Johnson Street, Gary, Indiana, free and clear of any claim or interest therein by HUSBAND.

3. Each party is awarded all other property in their respective name or possession and each shall be responsible for all other indebtedness in their individual names.

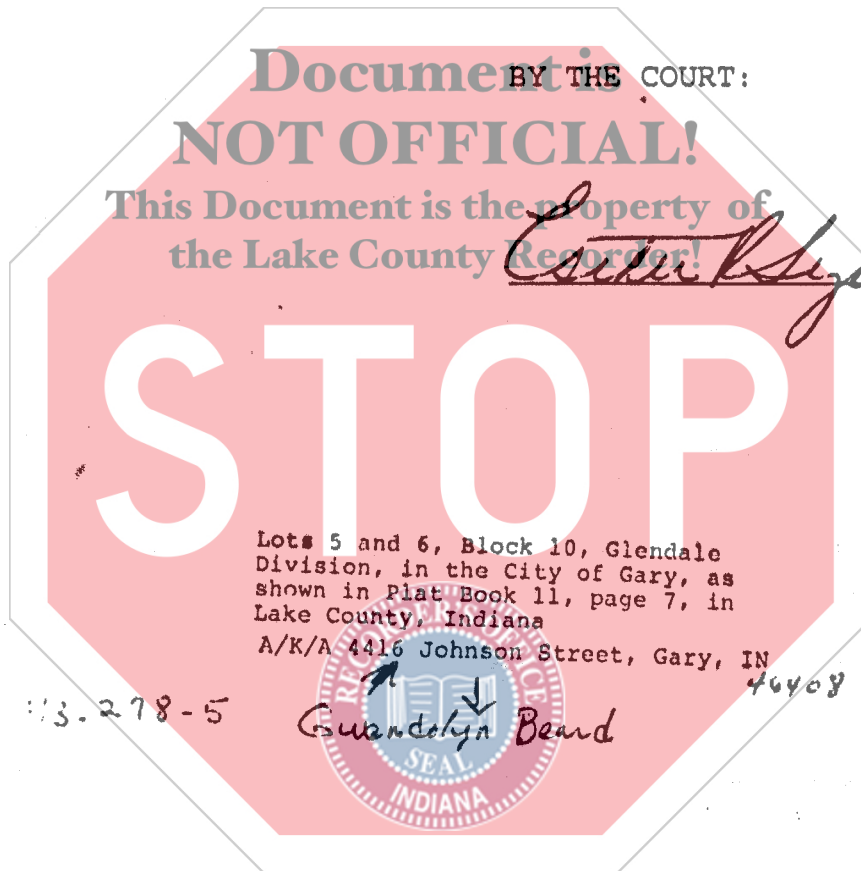

CERTIFIED COPY

from the record in the

**OFFICE OF THE PROTHONOTARY
266 City Hall
Philadelphia, PA 19107**

Document is NOT OFFICIAL!
I DO HEREBY CERTIFY that the attached photostat is a true and correct copy of the Final Decree in the within-entitled case on file in my office.
This Document is the property of the Lake County Recorder!

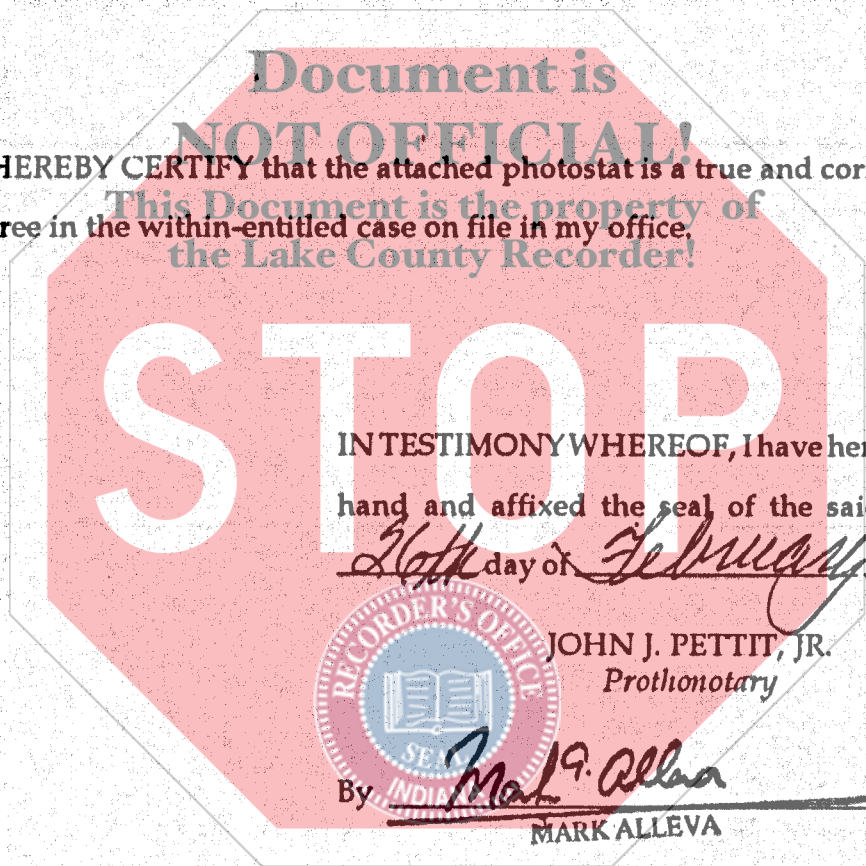

IN TESTIMONY WHEREOF, I have hereunto set my hand and affixed the seal of the said Court this 26th day of February, A.D., 1996

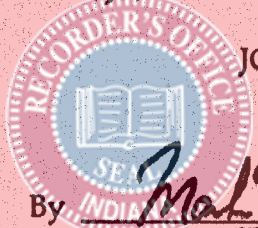

JOHN J. PETTIT, JR.
Prothonotary

By Mark Alleva
MARK ALLEVA

NOTE: The parties hereto are hereby cautioned that a Final Decree in Divorce or in Annulment of Marriage is subject to appeal to the Superior Court at any time within thirty days from the date of the entry thereof by the Court.

◆◆◆◆ PLEASE NOTE ◆◆◆◆
THIS IS NOT AN OFFICIAL CERTIFIED COPY UNLESS THE RAISED SEAL OF THE COURT OF COMMON PLEAS OF PHILADELPHIA COUNTY IS AFFIXED