

H 199004467 LD

99064424

STATE OF INDIANA
LAKE COUNTY
FILED FOR RECORD

99 AUG -3 AM 9:53

Parcel No. (16) 27-496-24

MORRIS W. CARTER
RECORDER

WARRANTY DEED

ORDER NO. 199004467

Chicago Title Insurance Company

THIS INDENTURE WITNESSETH, That MILADIN TRIVUNOVIC AND DARKA TRIVUNOVIC, HUSBAND AND WIFE (Grantor)

of Lake County, in the State of INDIANA CONVEY(S) AND WARRANT(S) to Robert R. Crowel and Alissa L. Crowel, husband and wife (Grantee)

of Lake County, in the State of INDIANA, for the sum of ONE DOLLAR AND 00/100 Dollars (\$ 1.00)

and other valuable consideration, the receipt and sufficiency of which is hereby acknowledged, the following described real estate in Lake County, State of Indiana:

Lot 24 in Pleasant Acres Addition to the Town of Highland, as per plat thereof, recorded in Plat Book 51 page 105, in the Office of the Recorder of Lake County, Indiana.

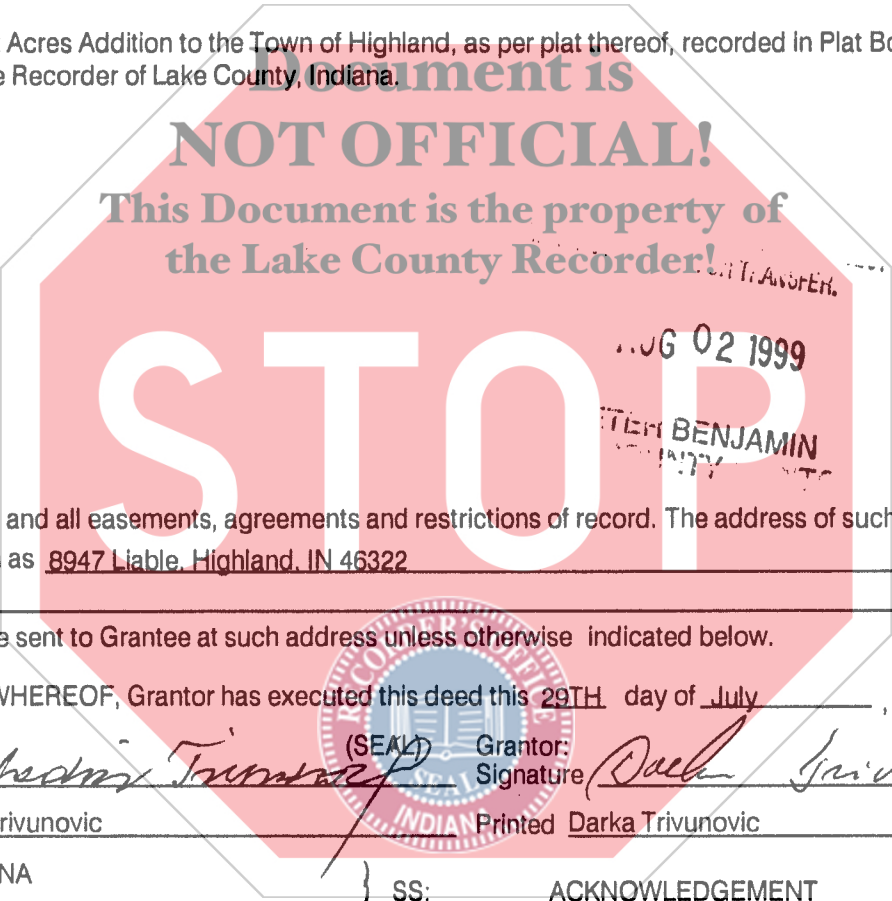

Subject to any and all easements, agreements and restrictions of record. The address of such real estate is commonly known as 8947 Liable, Highland, IN 46322

Tax bills should be sent to Grantee at such address unless otherwise indicated below.

IN WITNESS WHEREOF, Grantor has executed this deed this 29TH day of July, 1999.

Grantor: Miladin Trivunovic (SEAL) Signature Darka Trivunovic (SEAL)
Printed Miladin Trivunovic Printed Darka Trivunovic

STATE OF INDIANA }
COUNTY OF Lake } SS: ACKNOWLEDGEMENT

Before me, a Notary Public in and for said County and State, personally appeared MILADIN TRIVUNOVIC AND DARKA TRIVUNOVIC who acknowledge the execution of the foregoing Warranty Deed, and who, having been duly sworn, stated that any representation therein contained are true.

Witness my hand and Notarial Seal this 29TH day of July, 1999.
My commission expires: JULY 31, 2000
Signature Shirley R. Kasper
Printed SHIRLEY R. KASPER, Notary Name
Resident of LAKE County, Indiana.

This instrument prepared by MILADIN TRIVUNOVIC
Return deed to 8947 Liable, Highland, IN 46322
Send tax bills to 8947 Liable, Highland, IN 46322

10.00
PK
CT
000935