

Chicago Title Insurance Company

STATE OF INDIANA
LAKE COUNTY
FILED FOR RECORD

99 APR -9 AM 9:48

MORRIS W. CARTER
RECORDER

Parcel No. (27) 17-250-13

WARRANTY DEED

ORDER NO. 199001211

THIS INDENTURE WITNESSETH, That Terry R. Stinnett and Shannon M. Stinnett, husband and wife (Grantor)

of Lake County, in the State of INDIANA CONVEY(S) AND WARRANT(S)

to Randy Lee Pendelton (Grantee)

of Lake County, in the State of INDIANA, for the sum of ONE DOLLAR AND 00/100 Dollars (\$ 1.00)

and other valuable consideration, the receipt and sufficiency of which is hereby acknowledged, the following described real estate in Lake County, State of Indiana:

Lot 177 in Glen Wood Addition to Hobart, Unit No. 7, as per plat thereof, recorded in Plat Book 43 page 33, in the Office of the Recorder of Lake County, Indiana.

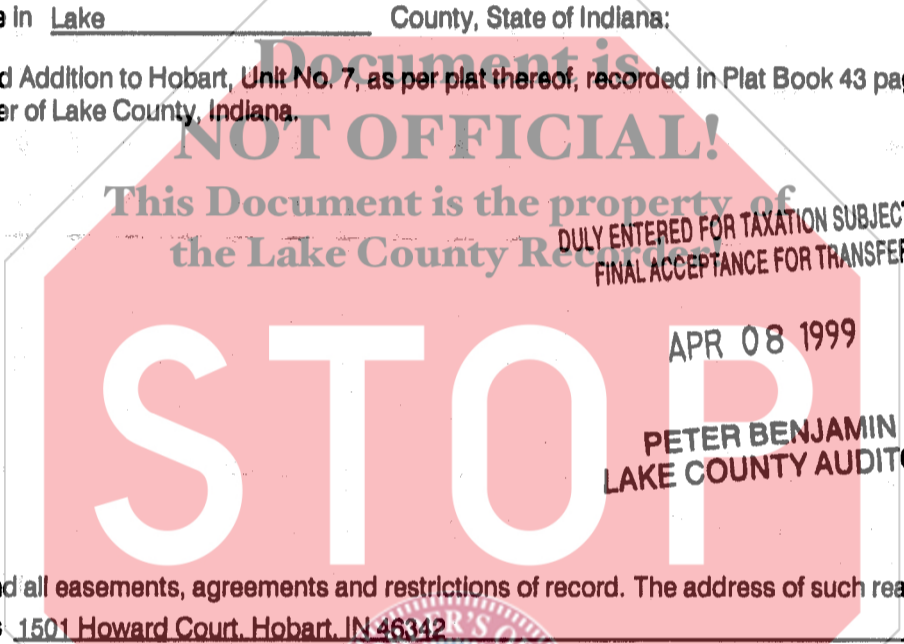

Subject to any and all easements, agreements and restrictions of record. The address of such real estate is commonly known as 1501 Howard Court, Hobart, IN 46342

Tax bills should be sent to Grantee at such address unless otherwise indicated below.

IN WITNESS WHEREOF, Grantor has executed this deed this 31ST day of March, 1999.

Grantor: Terry R. Stinnett (SEAL) Grantor: Shannon M. Stinnett (SEAL)
Signature _____ Signature _____

Printed Terry R. Stinnett Printed Shannon M. Stinnett

STATE OF INDIANA } SS: ACKNOWLEDGEMENT
COUNTY OF Lake }

Before me, a Notary Public in and for said County and State, personally appeared Terry R. Stinnett and Shannon M. Stinnett who acknowledge the execution of the foregoing Warranty Deed, and who, having been duly sworn, stated that any representation therein contained are true.
Witness my hand and Notarial Seal this 31ST day of March, 1999.

My commission expires: JULY 31, 2000 Signature Shirley R. Kasper
Printed SHIRLEY R. KASPER, Notary Name
Resident of LAKE County, Indiana.

This Instrument prepared by Terry Stinnett

Return deed to 1501 Howard Court, Hobart, IN 46342

Send tax bills to 1501 Howard Court, Hobart, IN 46342

000568

10
of
su