

TAX KEY NO. 15-472-23

WARRANTY DEED

THIS INDENTURE WITNESSETH, That **SARAH E. SIMMONS,**
FORMERLY SARAH E. EYRICH

GRANTOR(S) of **LAKE** County in the State of Indiana

Conveys And Warrants To **MARK A. MARKULIN**

of **COOK** County in the State of **ILLINOIS**, as GRANTEE(S)
in consideration of One Dollar and other valuable consideration, the receipt and sufficiency of which are hereby
acknowledged, the following described real estate in **LAKE** County, in the State of Indiana

98101443

LOT 23 IN ROSS MEADOW FARMS, AN ADDITION TO THE TOWN OF MERRILLVILLE, AS PER PLAT THEREOF, RECORDED APRIL 15, 1977 IN PLAT BOOK 47 PAGE 45, IN THE OFFICE OF THE RECORDER OF LAKE COUNTY, INDIANA.

COMMONLY KNOWN AS: 7020 EAST 86TH COURT
MERRILLVILLE, IN 46410

SUBJECT TO SPECIAL ASSESSMENT, ACCRUED BUT NOT YET DUE 1997 TAXES PAYABLE 1998 AND 1998 TAXES PAYABLE IN 1999, AND ALL REAL ESTATE TAXES DUE AND PAYABLE HEREAFTER

SUBJECT TO EASEMENT, RESTRICTIONS AND COVENANTS OF RECORD, IF ANY.

STATE OF INDIANA
LAKE COUNTY
FILED FOR RECORD
98 DEC 8 AM 10:42
MORRIS & CARTER
RECORDER

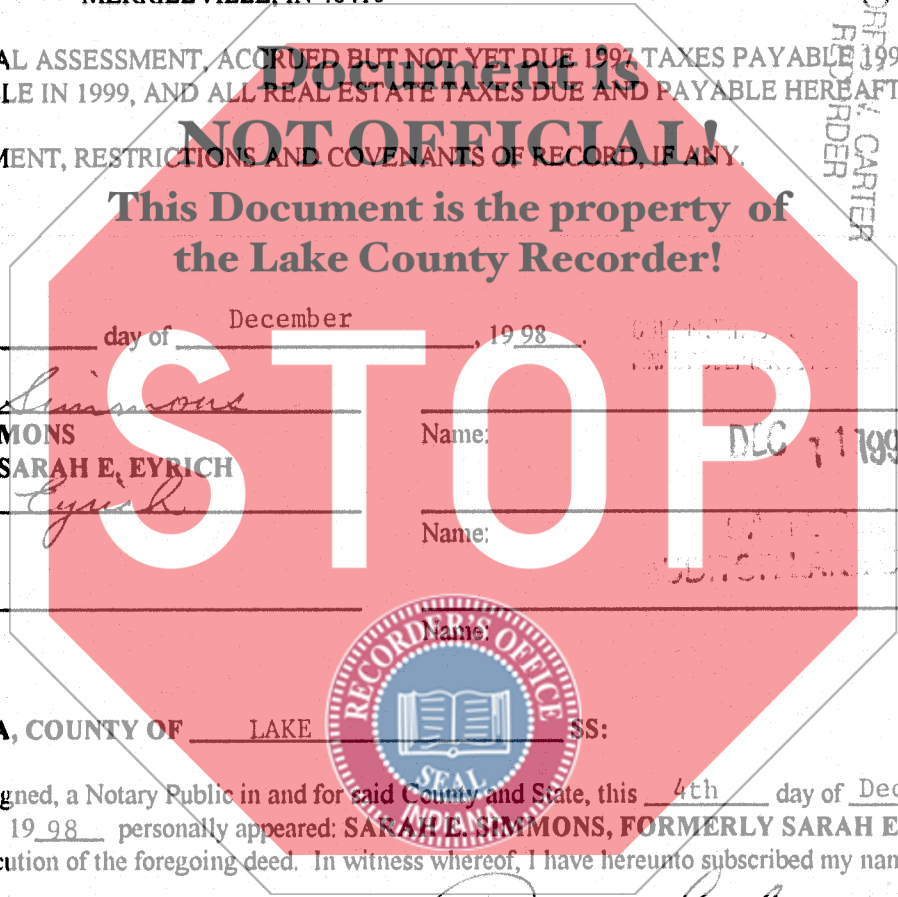

Dated this 4th day of December, 1998

Name: SARA E. SIMMONS Name: DEC 7 1998
FORMERLY SARAH E. EYRICH

Name: Sarah E. Eyrich Name: LAKE COUNTY

Name: _____ Name: _____

STATE OF INDIANA, COUNTY OF LAKE SS:

Before me, the undersigned, a Notary Public in and for said County and State, this 4th day of December, 1998 personally appeared: **SARAH E. SIMMONS, FORMERLY SARAH E.** and acknowledged the execution of the foregoing deed. In witness whereof, I have hereunto subscribed my name and affixed my official seal.

My commission expires: 04/15/08 Signature Patricia Ludington

Resident of Lake County Printed Patricia Ludington, Notary Public

STATE OF _____, COUNTY OF _____ SS:

Before me, the undersigned, a Notary Public in and for said County and State, this _____ day of _____, 19____ personally appeared: _____ acknowledged the execution of the foregoing deed. In witness whereof, I have hereunto subscribed my name and affixed my official seal.

My commission expires: _____ Signature _____

Resident of _____ County Printed _____, Notary Public

This instrument prepared by: **PATRICK J. McMANAMA, Attorney at Law**
Attorney I.D. No.: 9534-45

Return Deed To: MARK A. MARKULIN 7020 E. 86TH CT. MERRILLVILLE, IN 46410
Send Tax Bills To: MARK A. MARKULIN 7020 E. 86TH CT. MERRILLVILLE, IN 46410

000517
11/02/02
COMM
3382