

STATE OF INDIANA  
LAKE COUNTY  
FILED FOR RECORD

98074942

98 SEP 22 AM 11:13

THIS FORM HAS BEEN PREPARED FOR USE IN THE STATE OF INDIANA BY LAWYERS ONLY. THE USE OF THIS FORM OF INSTRUMENT, FILLING IN BLANK SPACES, STRIKING OUT PROVISIONS, AND INSERTION OF SPECIAL CLAUSES, MAY CONSTITUTE THE PRACTICE OF LAW WHICH SHOULD ONLY BE DONE BY A LAWYER.

Mail tax bills to:

270 W. Oakley Ave  
Lowell, In. 46356

# WARRANTY DEED

THIS INDENTURE WITNESSETH, That

\*\*\* WESLEY MOLDEN \*\*\*

("Grantor") of LAKE County in the State of INDIANA CONVEY(S) AND WARRANT(S) TO

\*\*\* JOHN E. LUCAS, SR. AND VERA LUCAS, HUSBAND AND WIFE \*\*\*

("Grantee")

of LAKE County in the State of INDIANA

in consideration of One Dollar and other valuable consideration, the receipt and sufficiency of which are hereby acknowledged, the following described real estate in LAKE County, in the State of Indiana:

LOT 3, BLOCK 3, IN THE TOWN OF SCHNEIDER AS SHOWN IN PLAT BOOK 5 PAGE 16  
IN LAKE COUNTY, INDIANA.

SUBJECT TO: TAXES FOR 1998 AND SUBSEQUENT YEARS.

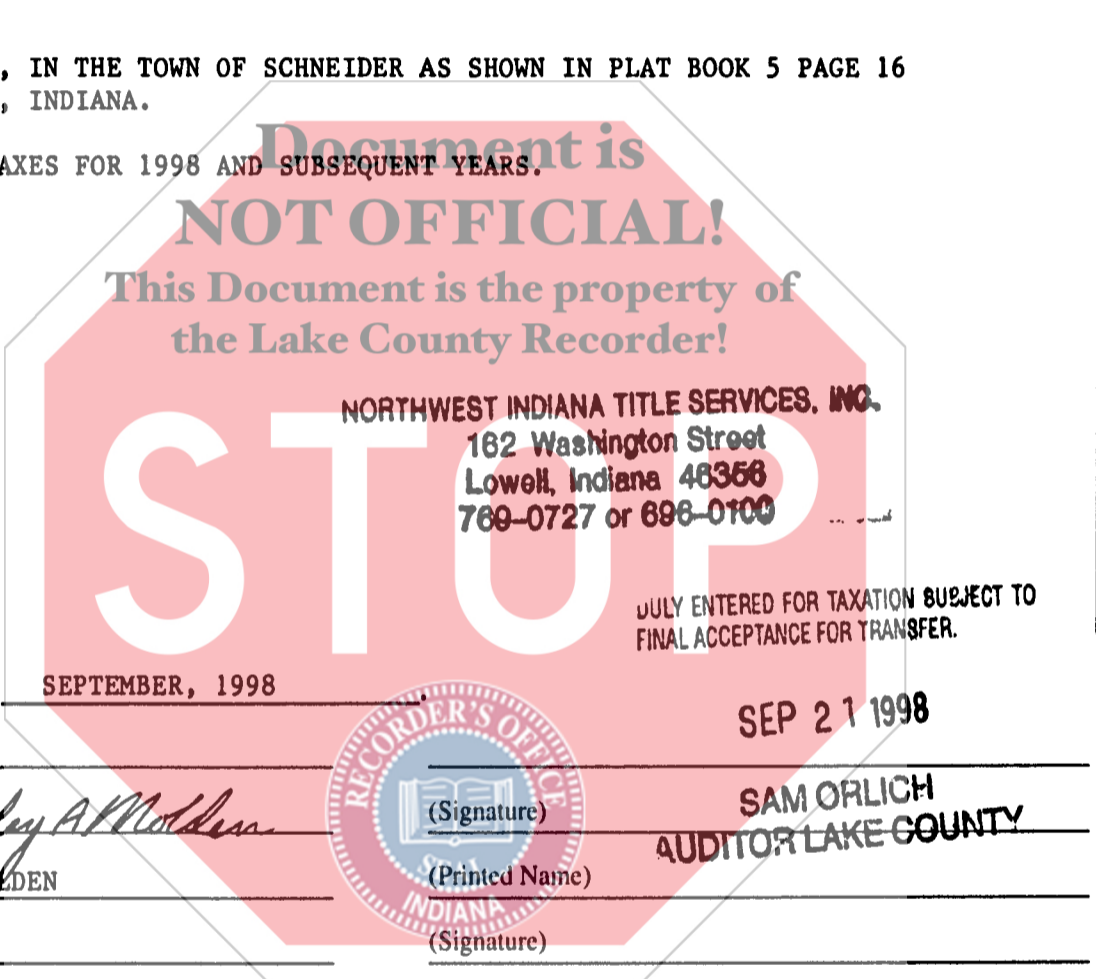

Dated this 10TH day of SEPTEMBER, 1998

SEP 21 1998

(Signature) [Signature]

(Signature) \_\_\_\_\_

SAM ORLICH  
AUDITOR LAKE COUNTY

(Printed Name) WESLEY MOLDEN

(Printed Name) \_\_\_\_\_

(Signature) \_\_\_\_\_

(Signature) \_\_\_\_\_

(Printed Name) \_\_\_\_\_

(Printed Name) \_\_\_\_\_

STATE OF INDIANA, COUNTY OF LAKE SS:

Before me, the undersigned, a Notary Public in and for said County and State, this 10TH day of SEPTEMBER, 1998 personally appeared: \*\*\* WESLEY MOLDEN \*\*\*

and acknowledged the execution of the foregoing deed. In witness whereof, I have hereunto subscribed my name and affixed my official seal.

My commission expires: 9-12-98 Signature [Signature]

Resident of LAKE County Printed RICHARD A. ZUNICA, Notary Public

This instrument prepared by RICHARD A. ZUNICA 162 WASHINGTON STREET, LOWELL, IN 46356, Attorney at Law

MAIL TO:

© COPYRIGHT 1997, THE ALLEN COUNTY INDIANA BAR ASSOCIATION, INC. (REV. 2/98)

001433

1000  
93689