

98070605

STATE OF INDIANA
LAKE COUNTY
FILED FOR RECORD

98 SEP -4 AM 11:17

MORRIS W. GIBSON
RECORDER

LTIC #65083
SEND TAX BILLS TO:
MCA Mortgage
24700 Northwestern Hwy.
Southfield, MI 48075

LAWYERS TITLE INS. CORP.
ONE PROFESSIONAL CENTER
SUITE 215
CROWN POINT, IN 46307

WARRANTY DEED

THIS INDENTURE WITNESSETH, that ROBERT WOLTER, ("Grantor") of Chemung County, State of New York, does hereby convey and warrant to MICHELLE K. EVANS, of Porter County, State of Indiana, for the sum of One Dollar (\$1.00) and other valuable consideration, the following described real estate in Lake County, State of Indiana, to wit:

Lots 4, 5, 6 and 7, and the West half of Lot 3, Block 1, Third Addition to New Chicago, as shown in Plat Book 6, page 11, Lake County, Indiana.

Key #21-22-4, 21-26, 21-22-7, Unit #19, New Chicago Corp.

Subject to the following:

1. Real Estate taxes for the last half of 1997 due and payable in November, 1998, and taxes for all subsequent years, not yet due and payable.
2. Easements, covenants and restrictions contained in prior instruments of record; all building and zoning laws, ordinances, legal drains, right-of-way, and other matters which would be disclosed by an accurate survey of the premises.
3. Liens and encumbrances, if any, created by the acts of the herein grantee.

Dated this 28th day of August, 1998.

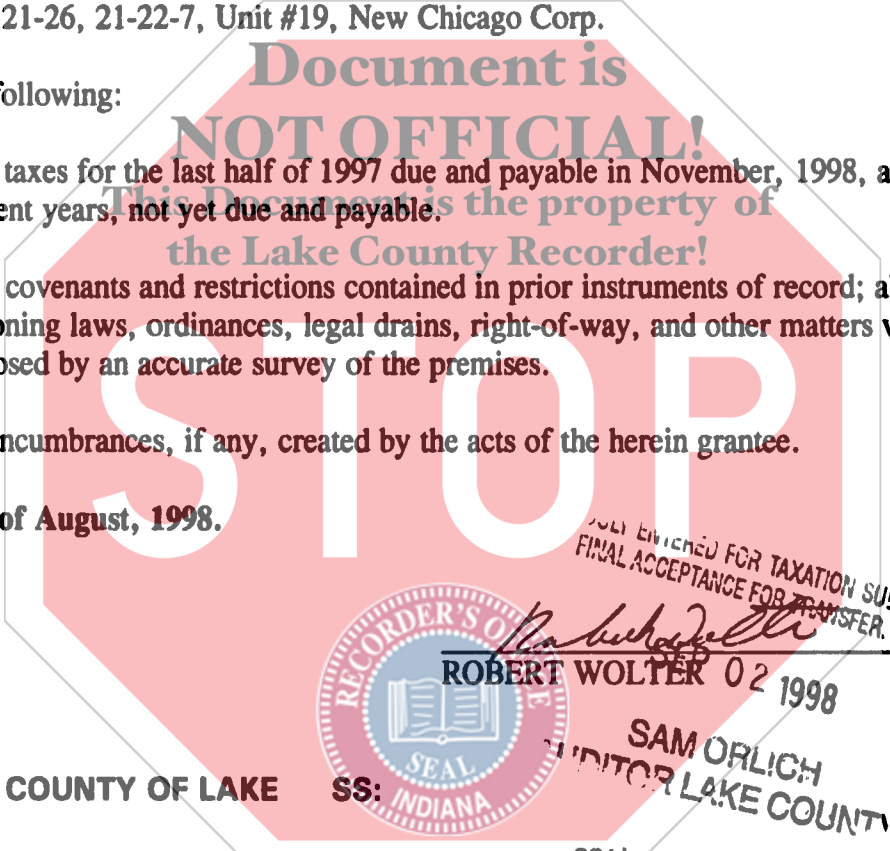

NOT ENTITLED FOR TAXATION SUBJECT TO FINAL ACCEPTANCE FOR TRANSFER.

Robert Wolter
ROBERT WOLTER 02 1998

SAM ORLICH
CLERK LAKE COUNTY

STATE OF INDIANA, COUNTY OF LAKE

Before me, a Notary Public, in and for said County and State, this 28th day of August, 1998, personally appeared Robert Wolter, and who acknowledged the execution of the forgoing Warranty Deed as his free and voluntary act for the purpose of conveying real property. In witness whereof, I have hereunto subscribed my name and affixed my official seal.

My Commission Expires: December 25, 2000

Resident of Lake County

Pamela K. Broadway
Notary Public, Pamela K. Broadway

*This Instrument Prepared by Patricia A. Rees and Judith Kleine,
REES & KLEINE, P.O. Box 488, Hobart, IN 46342*

MAIL TO:

①

000292

1000
24
50