

Mail tax bills to:
12118 N. Emerald
Chicago, IL 60628

WARRANTY DEED

Key No. 47-363-17.

THIS INDENTURE WITNESSETH, That Lamarr C. McGhee

("Grantor") of TARRANT County in the State of Texas
CONVEYS AND WARRANTS TO Jerome Hamilton

of Lake County in the State of Indiana
in consideration of One Dollar and other valuable consideration, the receipt and sufficiency of which are hereby acknowledged, the following described real estate in Lake County, in the State of Indiana:

The South 20 feet of Lot 15 and the North 30 feet of Lot 16 in Block 2 in G.E. Wulfing's First Addition to Gary, as per plat thereof, recorded in Plat Book 21 page 19, in the Office of the Recorder of Lake County, Indiana.

Subject to real estate taxes for 1998 due and payable in 1999 and thereafter.
Subject to all covenants, conditions, restrictions, liens and easements of record.

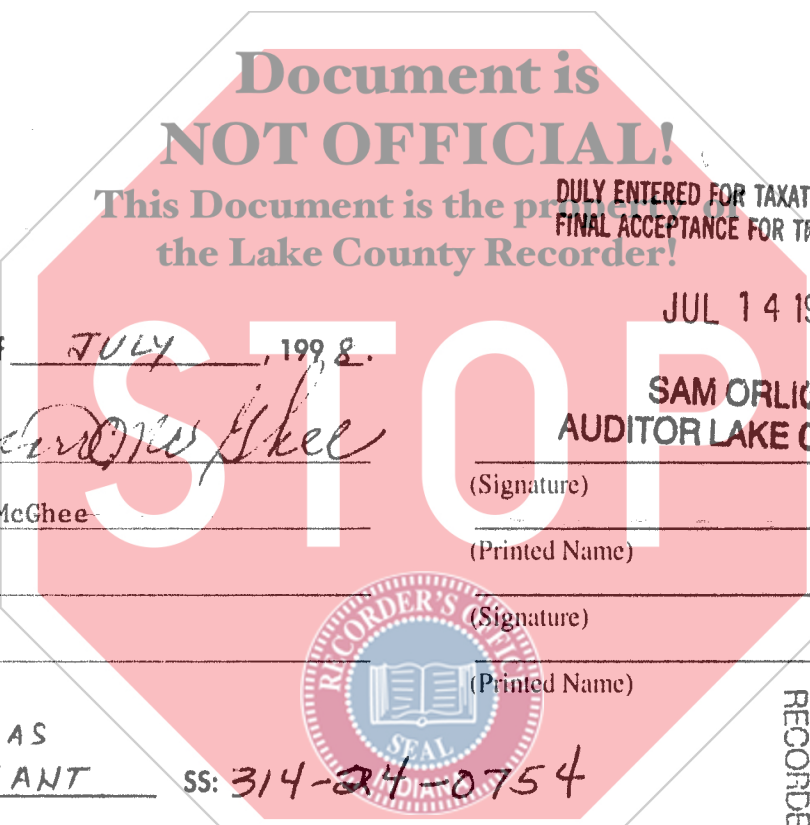

Dated this 8th day of JULY, 1998.

Lamarr C. McGhee
(Signature)
Lamarr C. McGhee
(Printed Name)

DULY ENTERED FOR TAXATION SUBJECT TO
FINAL ACCEPTANCE FOR TRANSFER
JUL 14 1998
SAM ORLICH
AUDITOR LAKE COUNTY

(Signature)
(Printed Name)

(Signature)
(Printed Name)

STATE OF ~~INDIANA~~ TEXAS
COUNTY OF TARRANT SS: 314-24-0754

98 JUL 15 AM 9:3
MORRIS W. CAULFIELD
RECORDER
STATE OF INDIANA
LAKE COUNTY
FILED FOR RECORD

Before me, the undersigned, a Notary Public in and for said County and State, this 8th day of JULY, 1998, personally appeared: MCGHEE LAMARR C

and acknowledged the execution of the foregoing deed. In witness whereof, I have hereunto subscribed my name and affixed my official seal.
My commission expires: 12-21-2001 Signature Ramesh Sharma
Resident of FT. WORTH TX TARRANT County Printed RAMESH SHARMA

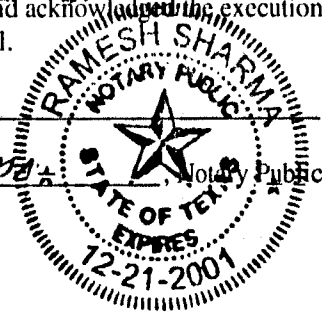

STATE OF _____
COUNTY OF _____ SS:

Before me, the undersigned, a Notary Public in and for said County and State, this _____ day of _____, 199____, personally appeared:

and acknowledged the execution of the foregoing deed. In witness whereof, I have hereunto subscribed my name and affixed my official seal.
My commission expires: _____ Signature _____
Resident of _____ County Printed _____, Notary Public

This instrument prepared by Attorney Marc Lucas Attorney at Law
Attorney Identification No. _____
MAIL TO:

001009 1100
KRM
Ti