

2

98049951

STATE OF INDIANA
JUL 02 1998

A298-10
R298-04

QUITCLAIM DEED

THIS QUITCLAIM DEED, Executed this 29 day of JUNE, 1998 (year),

by first party, Grantor, ROBERT L. WILLIAMS AND JESSIE M. WILLIAMS
whose post office address is 439 N. LIVINGSTON RD. RIDGELAND, MS 39157

to second party, Grantee, MINNIE L. SWAFFORD
whose post office address is 961 WILLARD ST. GARY, IN 46404

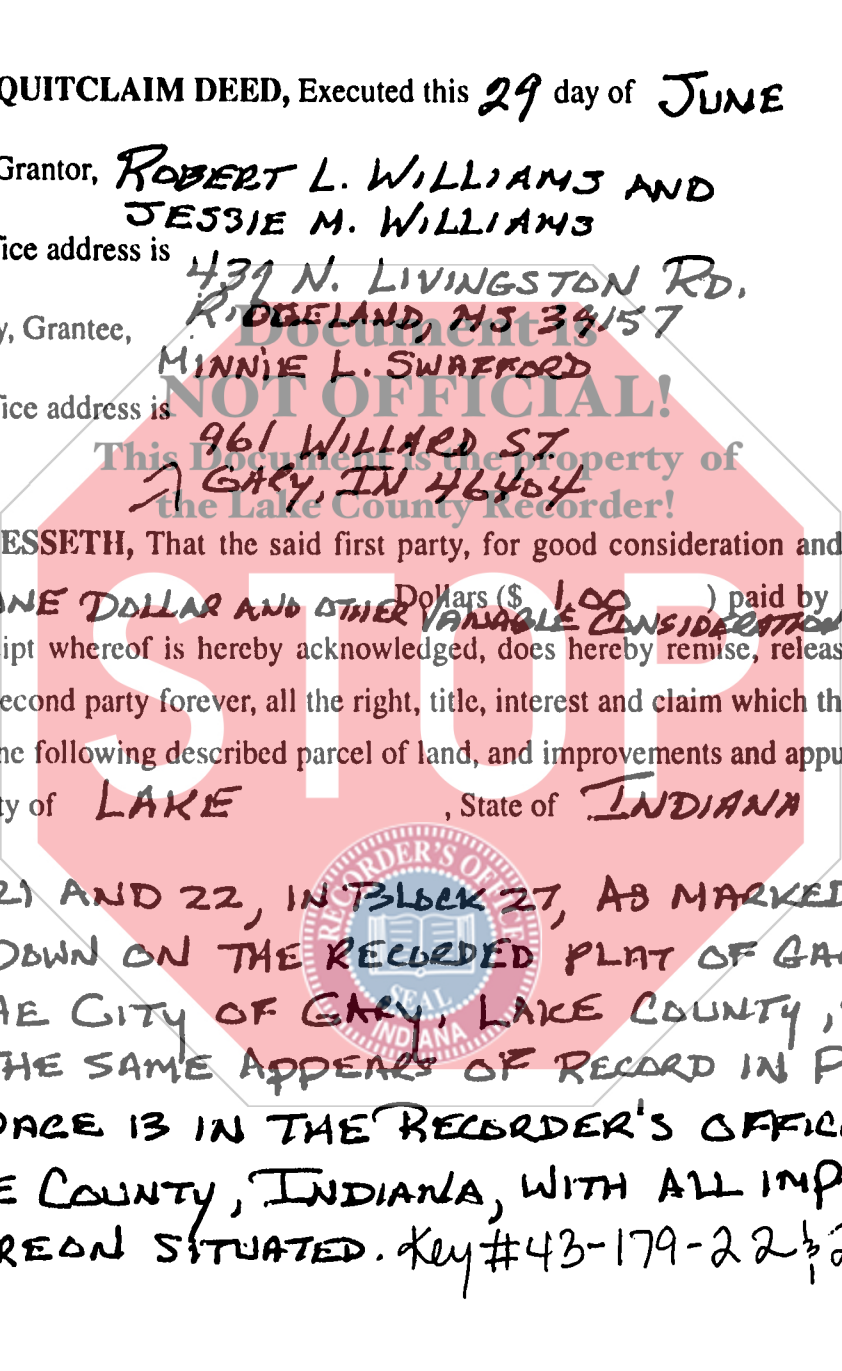

WITNESSETH, That the said first party, for good consideration and for the sum of ONE DOLLAR AND OTHER Dollars (\$ 1.00) paid by the said second party, the receipt whereof is hereby acknowledged, does hereby remise, release and quitclaim unto the said second party forever, all the right, title, interest and claim which the said first party has in and to the following described parcel of land, and improvements and appurtenances there- to in the County of LAKE, State of INDIANA to wit:

LOTS 21 AND 22, IN BLOCK 27, AS MARKED AND LAID DOWN ON THE RECORDED PLAT OF GARY HEIGHTS, IN THE CITY OF GARY, LAKE COUNTY, INDIANA, AS THE SAME APPEARS OF RECORD IN PLAT BOOK 20 PAGE 13 IN THE RECORDER'S OFFICE OF LAKE COUNTY, INDIANA, WITH ALL IMPROVEMENTS THEREON SITUATED. Key #43-179-22 1/2

AKHF
(1)

(Revised 3/98)

If your state requires 8 1/2" x 11" forms, cut off the bottom of this page at the dotted line.
JULY ENTERED FOR TAXATION SUBJECT TO FINAL ACCEPTANCE FOR TRANSFER.

JUL 02 1998

SAM ORLICH
AUDITOR LAKE COUNTY



© E-Z Legal Forms. Before you use this form, read it, fill in all blanks, and make whatever changes are necessary to your particular transaction. Consult a lawyer if you doubt the form's fitness for your purpose and use. E-Z Legal Forms and the retailer make no representation or warranty, express or implied, with respect to the merchantability of this form for an intended use or purpose.

1200
AKW

000202

IN WITNESS WHEREOF, The said first party has signed and sealed these presents the day and year first above written. Signed, sealed and delivered in presence of:

Jessica Q. Egin
Signature of Witness

Robert L. Williams
Signature of First Party

Jessica Q. Egin
Print name of Witness

Robert L. Williams
Print name of First Party

Chester Egin
Signature of Witness

Jessie M. Williams
Signature of First Party

CHESTER EGGIN
Print name of Witness

Jessie M. Williams
Print name of First Party

State of TEXAS)
County of HARRIS
On 6-29-98 before me,
appeared

personally known to me (or proved to me on the basis of satisfactory evidence) to be the person(s) whose name(s) is/are subscribed to the within instrument and acknowledged to me that he/she/they executed the same in his/her/their authorized capacity(ies), and that by his/her/their signature(s) on the instrument the person(s), or the entity upon behalf of which the person(s) acted, executed the instrument.
WITNESS my hand and official seal.

Ernest R. Richey
Signature of Notary

Affiant Known Produced ID
Type of ID DALLAS-210050
(Seal)

State of INDIANA
County of HARRIS LAKE
On 7-02-98 before me,
appeared Mildred L. Dudley

personally known to me (or proved to me on the basis of satisfactory evidence) to be the person(s) whose name(s) is/are subscribed to the within instrument and acknowledged to me that he/she/they executed the same in his/her/their authorized capacity(ies), and that by his/her/their signature(s) on the instrument the person(s), or the entity upon behalf of which the person(s) acted, executed the instrument.
WITNESS my hand and official seal.

Minnie Swafford
Signature of Notary

Affiant Known Produced ID
Type of ID _____
(Seal)

Minnie Swafford
Signature of Preparer

Minnie Swafford
Print Name of Preparer

961 WILLARD ST
Address of Preparer

(2)

If your state requires 8 1/2" x 11" forms, cut off the bottom of this page at the dotted line.