

Lake Federal  
1085  
498257 pdg

STATE OF INDIANA  
LAKE COUNTY  
FILED FOR RECORD

98048563

98 JUN 29 AM 10:01

THIS FORM HAS BEEN PREPARED FOR USE IN THE STATE OF INDIANA BY LAWYERS ONLY. THE SELECTION OF A FORM OF INSTRUMENT, FILLING IN BLANK SPACES, STRIKING OUT PROVISIONS, AND INSERTION OF SPECIAL CLAUSES, MAY CONSTITUTE THE PRACTICE OF LAW WHICH SHOULD ONLY BE DONE BY A LAWYER.

MORRIS W. CRIDER  
RECORDER

MAIL TAX BILLS TO:

# QUITCLAIM DEED

THIS INDENTURE WITNESSETH, that JOHN W. CRIDER

GRANTOR(S) of Lake County in the State of Indiana

QUITCLAIM(S) to JOHN W. CRIDER and FRANKIE CRIDER, husband and wife, as tenants by the entireties.

GRANTEE(S) of Lake County in the State of Indiana

in consideration of One Dollar (\$1.00) and other valuable consideration, the receipt and sufficiency of which are hereby acknowledged, the following described real estate in Lake County, in the State of Indiana:

Lots 2, 3, 4 and 5, Block 25, Village of Shelby, as shown in Plat Book 2, Page 7, in Lake County, Indiana

Commonly known as: 23426 Fillmore Street, Shelby, Indiana 46377  
+ TAX STATEMENT

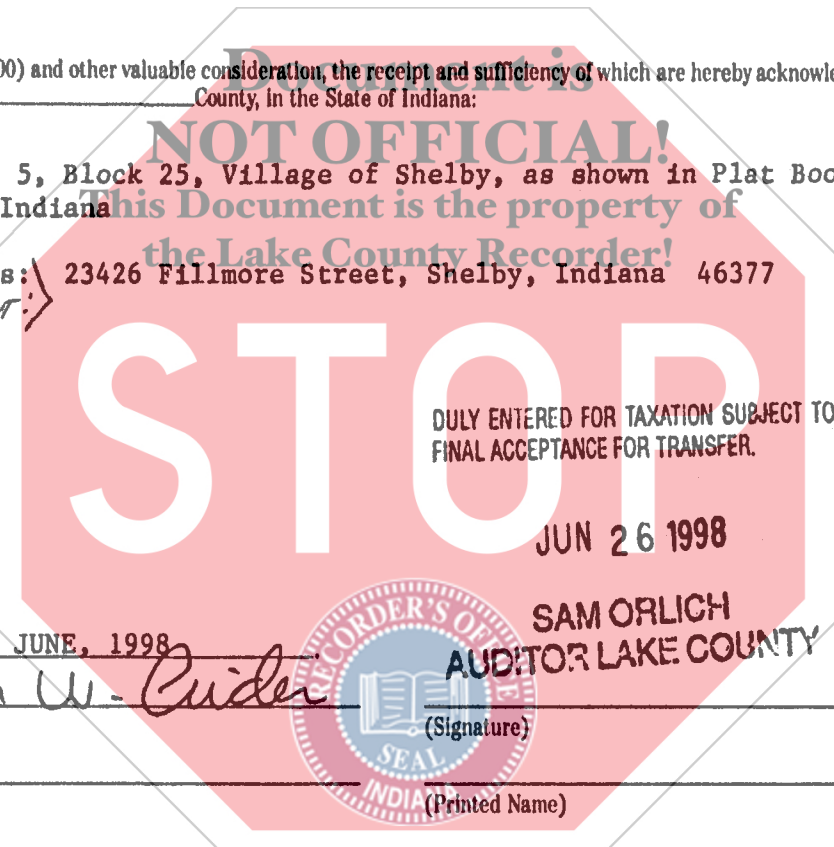

Chicago Life Insurance Company

Dated this 23RD day of JUNE, 1998

(Signature) John W. Crider

(Printed Name) JOHN W. CRIDER

(Signature)

(Printed Name)

(Signature)

(Printed Name)

(Signature)

(Printed Name) NICOLE M MORFAS  
NOTARY PUBLIC STATE OF INDIANA  
LAKE COUNTY  
MY COMMISSION EXP. MAR. 192008

STATE OF INDIANA, COUNTY OF Lake SS:

Before me, the undersigned, a Notary Public in and for said County and State, this 23RD day of JUNE, 1998, personally appeared: JOHN W. CRIDER and acknowledged the execution of the foregoing deed. In witness whereof, I have hereunto subscribed my name and affixed my official seal.

My commission expires: 03/19/08

Signature Nicole M Morfas

Resident of Lake County

Printed NICOLE M. MORFAS, Notary Public

This instrument prepared by Gary K. Matthews Attorney at Law, Attorney No. 9085-45

142 Rimbach, Hammond, IN 46320

MAIL TO:

© COPYRIGHT, THE ALLEN COUNTY INDIANA BAR ASSOCIATION, INC. (REV. 2/97)

10.00  
cm  
CT

001948