

98048319

STATE OF INDIANA  
LAKE COUNTY  
FILED FOR RECORD

98 JUN 26 AM 10:10

MORRIS V. C. ...  
RECORD

**Chicago Title Insurance Company**

**SURVIVORSHIP AFFIDAVIT**

C 498579 W

On this 6/22/98 before me personally appeared  
(insert date)

John D Smith

to me personally known, who being duly sworn on oath did say that:

- 1. Affiant resides at the address given below affiant's signature;
- 2. Affiant is OWNER;  
(state interest of affiant in the above premises as "owner", "son of owner", etc.)

- 3. Said premises were formerly owned as joint tenants or as tenants by the entireties by John D Smith and Grace N Smith;

- 4. Said Grace N. Smith  
(fill in name of co-tenant who died)

died on 1-16-95

leaving No will;  
(insert "a" or "no"; if will left, attach a copy)

- 5. The legal description of the premises in question is:  
Lots 44 & 45, Block 1, Douglas Park addition to Gary, as shown in plat book 8, page 2, in Lake County, IN.

- 6. Is there Federal Estate or State inheritance tax liability by reason of the death of said decedent?  Yes  No

If yes, then estimated taxes due are \$ \_\_\_\_\_

The taxes due are  paid or  unpaid.

Chicago Title Insurance Company

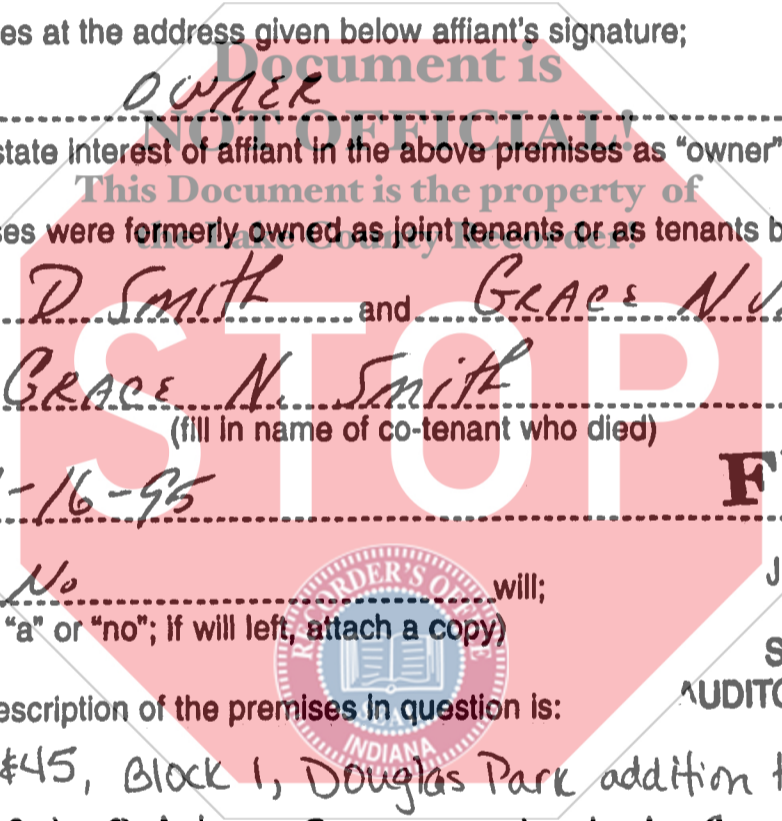

**FILED**

JUN 25 1998

**SAM ORLICH  
AUDITOR LAKE COUNTY**

001825

1200  
Q  
Su

7. Where this affidavit relates to a tenancy by the entireties, were the parties ever divorced?

.....

(If answer is "Yes," identify the divorce proceedings:

.....);

8. Affiant's relationship to the deceased was Husband.....

Signature: John D. Smith.....

Printed Name John D. Smith.....

Address: 2683 HARRISON.....

PORTER, IN 46447.....

Document is NOT OFFICIAL

This Document is the property of the Lake County Recorder

Subscribed and sworn to before me by the affiant

this June 23, 1998.....

(insert date)

Debra Lewis.....  
Notary Public

Printed Name DEBRA LEWIS.....

My County of Residence is: PORTER.....

In the State of INDIANA.....

My Commission Expires 9-9-98.....

This instrument prepared by John D. Smith.....

