

2

98047505

STATE OF INDIANA  
LAKE COUNTY  
FILED FOR RECORD

98 JUN 24 PM 3:10

MORNING STAR  
RECORDS

A298-10  
R298-04

### QUITCLAIM DEED

THIS QUITCLAIM DEED, Executed this Second day of February, 19 98

by first party, Grantor, Phyllis King

whose post office address is 1967 Martin Luther King Drive  
Gary, IN 46407

to second party, Grantee, Samuel Ingram

whose post office address is 1428 E. 21st Avenue  
Gary, IN 46407

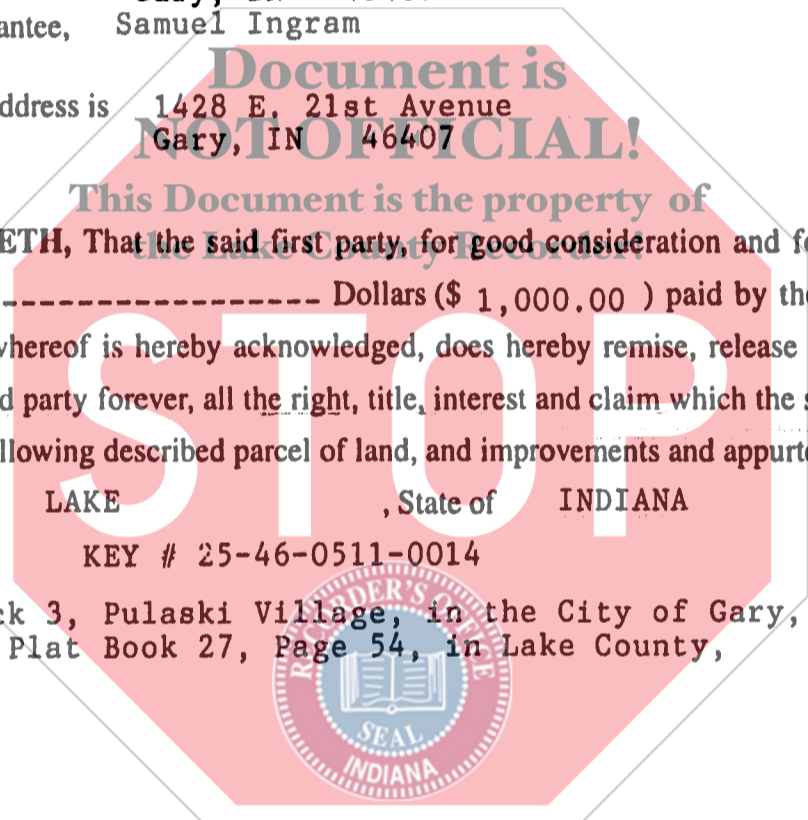

WITNESSETH, That the said first party, for good consideration and for the sum of One Thousand ----- Dollars (\$ 1,000.00 ) paid by the said second party, the receipt whereof is hereby acknowledged, does hereby remise, release and quitclaim unto the said second party forever, all the right, title, interest and claim which the said first party has in and to the following described parcel of land, and improvements and appurtenances there-  
to in the County of LAKE, State of INDIANA to wit:

KEY # 25-46-0511-0014

Lot 14, Block 3, Pulaski Village, in the City of Gary,  
as shown in Plat Book 27, Page 54, in Lake County,  
Indiana.

DULY ENTERED FOR TAXATION SUBJECT TO  
FINAL ACCEPTANCE FOR TRANSFER.

JUN 24 1998

SAM ORLICH  
AUDITOR LAKE COUNTY

ZAHE  
(1)

(Revised 3/97)

-----  
If your state requires 8 1/2" x 11" forms, cut off the bottom of this page at the dotted line.

001776



© E-Z Legal Forms. Before you use this form, read it, fill in all blanks, and make whatever changes are necessary to your particular transaction. Consult a lawyer if you doubt the form's fitness for your purpose and use. E-Z Legal Forms and the retailer make no representation or warranty, express or implied, with respect to the merchantability of this form for an intended use or purpose.

1200  
/km

IN WITNESS WHEREOF, The said first party has signed and sealed these presents the day and year first above written. Signed, sealed and delivered in presence of:

[Signature]  
Signature of Witness

[Signature]  
Signature of First Party

Print name of Witness

Print name of First Party

Signature of Witness

Signature of First Party

Print name of Witness

Print name of First Party

State of INDIANA )  
County of LAKE  
On June 15, 1998 before me,  
appeared Phyllis King,  
personally known to me (or proved to me on the basis of satisfactory evidence) to be the person(s) whose name(s) is/are subscribed to the within instrument and acknowledged to me that he/she/they executed the same in his/her/their authorized capacity(ies), and that by his/her/their signature(s) on the instrument the person(s), or the entity upon behalf of which the person(s) acted, executed the instrument.  
WITNESS my hand and official seal.

[Signature]  
Signature of Notary Glindolyn Johnson

Document is NOT OFFICIAL!  
Document is the property of the Lake County Recorder!

Affiant \_\_\_\_\_ Known \_\_\_\_\_ Produced ID \_\_\_\_\_  
Type of ID \_\_\_\_\_ (Seal)

State of Indiana )  
County of Lake  
On June 15, 1998 before me,  
appeared Phyllis King,  
personally known to me (or proved to me on the basis of satisfactory evidence) to be the person(s) whose name(s) is/are subscribed to the within instrument and acknowledged to me that he/she/they executed the same in his/her/their authorized capacity(ies), and that by his/her/their signature(s) on the instrument the person(s), or the entity upon behalf of which the person(s) acted, executed the instrument.  
WITNESS my hand and official seal.

[Signature]  
Signature of Notary Glindolyn Johnson



Affiant \_\_\_\_\_ Known \_\_\_\_\_ Produced ID \_\_\_\_\_  
Type of ID \_\_\_\_\_ (Seal)

[Signature]  
Signature of Preparer

Print Name of Preparer

Address of Preparer

----- (2) -----  
If your state requires 8 1/2" x 11" forms, cut off the bottom of this page at the dotted line.