

STATE OF INDIANA
LAKE COUNTY
FILED FOR RECORD

98 JUN 16 AM 9:44

MORRIS W. CARTER
RECORDED
TAX I.D. NO.: 10-0002-0004, 10-0031-0014,
10-0031-0016 & 10-0031-0004 UNIT# 11
ADDRESS OF REAL ESTATE:

Lake County, Indiana

Demott St,
4845
497449 M LD

98044964

MAIL TAX BILLS TO:
Harvey H. Gibbs & Maria Gibbs
14561 Montgomery Street
Hebron, IN 46341

WARRANTY DEED

This Indenture Witnesseth That: Alice C. Morrow AKA Alice Morrow

Conveys and Warrants to: Harvey H. Gibbs and Maria Gibbs, Husband and Wife,
for and in consideration of Ten Dollars (\$10.00), and other good and valuable consideration, the receipt whereof is hereby
acknowledged, all of the Right, Title and Interest she has in and to the following Real Estate in Lake County, Indiana, to-wit:

TRACT NO. 1:

ALL THAT PART OF THE SOUTHWEST QUARTER AND THE SOUTH HALF OF THE SOUTHEAST QUARTER OF SECTION 32, TOWNSHIP 34 NORTH, RANGE 7 WEST OF THE SECOND P.M. LYING NORTH OF THE PITTSBURGH, CINCINNATI & ST. LOUIS RAILROAD (NOW PENNSYLVANIA RAILROAD), CONTAINING 121.40 ACRES, MORE OR LESS.

TRACT NO. 2:

THAT PART OF THE NORTH HALF OF THE NORTHEAST QUARTER OF SECTION 5, TOWNSHIP 33 NORTH, RANGE 7 WEST OF THE SECOND P.M. LYING NORTH OF THE PITTSBURGH, CINCINNATI & ST. LOUIS RAILROAD (NOW PENNSYLVANIA RAILROAD), CONTAINING 17.46 ACRES, MORE OR LESS.

TRACT NO. 3:

THE EAST HALF (E 1/2) OF THE SOUTHEAST QUARTER (SE1/4) OF THE NORTHWEST QUARTER (NW1/4) OF SECTION THIRTY-TWO (32), TOWNSHIP THIRTY-FOUR (34) NORTH, RANGE SEVEN (7) WEST OF THE SECOND PRINCIPAL MERIDIAN, CONTAINING TWENTY (20) ACRES, MORE OR LESS.

This conveyance is subject to State, County and City taxes for 1998 payable in 1999, and all subsequent years; all special assessments levied prior to and payable subsequent to the date hereof; building and zoning ordinances now or hereafter in effect; easements; restrictions of record and questions of survey.

Dated this 10 day of May 1998.

Alice C. Morrow

ALICE C. MORROW

DULY ENTERED FOR TAXATION SUBJECT TO
FINAL ACCEPTANCE FOR TRANSFER

JUN 15 1998

SAM ORLICH
AUDITOR LAKE COUNTY

001122

1200
KIM
CT

Chicago Title Insurance Company

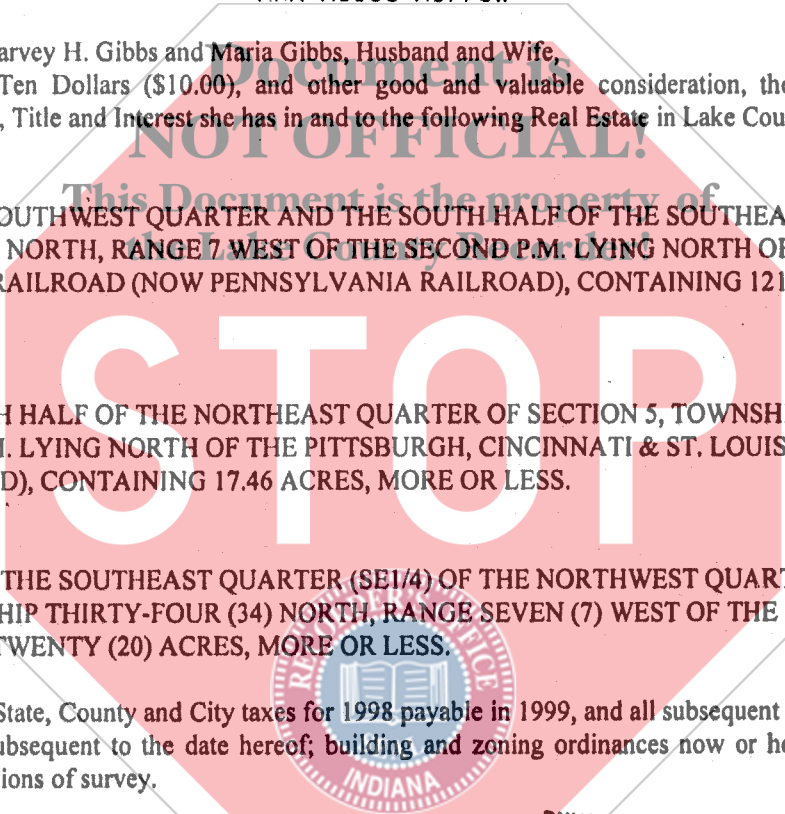

STATE OF INDIANA)
) SS:
COUNTY OF PORTER)

Before me, the undersigned, a Notary Public in and for said County and State, this 6th day of MAY, 1998, personally appeared ALICE C. MORROW, and acknowledged the execution of the foregoing Deed. In Witness Whereof, I have hereunto subscribed my name and affixed my official seal.

Darci R. Bramlet

Notary Public
Resident of PORTER County,
State of INDIANA
DARCI R. BRAMLET
Printed Signature

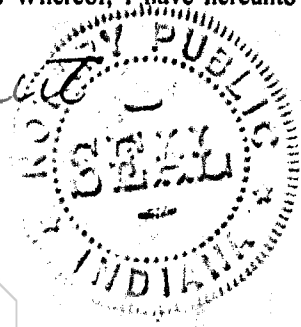

My Commission Expires:
JULY 8, 2001

Document
NOT OFFICIAL!
This Document is the property of
the Lake County Recorder!

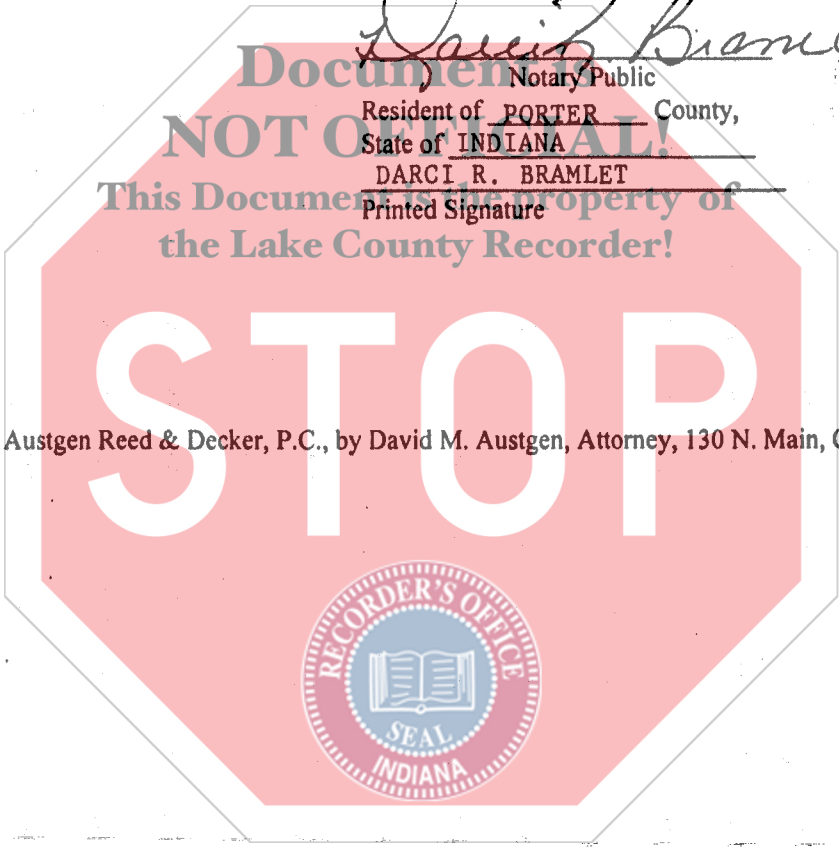

This Instrument prepared by Austgen Reed & Decker, P.C., by David M. Austgen, Attorney, 130 N. Main, Crown Point, IN 46307.