

2

98042550

STATE OF INDIANA
LAKE COUNTY
93 JUN - 8 1998



Lake County Trust Company

This Indenture Witnesseth

That LAKE COUNTY TRUST COMPANY, AS TRUSTEE under the provisions of a Trust Agreement dated December 30, 1994 and known as Trust No. 4619 of Lake County, and State of Indiana,

does hereby grant, bargain, sell and convey to: **Ilija Goreski and Jelka Goreski**
as Husband and Wife

for the sum of ten dollars (\$10.00) and other good and valuable consideration the following described Real Estate in Lake County, in the State of Indiana, to wit:

Lot 67, Trees II, Unit 3, as shown in Plat Book 82, Page 8, in the Office of the Lake County Recorder, Lake County, Indiana

Key NO. 011-44-54-0068-0016

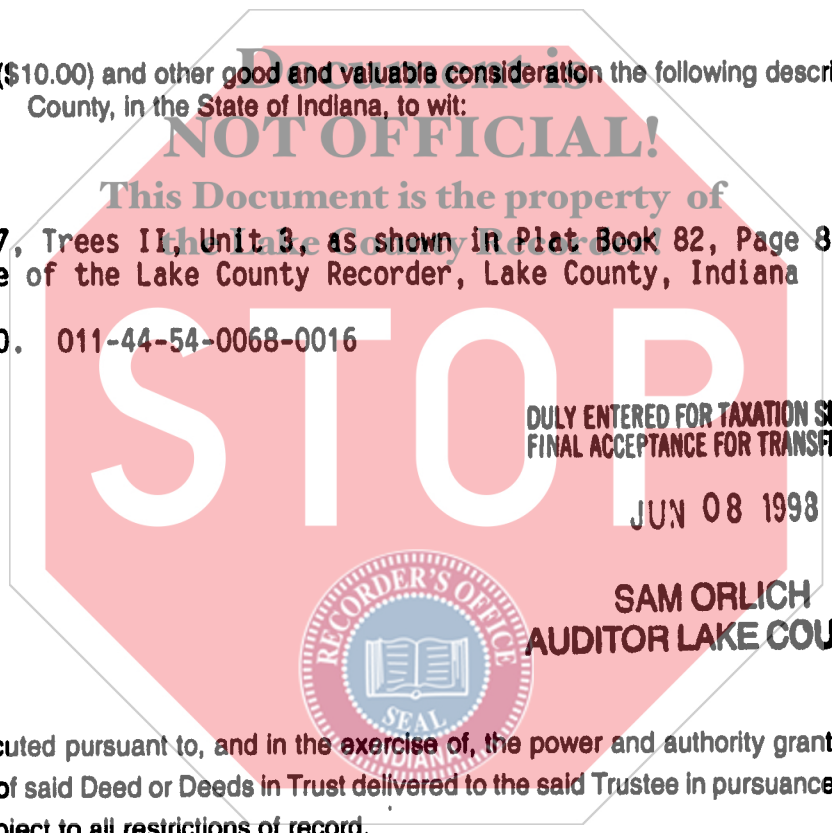

This Deed is executed pursuant to, and in the exercise of, the power and authority granted to and vested in the said Trustee by the terms of said Deed or Deeds in Trust delivered to the said Trustee in pursuance of the Trust Agreement above mentioned, and subject to all restrictions of record.

IN WITNESS WHEREOF, The said LAKE COUNTY TRUST COMPANY, as Trustee, by Elaine M. Worstell as Trust Officer, and Kathy Hathaway as Assistant Secretary, has hereunto set its hand and seal this 4th day of June, 1998.

Attest
Kathy Hathaway
Kathy Hathaway Assistant Secretary

LAKE COUNTY TRUST COMPANY, as Trustee as aforesaid,
By: Elaine M. Worstell
Elaine M. Worstell Trust Officer

ILIJ A GOROSKI
3303 W. 79th AV
MORR 46410

CHK# 1052
000675
12 PM

STATE OF INDIANA }
COUNTY OF LAKE } SS:

Before me, the undersigned, a Notary Public in and for said County and State personally appeared the within named Elaine M. Worstell, as Trust Officer and Kathy Hathaway

as Assistant Secretary of the Lake County Trust Company, who acknowledge the execution of the foregoing instrument as the free and voluntary act of said corporation, and as their free and voluntary act, acting for such corporation, as Trustee.

Witness my hand and seal this 4th day of June, 19 98

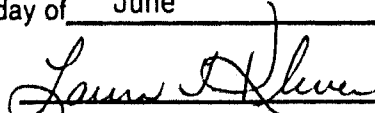

Laura T. Kleven

Notary Public

My Commission Expires: 5-8-2000

Resident of Lake County

This instrument prepared by: Elaine M. Worstell

Revised 12/96

