

1001 202 218 408
B. Bradley

ASSIGNMENT OF REAL ESTATE MORTGAGE

This Deed of Assignment and Assignment of Real Estate Mortgage, made and entered into this 14 day of May, 1998, by and between CALUMET SECURITIES CORPORATION, party of the first part, and Norwest Mortgage, Inc., party of the second part.

WITNESSETH: That for valuable consideration, the receipt of which is hereby acknowledged, the party of the first part does hereby assign, transfer, and set over unto the said Norwest Mortgage, Inc., its successors and assigns, a certain Mortgage Note dated the 14 day of May, 1998 executed and delivered to CALUMET SECURITIES CORPORATION, by Kevin E. Bradley, and assigned to Norwest Mortgage, Inc., together with the mortgage securing the payment of same recorded in Mortgage Book # 98036410, page _____, in the office of the County Clerk of Lake County, Indiana, on the 14th day of May, 1998; and all sums of money due to become due thereon.

IN TESTIMONY WHEREOF, witness the signature of the party of the first part the day and year first above written.

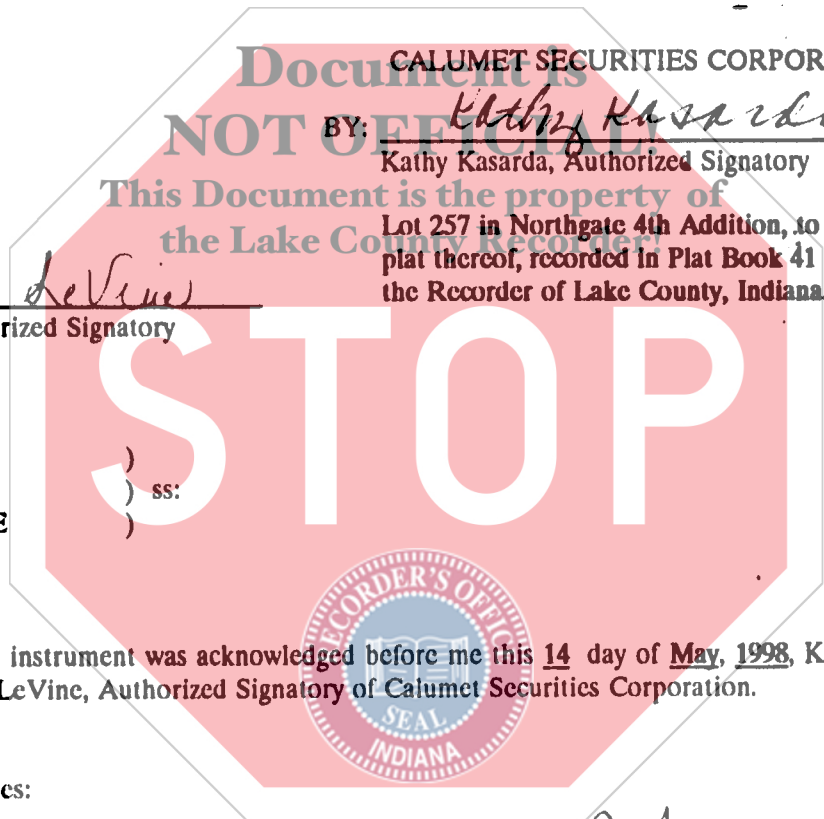

CALUMET SECURITIES CORPORATION
BY: Kathy Kasarda
Kathy Kasarda, Authorized Signatory

ATTEST:

Jenifer LeVine
Jenifer LeVine, Authorized Signatory

Lot 257 in Northgate 4th Addition, to the Town of Dyer, as per plat thereof, recorded in Plat Book 41 page 103, in the Office of the Recorder of Lake County, Indiana.

State of Indiana)
County of LAKE) ss:

The foregoing instrument was acknowledged before me this 14 day of May, 1998, Kathy Kasarda, Authorized Signatory and Jenifer LeVine, Authorized Signatory of Calumet Securities Corporation.

My Commission Expires:
6-9-00
Resident of LAKE County

Bette J. Farmer
Bette J. Farmer



This Instrument Prepared By: DAVID M. OBERLE, EXECUTIVE VICE PRESIDENT OF CALUMET SECURITIES CORPORATION, P. O. Box 208, SCHERERVILLE, INDIANA 46375

1100
Km
Ti