

98042250

RECORDED
INDEXED
JUN 2 1998

THIS FORM HAS BEEN PREPARED FOR USE IN THE STATE OF INDIANA BY LAWYERS ONLY. THE SELECTION OF A FORM OF INSTRUMENT, FILLING IN BLANK SPACES, STRIKING OUT PROVISIONS, AND INSERTION OF SPECIAL CLAUSES, MAY CONSTITUTE THE PRACTICE OF LAW WHICH SHOULD ONLY BE DONE BY A LAWYER.

Mail tax bills to:

1254 Fisher Street
Munster, IN 46321

WARRANTY DEED

THIS INDENTURE WITNESSETH, That PATRICIA A. NORTON

("Grantor") of Lake County in the State of Indiana CONVEY(S) AND WARRANT(S) TO PATRICIA A. NORTON, AS TRUSTEE OF THE PATRICIA A. NORTON DECLARATION OF TRUST ("Grantee") DATED MAY 26, 1998 of Lake County in the State of Indiana in consideration of One Dollar and other valuable consideration, the receipt and sufficiency of which are hereby acknowledged, the following described real estate in Lake County, in the State of Indiana:

Lot 19, Monaldi-Chayes Manor, 2nd Addition to the Town of Munster, as per plat thereof, recorded in the Office of the Recorder of Lake County, Indiana.

(Commonly known as 1254 Fisher Street, Munster, IN)

SUBJECT TO unpaid taxes, if any, defects in locations or measurements ascertainable only by survey, building lines, highways, streets, alleys, easements, covenants, conditions and restrictions of record.

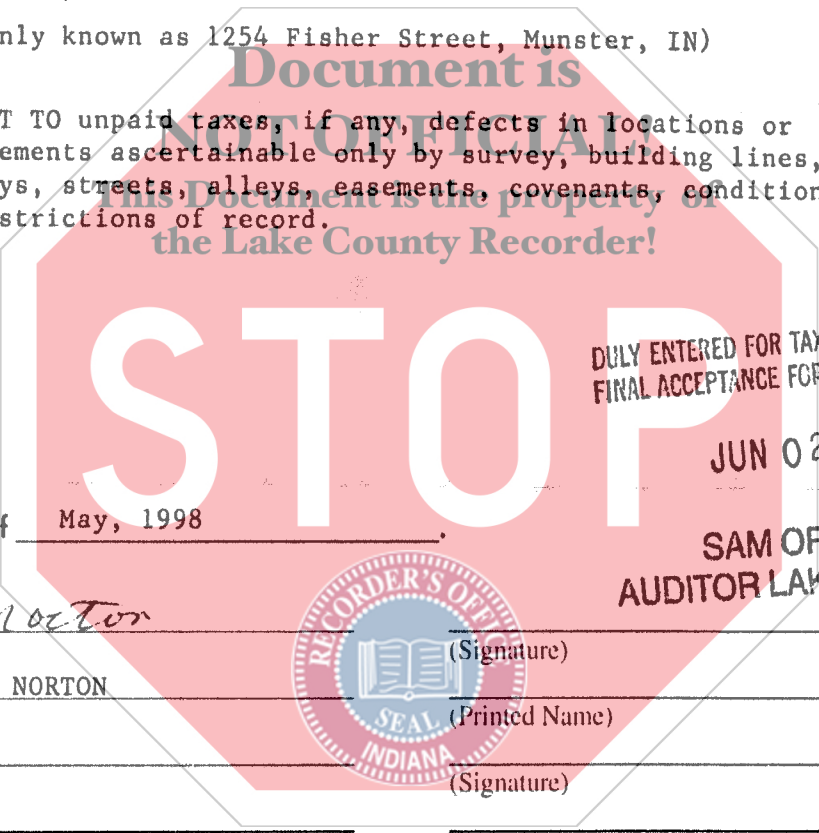

Dated this 26 day of May, 1998

Patricia A. Norton
(Signature)

PATRICIA A. NORTON
(Printed Name)

(Signature)

(Printed Name)

(Signature)

(Printed Name)

(Signature)

(Printed Name)

STATE OF INDIANA, COUNTY OF LAKE SS:

Before me, the undersigned, a Notary Public in and for said County and State, this 26 day of May, 1998 personally appeared: PATRICIA A. NORTON

and acknowledged the execution of the foregoing deed. In witness whereof, I have hereunto subscribed my name and affixed my official seal.

My commission expires: 3/20/00

Signature *Judith A. Osinski*

Resident of Lake County Printed JUDITH A. OSINSKI, Notary Public

This instrument prepared by THOMAS L. KIRSCH, 131 Ridge Road, Munster, IN 46321, Attorney at Law

MAIL TO:



000313

1000
CK# 15004