

98041227

THIS FORM HAS BEEN PREPARED FOR USE IN THE STATE OF INDIANA BY LAWYERS ONLY. THE SELECTION OF A FORM OF INSTRUMENT, FILLING IN BLANK SPACES, STRIKING OUT PROVISIONS, AND INSERTION OF SPECIAL CLAUSES, MAY CONSTITUTE THE PRACTICE OF LAW WHICH SHOULD ONLY BE DONE BY A LAWYER.

Mail tax bills to:

2829 Burge Dr.
Crown Point, IN 46307

WARRANTY DEED Key No. 13-572-74

THIS INDENTURE WITNESSETH, That Jeffrey L. Samels and Jeanine M. Samels, husband and wife

("Grantor") of Lake County in the State of Indiana CONVEY(S) AND WARRANT(S) TO

Eugene L. Yukon and Gina M. Yukon, husband and wife

("Grantee")

of Lake County in the State of Indiana

in consideration of One Dollar and other valuable consideration, the receipt and sufficiency of which are hereby acknowledged, the following described real estate in Lake County, in the State of Indiana:

The real estate and premises commonly known as 2829 Burge Dr., Crown Point, Lake County, Indiana, more particularly described as follows, to-wit:

Lot 74 in Burge Estates, recorded in Plat Book 74 page 27, in the Office of the Recorder of Lake County, Indiana, and amended by a Certificate of Correction recorded August 31, 1993 as Document No. 93057000.

Subject to real estate taxes for 1997 payable in 1998, together with delinquency and penalty, if any, and all real estate taxes due and payable thereafter.

Subject to recorded liens, encumbrances, easements, restrictions, ditches and drains, highways and legal rights of way, and matters which would be disclosed by an accurate survey or inspection of the premises.

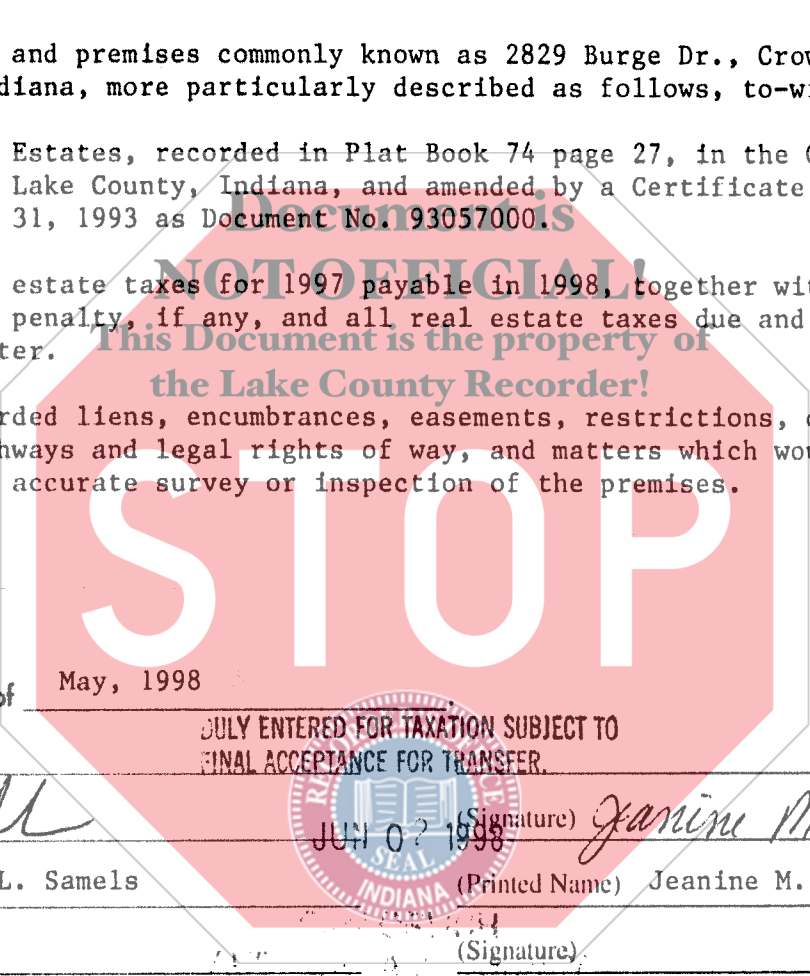

Dated this 29th day of May, 1998

DULY ENTERED FOR TAXATION SUBJECT TO FINAL ACCEPTANCE FOR TRANSFER.

(Signature)

Jeffrey L. Samels

(Printed Name) Jeffrey L. Samels

(Signature)

Jeanine M. Samels

(Printed Name) Jeanine M. Samels

(Signature)

(Signature)

(Printed Name)

(Printed Name)

STATE OF Indiana, COUNTY OF Lake SS:

Before me, the undersigned, a Notary Public in and for said County and State, this 29th day of May, 1998 personally appeared: Jeffrey L. Samels and Jeanine M. Samels, husband and wife and acknowledged the execution of the foregoing deed. In witness whereof, I have hereunto subscribed my name and affixed my official seal.

My commission expires: 8/30/98

Signature *Denise K. Zawada*

Resident of Lake County Printed Denise K. Zawada, Notary Public

This instrument prepared by Thomas K. Hoffman, Crown Point, IN Attorney at Law

Attorney Identification No. 7731-45

MAIL TO:

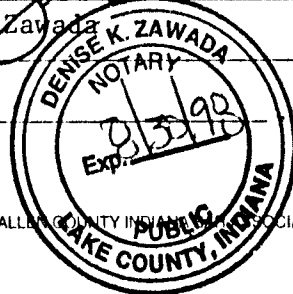

10.00
cm
Ti

000162

71 COPY 10011



STATE OF _____, COUNTY OF _____ SS:

Before me, the undersigned, a Notary Public in and for said County and State, this _____ day of _____ personally appeared:

_____ and acknowledged the execution of the foregoing deed. In witness whereof, I have hereunto subscribed my name and affixed my official seal.

My commission expires: _____ Signature _____

Resident of _____ County Printed _____, Notary Public