

2

98040591

STATE OF INDIANA  
LAKE COUNTY  
FILED FOR RECORD

98 JUN -1 PM 3: 21

MORRIS W. ...

A298-10  
R298-04

### QUITCLAIM DEED

THIS QUITCLAIM DEED, Executed this 1 day of June, 1998 (year),  
 by first party, Grantor, Evelyn Simmons  
 whose post office address is 2339 Jennings Street, Gary, In 46404  
 to second party, Grantee, Evelyn Darlene Simmons, Bowens  
 whose post office address is 2339 Jennings Street, Gary, In 46404

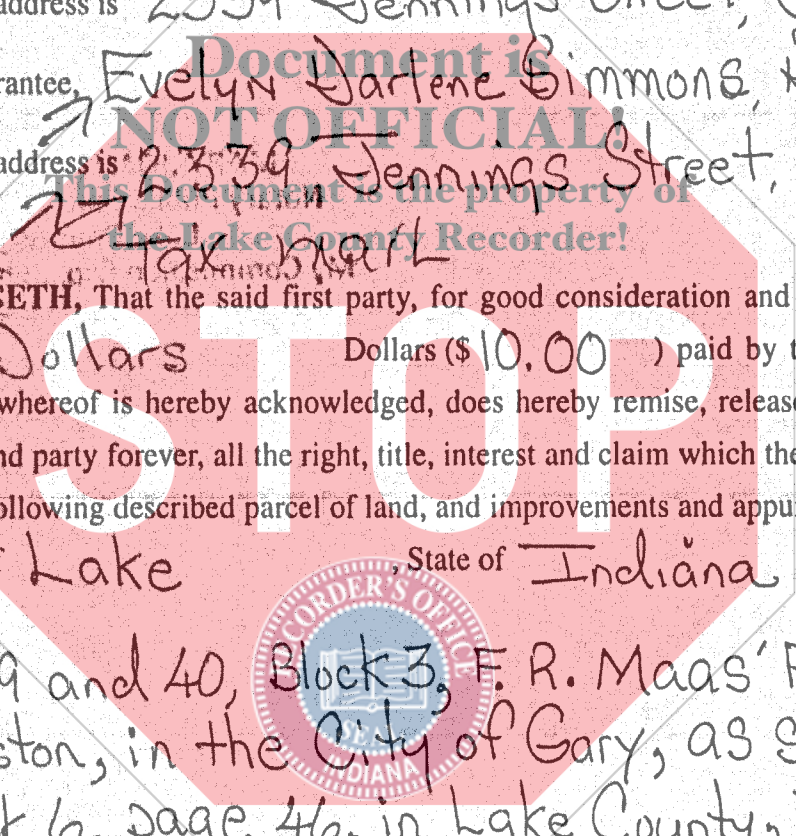

WITNESSETH, That the said first party, for good consideration and for the sum of  
 Ten Dollars Dollars (\$10.00) paid by the said second  
 party, the receipt whereof is hereby acknowledged, does hereby remise, release and quitclaim  
 unto the said second party forever, all the right, title, interest and claim which the said first party  
 has in and to the following described parcel of land, and improvements and appurtenances there-  
 to in the County of Lake, State of Indiana to wit:

lots 39 and 40, Block 3, F. R. Maas' First Addition  
 to Tolleston, in the City of Gary, as shown in  
 Plat Book 6, page 46, in Lake County, Indiana.

Key# 46-3-39

AKHF  
(1)

(Revised 3/98)

-----  
If your state requires 8 1/2" x 11" forms, cut off the bottom of this page at the dotted line.

DULY ENTERED FOR TAXATION SUBJECT TO  
FINAL ACCEPTANCE FOR TRANSFER.

JUN 01 1998

SAM ORLICH  
AUDITOR LAKE COUNTY



© E-Z Legal Forms. Before you use this form, read it, fill in all blanks, and make whatever changes are necessary to your particular transaction. Consult a lawyer if you doubt the form's fitness for your purpose and use. E-Z Legal Forms and the retailer make no representation or warranty, express or implied, with respect to the merchantability of this form for an intended use or purpose.

000140

1200 KM

IN WITNESS WHEREOF, The said first party has signed and sealed these presents the day and year first above written. Signed, sealed and delivered in presence of:

Jennifer A. Sanders  
Signature of Witness

Evelyn Darlene Bowers  
Signature of First Party

\_\_\_\_\_  
Print name of Witness

Evelyn Darlene BOWERS  
Print name of First Party

\_\_\_\_\_  
Signature of Witness

\_\_\_\_\_  
Signature of First Party

\_\_\_\_\_  
Print name of Witness

\_\_\_\_\_  
Print name of First Party

State of Dr. Lake  
County of Lake  
On 6/1/98

before me, MARY J. Piszczek

appeared EVELYN DARLENE BOWENS

personally known to me (or proved to me on the basis of satisfactory evidence) to be the person(s) whose name(s) is/are subscribed to the within instrument and acknowledged to me that he/she/they executed the same in his/her/their authorized capacity(ies), and that by his/her/their signature(s) on the instrument the person(s), or the entity upon behalf of which the person(s) acted, executed the instrument.

WITNESS my hand and official seal.

Mary J. Piszczek  
Signature of Notary

MARY JOAN PISZCZEK  
Notary Public State of Indiana  
Lake County  
My Commission Exp. July 01, 1999 Produced ID  
Type of ID IC

(Seal)

State of \_\_\_\_\_  
County of \_\_\_\_\_  
On \_\_\_\_\_  
appeared \_\_\_\_\_

before me,

personally known to me (or proved to me on the basis of satisfactory evidence) to be the person(s) whose name(s) is/are subscribed to the within instrument and acknowledged to me that he/she/they executed the same in his/her/their authorized capacity(ies), and that by his/her/their signature(s) on the instrument the person(s), or the entity upon behalf of which the person(s) acted, executed the instrument.

WITNESS my hand and official seal.

\_\_\_\_\_  
Signature of Notary

Affiant \_\_\_\_\_ Known \_\_\_\_\_ Produced ID

Type of ID \_\_\_\_\_

(Seal)

Evelyn Darlene Bowers  
Signature of Preparer

Evelyn Darlene BOWERS  
Print Name of Preparer

2339 Jennings Street Gary, Indiana  
Address of Preparer

(2)

-----  
If your state requires 8 1/2" x 11" forms, cut off the bottom of this page at the dotted line.