

RW

at Fin  
4034  
497152 pdg

0

STATE OF INDIANA )

COUNTY OF LAKE )

) ss 8040333

STATE OF INDIANA  
LAKE COUNTY  
PUBLIC RECORDS

93 JUN - 1 11:10:00

**AFFIDAVIT OF HEIRSHIP**

Comes now Zorica Kline, being first duly sworn upon her oath, and states as

follows:

1. I am the surviving owner of the following described real estate:

Lot 12, Block 6, Resubdivision of George Ruston's  
Addition to Hammond, as shown in Plat Book 31, Page 3, in Lake  
County, Indiana.

2. The above described real estate was transferred by Quit Claim Deed to Thomas

Earl Kline, also known as Thomas E. Kline, which deed was recorded under document number  
060237, on September 29, 1989.

3. Thomas Earl Kline, also known as Thomas E. Kline, continued to own this

property in his own name, a fee simple interest, until the time of his death.

4. Thomas Earl Kline, also known as Thomas E. Kline, was married to Zorica

Kline, and they never divorced prior to the time of his death.

5. Zorica Kline is the surviving spouse of Thomas Earl Kline, also known as

Thomas E. Kline, and the sole heir and beneficiary pursuant to the terms of his valid Last Will and  
Testament.

Chicago Life Insurance Company

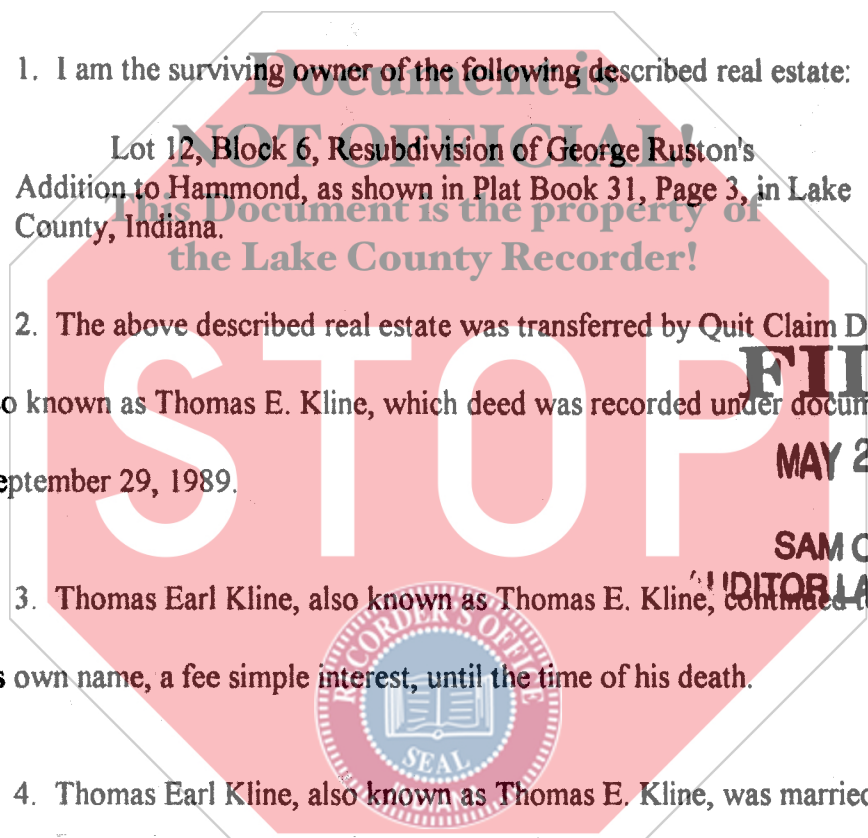

**FILED**  
MAY 29 1993  
SAM ORLICH  
CLERK LAKE COUNTY

001888

1100  
Kline  
CT

6. Thomas Earl Kline, also known as Thomas E. Kline, died on March 22, 1991, as a resident of Lake County, Indiana.

7. No probate proceedings were ever commenced for or on behalf of Thomas Earl Kline, also known as Thomas E. Kline, in Lake County, Indiana, or elsewhere.

8. No Indiana inheritance taxes, inheritance taxes from other states or countries, federal estate taxes or any other death taxes are outstanding by reason of the death of Thomas Earl Kline, also known as Thomas E. Kline.

9. No claims were made against Thomas Earl Kline, also known as Thomas E. Kline, by reason of his death; any and all debts, and charges and liens against Thomas Earl Kline, also known as Thomas E. Kline, have been paid or otherwise discharged in full.

FURTHER your Affiant sayth not.

  
*Zorica Kline*  
Zorica Kline, Affiant

Subscribed and sworn to before me, a Notary Public, this 21<sup>st</sup> day of May, 1998.

*Bronde Y. Ward*  
Notary Public  
Resident of Putnam County, IN  
Comm Exp: 9-4-99

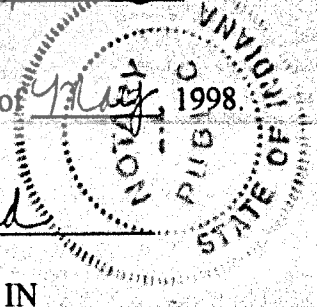

*Prepared by: Ruman, Clements, Tobin & Holub, attop  
by Lisa Misner*