

98030207

98 APR 29 AM 9:00

NOTARY PUBLIC

THIS FORM HAS BEEN PREPARED FOR USE IN THE STATE OF INDIANA BY LAWYERS ONLY. THE SELECTION OF A FORM OF INSTRUMENT, FILLING IN BLANK SPACES, STRIKING OUT PROVISIONS, AND INSERTION OF SPECIAL CLAUSES, MAY CONSTITUTE THE PRACTICE OF LAW WHICH SHOULD ONLY BE DONE BY A LAWYER.

Mail tax bills to:

217 Bach
Schererville, IN 46375

WARRANTY DEED Key No. 13-429-38

THIS INDENTURE WITNESSETH, That Cecil E. Johnson and Judith P. Johnson, husband and wife

("Grantor") of Lake County in the State of Indiana CONVEY(S) AND WARRANT(S) TO
E. Craig White and Rachelle L. White, husband and wife ("Grantee")

of Lake County in the State of Indiana
in consideration of One Dollar and other valuable consideration, the receipt and sufficiency of which are hereby acknowledged,
the following described real estate in Lake County, in the State of Indiana:

The real estate and premises commonly known as 217 Bach, Schererville,
Lake County, Indiana, more particularly described as follows, to-wit:

Lot 38 in Hilbrichaus Acres First Addition, to the Town of Schererville, as
per plat thereof, recorded in Plat Book 63 page 5, in the Office of the
Recorder of Lake County, Indiana.

Subject to real estate taxes for 1997 payable in 1998, together with
delinquency and penalty, if any, and all real estate taxes due and
payable thereafter.

Subject to recorded liens, encumbrances, easements, restrictions, ditches
and drains, highways and legal rights of way, and matters which would be
disclosed by an accurate survey or inspection of the premises.

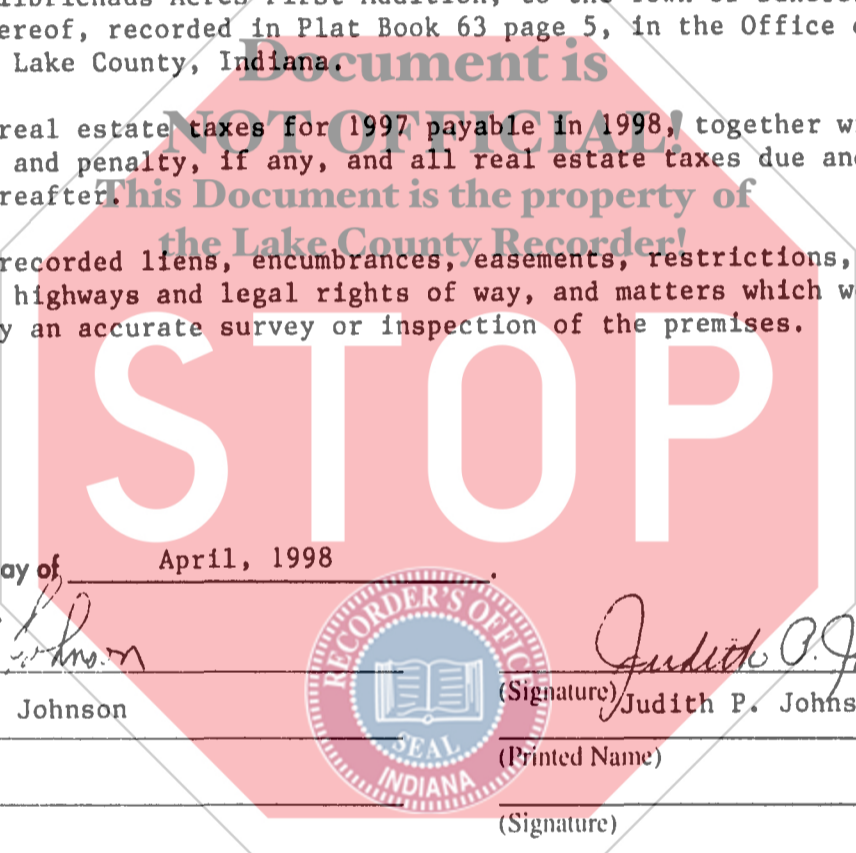

Dated this 24th day of April, 1998

Cecil E. Johnson
(Signature) Cecil E. Johnson
(Printed Name)

Judith P. Johnson
(Signature) Judith P. Johnson
(Printed Name)

(Signature) _____
(Printed Name) _____

(Signature) _____
(Printed Name) _____

STATE OF Indiana, COUNTY OF Lake SS:

Before me, the undersigned, a Notary Public in and for said County and State, this 24th day of April, 1998
personally appeared: Cecil E. Johnson and Judith P. Johnson, husband and wife

and acknowledged the execution
of the foregoing deed. In witness whereof, I have hereunto subscribed my name and affixed my official seal.

My commission expires: 10/24/2000 Signature *Gloria Miller*

Resident of Lake County Printed Gloria Miller, Notary Public

This instrument prepared by THOMAS K. HOFFMAN, CROWN POINT, IN, Attorney at Law

MAIL TO:

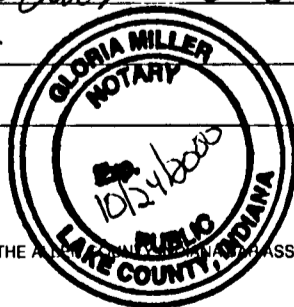

ESTIMATED FOR TAXATION SUBJECT TO
FINAL ADJUSTMENT FOR THE YEAR.

APR 26 1998

SAM ORLICH
AUDITOR LAKE COUNTY

1000 km²

001887

TICOR Sol 21773