

98030101

98 APR 29 AM 8:57

MOORE'S W.C.

A298-10
R298-04

QUITCLAIM DEED

THIS QUITCLAIM DEED, Executed this _____ day of _____, 19____

by first party, Grantor, Larine Bradley

whose post office address is 405 Harrison Street Gary, Indiana

to second party, Grantee, Kenneth Sutton

whose post office address is 2412 Maryland Street Gary Indiana 46407

WITNESSETH, That the said first party, for good consideration and for the sum of Dollars (\$ 100.00) paid by the said second party, the receipt whereof is hereby acknowledged, does hereby remise, release and quitclaim unto the said second party forever, all the right, title, interest and claim which the said first party has in and to the following described parcel of land, and improvements and appurtenances there- to in the County of Lake, State of Indiana to wit:

001-25-46-0140-0032
2465 Maryland Street
Gary, Indiana 46407

Lot 32 Bl 12 Oak Park Add

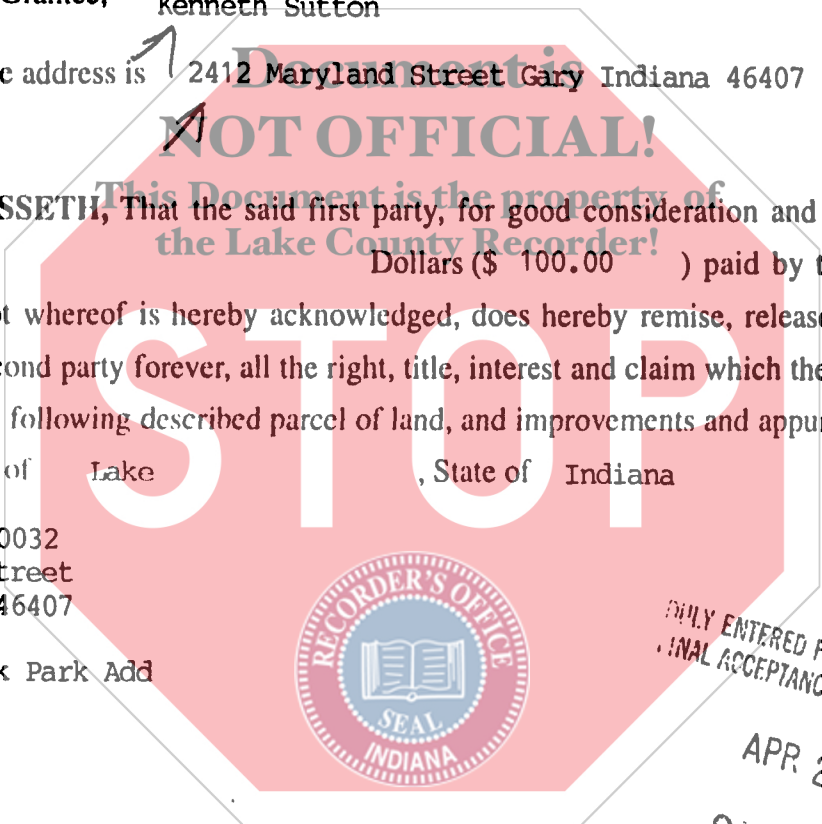

FILED ENTERED FOR TAXATION SUBJECT TO
FINAL ACCEPTANCE FOR TRANSFER.

APR 29 1993

SAM ORLICH
AUDITOR LAKE COUNTY

ZBHE
(1)

(Revised 3/97)

If your state requires 8 1/2" x 11" forms, cut off the bottom of this page at the dotted line.



1700
25

IN WITNESS WHEREOF, The said first party has signed and sealed these presents the day and year first above written. Signed, sealed and delivered in presence of:

Rose Pritchett
Signature of Witness

Laraine Bradley
Signature of First Party

ROSE PRITCHETT
Print name of Witness

LARINE BRADLEY
Print name of First Party

Signature of Witness

Signature of First Party

Print name of Witness

Print name of First Party

State of IN
County of LAKE COUNTY
On APRIL 14 - 1998 before me,
appeared Rose Pritchett & Laraine Bradley
personally known to me (or proved to me on the basis of satisfactory evidence) to be the person(s) whose name(s) is/are subscribed to the within instrument and acknowledged to me that he/she/they executed the same in his/her/their authorized capacity(ies), and that by his/her/their signature(s) on the instrument the person(s), or the entity upon behalf of which the person(s) acted, executed the instrument.
WITNESS my hand and official seal.

[Signature]
Signature of Notary

State of _____
County of _____
On _____ before me,
appeared _____
personally known to me (or proved to me on the basis of satisfactory evidence) to be the person(s) whose name(s) is/are subscribed to the within instrument and acknowledged to me that he/she/they executed the same in his/her/their authorized capacity(ies), and that by his/her/their signature(s) on the instrument the person(s), or the entity upon behalf of which the person(s) acted, executed the instrument.
WITNESS my hand and official seal.

Signature of Notary

Affiant Known Produced ID
Type of ID 20-Sept 2000 (Seal)

Affiant Known Produced ID
Type of ID _____ (Seal)

Signature of Preparer

Print Name of Preparer

Address of Preparer

(2)

If your state requires 8 1/2" x 11" forms, cut off the bottom of this page at the dotted line.