

98030100

STATE OF INDIANA
LAKE COUNTY
FILED FOR RECORD

98 APR 29 AM 8:57

PHOTOGRAPHY

A298-10
R298-04

QUITCLAIM DEED

THIS QUITCLAIM DEED, Executed this _____ day of _____, 19____,

by first party, Grantor, Larine Bradley

whose post office address is 405 Harrison Street Gary, Indiana

to second party, Grantee, Kenneth Sutton

whose post office address is 2412 Maryland Street Gary, Indiana 46407
2412 Maryland Street Gary Indiana 46407

WITNESSETH, That the said first party, for good consideration and for the sum of _____ Dollars (\$ 100.00) paid by the said second party, the receipt whereof is hereby acknowledged, does hereby remise, release and quitclaim unto the said second party forever, all the right, title, interest and claim which the said first party has in and to the following described parcel of land, and improvements and appurtenances there-
to in the County of Lake, State of Indiana to wit:

001-25-46-0140-0034
2457 Maryland Street
Gary Indiana 46407

Oak Park ADD L34 BL 12

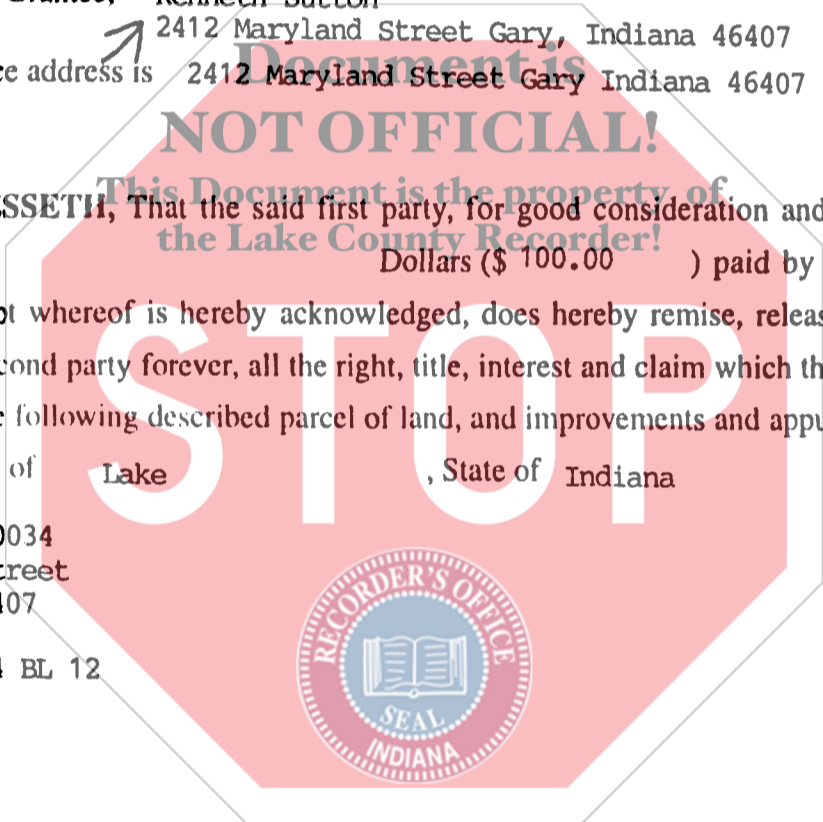

ZBHE
(1)

(Revised 3/97)

If your state requires 8 1/2" x 11" forms, cut off the bottom of this page at the dotted line.

SHALL BE ENTERED FOR TAXATION SUBJECT TO
FINAL ACCEPTANCE FOR TRANSFER.

APR 29 1993

SAM ORLICH
AUDITOR LAKE COUNTY



© E-Z Legal Forms. Before you use this form, read it, fill in all blanks, and make whatever changes are necessary to your particular transaction. Consult a lawyer if you doubt the form's fitness for your purpose and use. E-Z Legal Forms and the retailer make no representation or warranty, express or implied, with respect to the merchantability of this form for an intended use or purpose.

001960

12/25

IN WITNESS WHEREOF, The said first party has signed and sealed these presents the day and year first above written. Signed, sealed and delivered in presence of:

Rose Pritchett
Signature of Witness

Laraine Bradley
Signature of First Party

Rose PRITCHETT
Print name of Witness

LARINE BRADLEY
Print name of First Party

Signature of Witness

Signature of First Party

Print name of Witness

Print name of First Party

State of IN)
County of LAKE COUNTY

On 14 April - 1997 before me,
appeared Rose Pritchett & Laraine Bradley
personally known to me (or proved to me on the basis of satisfactory evidence) to be the person(s) whose name(s) is/are subscribed to the within instrument and acknowledged to me that he/she/they executed the same in his/her/their authorized capacity(ies), and that by his/her/their signature(s) on the instrument the person(s), or the entity upon behalf of which the person(s) acted, executed the instrument.
WITNESS my hand and official seal.

[Signature]
Signature of Notary

Document is NOT OFFICIAL!
This Document is the property of the Lake County Recorder.
Affiant of Known Produced ID
Type of ID 20 Sept 2000 (Seal)

State of _____)
County of _____
On _____ before me,
appeared _____

personally known to me (or proved to me on the basis of satisfactory evidence) to be the person(s) whose name(s) is/are subscribed to the within instrument and acknowledged to me that he/she/they executed the same in his/her/their authorized capacity(ies), and that by his/her/their signature(s) on the instrument the person(s), or the entity upon behalf of which the person(s) acted, executed the instrument.
WITNESS my hand and official seal.

Signature of Notary



Affiant _____ Known _____ Produced ID
Type of ID _____ (Seal)

Signature of Preparer

Print Name of Preparer

Address of Preparer

----- (2) -----
If your state requires 8 1/2" x 11" forms, cut off the bottom of this page at the dotted line.