

Chicago Title Insurance Company

5664 Sand Ridge  
493969 p. 6

Use of this form constitutes practice of law and is limited to practicing lawyers.  
©Copyright, 1986, 1990, 1991, by Indianapolis Bar Association.

Rev. 10/91

Parcel No. 8-15-187-12

**WARRANTY DEED**

98028955

THIS INDENTURE WITNESSETH, That BRAD LEE BELUSH and LENETTE M.

BELUSH (Grantor)

of Lake County, in the State of Indiana, CONVEY

AND WARRANT to RAFAEL A. VELEZ and COLLEEN M. O'SULLIVAN-VELEZ, HUSBAND AND WIFE (Grantee)

of Lake County, in the State of Indiana, for the sum

of ten Dollars (\$ 10.00) and other

valuable consideration, the receipt and sufficiency of which is hereby acknowledged, the following

described real estate in Lake County, State of Indiana:

Lot 12, Block 1, Independence Hill 4th Addition, as shown in Plat Book 26, Page 11 in the Office of The Recorder of Lake County.

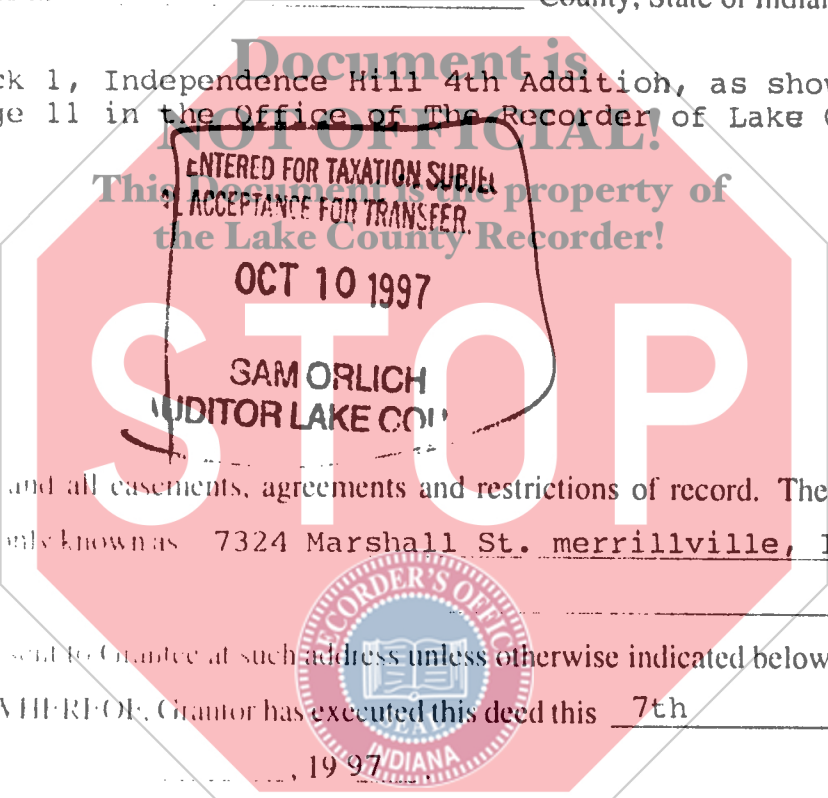

97069411

Subject to any and all easements, agreements and restrictions of record. The address of such real estate is commonly known as 7324 Marshall St. merrillville, IN

has been sent to Grantee at such address unless otherwise indicated below.

IN WITNESS WHEREOF, Grantor has executed this deed this 7th day of October, 1997

Grantor: (SEAL)  
Signature [Signature]

Grantor: (SEAL)  
Signature [Signature]

Printed Brad Lee Belush APR 25 1998

Printed Lenette M. Belush

STATE OF INDIANA } SS: ACKNOWLEDGMENT  
COUNTY OF LAKE }  
AUDITOR LAKE CO

Before me, a Notary Public in and for said County and State, personally appeared Brad Lee Belush and Lenette M. Belush

who acknowledged the execution of the foregoing Warranty Deed, and who, having been duly sworn, stated that any representations therein contained are true.

Witness my hand and Notarial Seal this 7th day of October, 1997

My commission expires: Signature [Signature]

7-17-98 Printed MICHELLE L. BANASIAK, Notary Public

Resident of LAKE County, Indiana.

This instrument prepared by Jerome L. Ezell, Attorney at Law.

Return deed to Rafael and Colleen Velez 7324 Marshall St. Merrillville, IN 46411

Send tax bills to Sand Ridge Bank 450 W. Lincoln Highway Schererville, IN 46375

001579

1200 km CT