

ASSIGNMENT OF REAL ESTATE MORTGAGE

This Deed of Assignment and Assignment of Real Estate Mortgage, made and entered into this 30 day of March, 1998 by and between CALUMET SECURITIES CORPORATION, party of the first part, and NORWEST MORTGAGE, INC., party of the second part.

WITNESSETH: That for valuable consideration, the receipt of which is hereby acknowledged, the party of the first part does hereby assign, transfer, and set over unto the said NORWEST MORTGAGE, INC., its successors and assigns, a certain Mortgage Note dated the 30 day of March, 1998 executed and delivered to CALUMET SECURITIES CORPORATION, by Marilyn M. Follrad, and assigned to NORWEST MORTGAGE, INC., together with the mortgage securing the payment of same recorded in Mortgage Book _____, page Doc. 98023409, in the office of the County Clerk of Lake County, Indiana, on the 3rd day of April 1998; and all sums of money due to become due thereon.

IN TESTIMONY WHEREOF, witness the signature of the party of the first part the day and year first above written.

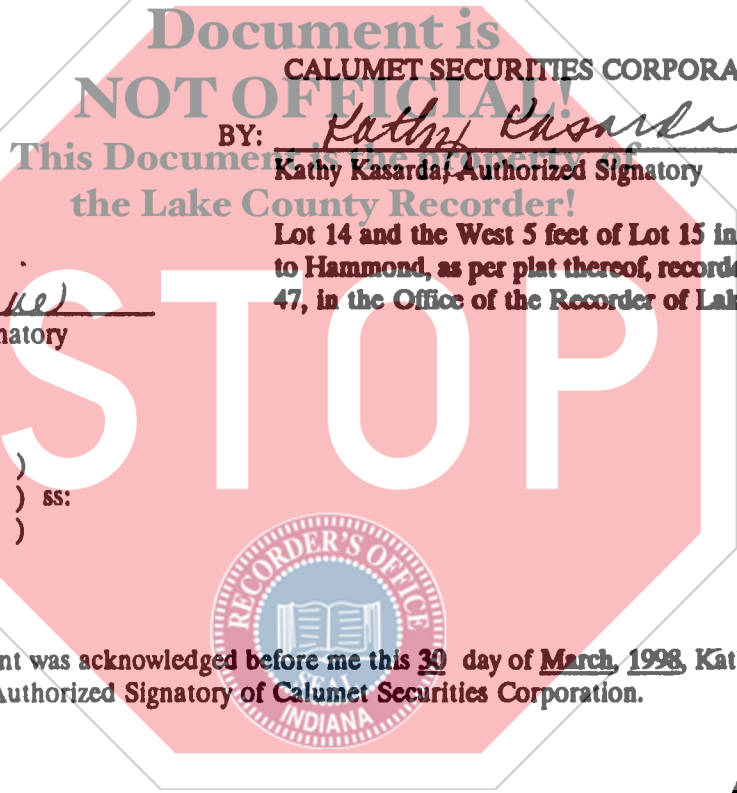

CALUMET SECURITIES CORPORATION

BY: Kathy Kasarda
Kathy Kasarda, Authorized Signatory

98023409

ATTEST:

Jenifer LeVine
Jenifer LeVine, Authorized Signatory

Lot 14 and the West 5 feet of Lot 15 in Ellyson 2nd Addition to Hammond, as per plat thereof, recorded in Plat Book 22, page 47, in the Office of the Recorder of Lake County, Indiana.

State of Indiana)
County of LAKE) SS:

The foregoing instrument was acknowledged before me this 30 day of March, 1998, Kathy Kasarda, Authorized Signatory and Jenifer LeVine, Authorized Signatory of Calumet Securities Corporation.

My Commission Expires: 6-9-00
Resident of LAKE County

Bette J. Farmer
Bette J. Farmer



STATE OF INDIANA
LAKE COUNTY
FILED FOR RECORD

98 APR 3 11:53 AM

This Instrument Prepared By: DAVID M. OBERLE, EXECUTIVE VICE PRESIDENT OF CALUMET SECURITIES CORPORATION, P. O. Box 208, SCHERERVILLE, INDIANA 46375

Return: Calumet Sec.
Allen Joseph L.

1100
K.M.
T.

216591
TICOR TITLE INSURANCE
Crown Point, Indiana