

Mail Tax Bills To:
2732 Autumn Drive
Crown Point, Indiana 46307

Tax Key No. 13-633-12

CORPORATE WARRANTY DEED

THIS INDENTURE WITNESSETH THAT: C/R HOMES, INC.

a Corporation duly organized and existing under the laws of the State of Indiana located in Lake County, in the State of Indiana

CONVEY AND WARRANT TO: TRACY A. BEVIL & NATALIE L. DYBEL

of Lake County in the State of Indiana

for and in consideration of Ten Dollars and other good and valuable consideration the receipt of whereof is hereby acknowledged, the following Real Estate in Lake County in the State of Indiana, to wit:

Lot 12 in Harvest Manor Unit 1, Section 7, an Addition to the Town of Schererville, as per plat thereof, recorded in Plat Book 80, page 39, in the Office of the Recorder of Lake County, Indiana.

Commonly known as : 2732 Autumn Drive, Crown Point, Indiana

- Subject To:
1. Taxes 1997 payable 1998 and subsequent years.
 2. Covenants, conditions and restrictions contained in the recorded plat of said subdivision, but omitting any covenant or restriction based on race, color, religion, sex, handicap, familial status or national origin.
 3. Highways, easements, right-of-ways, and restrictions of record, if any.
 4. Encroachments, overlaps, boundary line disputes, or other matters which would be disclosed by an accurate survey or inspection of the premises.

Grantor being duly sworn states that this a subchapter "S" corporation and there is no Indiana Gross Income Tax due or owing on the conveyance.

Dated this 8TH day of April, 1998.

IN WITNESS WHEREOF, the said C/R Homes, Inc. has caused this Deed to be executed by Charles Hasselbring, its President, and attested by Charles Hasselbring, its Secretary, and its corporate seal to be hereunto affixed.

DAILY ENTERED FOR TAX PURPOSES
FINAL ACCEPTANCE FOR RECORD
APR 10 1998
AUDITOR SAM OPLICH
LAKE COUNTY

000668

1300
KLN
T

Tiger Schererville

2

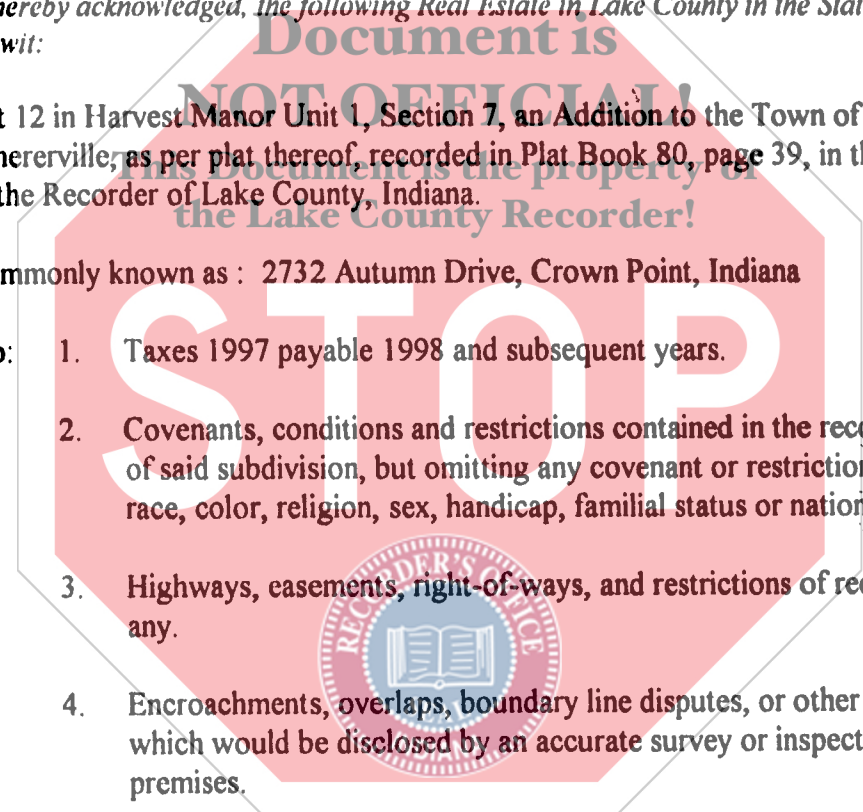

98025787

98 APR 11 1998

STATE OF INDIANA
LAKE COUNTY
FILED FOR RECORD

C/R HOMES, INC.

BY: Charles I. Hasselbring
CHARLES I. HASSELBRING President

ATTEST:

Charles I. Hasselbring
CHARLES I. HASSELBRING Secretary

STATE OF INDIANA)
) . SS:
COUNTY OF LAKE)

Before me, the undersigned, a Notary Public in and for said County and State, personally appeared the within named Charles Hasselbring, President and Charles Hasselbring, Secretary to me known to be such President and Secretary of said Corporation and acknowledged the execution of the foregoing Deed for and on behalf of said Corporation and by its authority.

WITNESS my hand and Notarial seal this 8th day of April, 1998.

Gloria Miller
GLORIA MILLER

My Commission Expires: 10-24-00

County of Residence : LAKE

THIS INSTRUMENT PREPARED BY: CHARLES I. HASSELBRING

