

Vukobratovich H/W

217446

STATE OF INDIANA  
LAKE COUNTY  
FILED FOR RECORD

98025187

98 APR - 9 AM 9:00

**WARRANTY DEED**

MAIL TAX BILLS TO: 4237 JOHNSON AVE  
HAMMOND, INDIANA 46327

TAX KEY NUMBER: 32-41-17

**THIS INDENTURE WITNESSETH, That PAUL BURRELL SUCESSOR TRUSTEE OF THE LUCILLE WILCZYNSKI GRANTOR TRUST AGREEMENT DATED APRIL 29, 1991 ("Grantor(s)) of LAKE County in the State of INDIANA**

**CONVEYS AND WARRANTS TO STEVEN M. VUKOBRATOVICH AND LINDA M. VUKOBRATOVICH HUSBAND AND WIFE of LAKE County in the state of INDIANA in consideration of \$1.00 (One) Dollar and other valuable consideration, the receipt and sufficiency of which are hereby acknowledged, the following described real estate in LAKE County, in the State of Indiana:**

LOT 15 IN BLOCK 1 IN FRANK S. BETZ 3RD ADDITION TO THE CITY OF HAMMOND, AS PER PLAT THEREOF RECORDED IN PLAT BOOK 12 PAGE 1, IN THE OFFICE OF THE RECORDER OF LAKE COUNTY, INDIANA

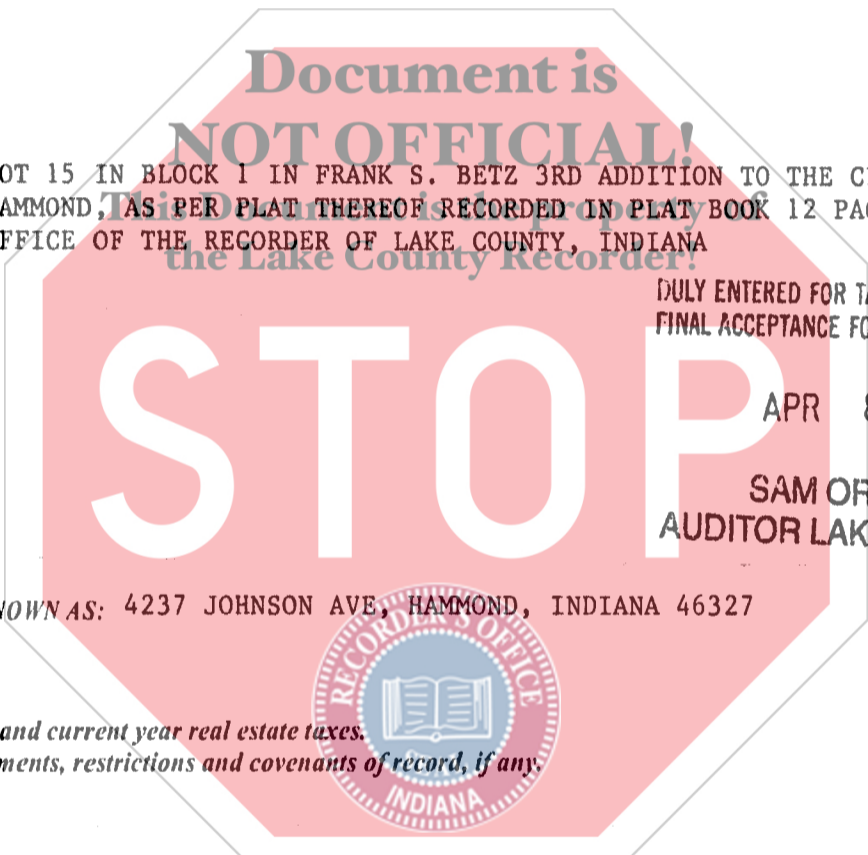

DULY ENTERED FOR TAXATION SUBJECT TO FINAL ACCEPTANCE FOR TRANSFER.

APR 8 1998

SAM ORLICH  
AUDITOR LAKE COUNTY

COMMONLY KNOWN AS: 4237 JOHNSON AVE, HAMMOND, INDIANA 46327

Subject to past and current year real estate taxes.  
Subject to easements, restrictions and covenants of record, if any.



**State of INDIANA ss: LAKE**  
Before me, the undersigned, a Notary Public in and for said County and State, this 3RD day of APRIL 1998 personally appeared:  
PAUL BURRELL SUCESSOR TRUSTEE OF THE LUCILLE WILCZYNSKI GRANTOR TRUST DATED APRIL 29, 1991

Dated this 3RD day of APRIL 1998  
*Paul Burrell, Successor Trustee*  
PAUL BURRELL, SUCESSOR TRUSTEE

And acknowledged the execution of the foregoing deed. In witness whereof, I have hereunto subscribed my name and affixed my official seal.

THOMAS G. SCHILLER  
Notary Public  
Resident of  
My Commission Expires: 6-7-00

This Instrument prepared by: Robert B. Ledpoll, Attorney At Law, 8242 Galumet Avenue; Munster, IN 46321 219/922-9661  
Lake County, IN Attorney Identification Number: 8767-45

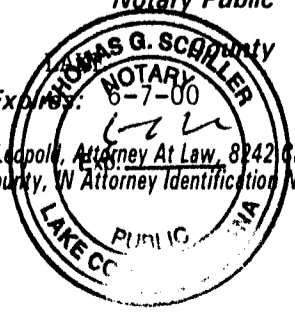

10/2/98

000470