

2

STATE OF INDIANA
LAKE COUNTY
FILED FOR RECORD

98022988

98 APR -2 AM 9:15

MORRIS W. ORLICH

A298-10
R298-04

QUITCLAIM DEED

THIS QUITCLAIM DEED, Executed this 2nd day of December, 1997

by first party, Grantor, Elbert Boyd and Estella Boyd, his wife

whose post office address is 16230 Griggs Detroit, MI 48221

to second party, Grantee, Desmond K. Rush, a single male

whose post office address is 16230 Griggs Detroit, MI 48221

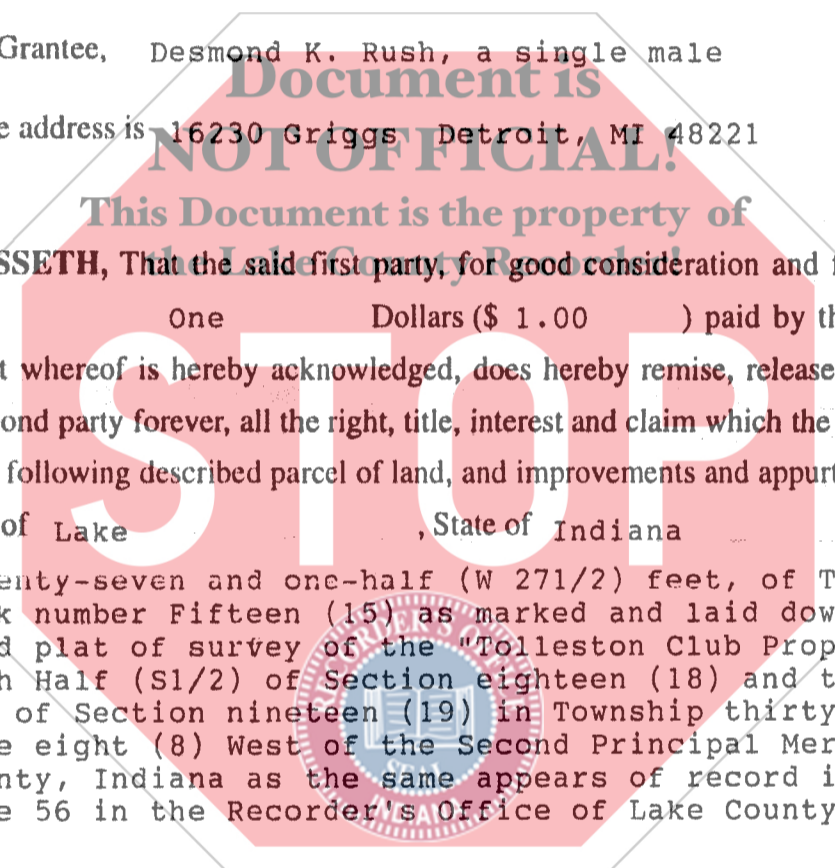

WITNESSETH, That the said first party, for good consideration and for the sum of One Dollars (\$ 1.00) paid by the said second party, the receipt whereof is hereby acknowledged, does hereby remise, release and quitclaim unto the said second party forever, all the right, title, interest and claim which the said first party has in and to the following described parcel of land, and improvements and appurtenances there- to in the County of Lake, State of Indiana to wit:

The West Twenty-seven and one-half (W 27 1/2) feet, of Tract No. 10, in Block number Fifteen (15) as marked and laid down on the recorded plat of survey of the "Tolleston Club Property" in the South Half (S1/2) of Section eighteen (18) and the North Half (N1/2) of Section nineteen (19) in Township thirty-six (36) North, Range eight (8) West of the Second Principal Meridian, in Lake County, Indiana as the same appears of record in Plat Book 26 Page 56 in the Recorder's Office of Lake County, Indiana.

FILED

MAR 31 1998

SAM ORLICH
AUDITOR LAKE COUNTY

1200 km

ATHE
(1)

(Revised 3/97)

If your state requires 8 1/2" x 11" forms, cut off the bottom of this page at the dotted line.

EX# M.O.
86408330283

001525



© E-Z Legal Forms. Before you use this form, read it, fill in all blanks, and make whatever changes are necessary to your particular transaction. Consult a lawyer if you doubt the form's fitness for your purpose and use. E-Z Legal Forms and the retailer make no representation or warranty, express or implied, with respect to the merchantability of this form for an intended use or purpose.

1200

IN WITNESS WHEREOF, The said first party has signed and sealed these presents the day and year first above written. Signed, sealed and delivered in presence of:

Dorothy [Signature]
Signature of Witness

Estella Boyd
Signature of First Party

Dorothy Rush
Print name of Witness

Estella Boyd
Print name of First Party

Brenda Hollis
Signature of Witness

Signature of First Party

Brenda Hollis
Print name of Witness

Print name of First Party

State of Michigan
County of Wayne
On 1/13/98 before me,
appeared Desmond Rush

ROSE D. WEATHERSPOON
NOTARY PUBLIC - WAYNE COUNTY, MI
MY COMMISSION EXPIRES 03/25/00

personally known to me (or proved to me on the basis of satisfactory evidence) to be the person(s) whose name(s) is/are subscribed to the within instrument and acknowledged to me that he/she/they executed the same in his/her/their authorized capacity(ies), and that by his/her/their signature(s) on the instrument the person(s), or the entity upon behalf of which the person(s) acted, executed the instrument.
WITNESS my hand and official seal.

Rose D. Weatherspoon
Signature of Notary

Affiant _____ Known Produced ID _____
Type of ID _____
(Seal)

State of Michigan
County of Wayne
On 1/13/98 before me,
appeared Desmond Rush

personally known to me (or proved to me on the basis of satisfactory evidence) to be the person(s) whose name(s) is/are subscribed to the within instrument and acknowledged to me that he/she/they executed the same in his/her/their authorized capacity(ies), and that by his/her/their signature(s) on the instrument the person(s), or the entity upon behalf of which the person(s) acted, executed the instrument.
WITNESS my hand and official seal.

Rose D. Weatherspoon
Signature of Notary

Affiant _____ Known Produced ID _____
Type of ID _____
(Seal)

ROSE D. WEATHERSPOON
NOTARY PUBLIC - WAYNE COUNTY, MI
MY COMMISSION EXPIRES 03/25/00



Stephanie Berry
Signature of Preparer

Stephanie Berry
Print Name of Preparer

21250 Laher Rd #202 Southfield, MI 48034
Address of Preparer

(2)

If your state requires 8 1/2" x 11" forms, cut off the bottom of this page at the dotted line.