

97086316

STATE OF INDIANA
LAKE COUNTY
FILED FOR RECORD
EASEMENT
97 DEC 15 PM 1:13

In consideration of the sum of Ten Dollars (\$10.00), receipt of which is hereby mutually acknowledged, and for other good and valuable consideration, the sufficiency of which is hereby mutually acknowledged, DAVID E. and NANCY K. KADISH, husband and wife, hereinafter referred to as "GRANTOR", does hereby grant, warrant and convey unto the CITY OF HOBART, Lake County, Indiana, hereinafter referred to as "GRANTEE", the perpetual easement right and authority to use for public utility purposes, including but not limited to, the extension of a storm-water sewer line and if necessary from time to time, to install, construct, operate, maintain, repair, replace and renew pipelines, cables and/or other appurtenances in the strip of land hereinafter described, together with all rights and privileges necessary or convenient for the full enjoyment or use thereof for the purposes herein described, including the right of ingress and egress to and from the strip of land over the adjoining lands of GRANTOR herein, including the right to remove from said strip hereinafter described, any trees or growth or plants which may, in the sole judgement of the GRANTEE, endanger the safety of or interfere with the use or enjoyment of the rights granted herein in, upon, along, over and through the easement strip of land or right-of-way situated in the City of Hobart, County of Lake, State of Indiana, described as follows:

The South 15 feet of a parcel described as Lot 8, except the South 20 feet thereof, in Block 15, in Hobart Park Addition to Hobart, as per plat thereof, recorded in Plat Book 12, page 30, in the Office of the Recorder of Lake County, Indiana.

Any damages to the grass, trees, bushes, fences or buildings on or adjacent to the strip of land described done by the GRANTEE, or its agents, in the use of said easement for the purposes set forth above shall be promptly repaired, reconstructed or restored to its existing condition at the

14.00
jzw

Zarko Sekerez & Associates, Inc.

Land Surveyors & Civil Engineers

13 North Court Street
 Post Office Box 903
 Crown Point, Indiana 46307
 219-769-5012
 fax 663-7282

Order No. 102415

SURVEYOR LOCATION REPORT

KADISH, David E. and Nancy K.
 223 S. Pennsylvania Street
 Hobart, Indiana

Lot 8, except the South 20 feet thereof, in Block 15, in Hobart Park Addition to Hobart, as per plat thereof, recorded in Plat Book 12 page 30, in the Office of the Recorder of Lake County, Indiana.

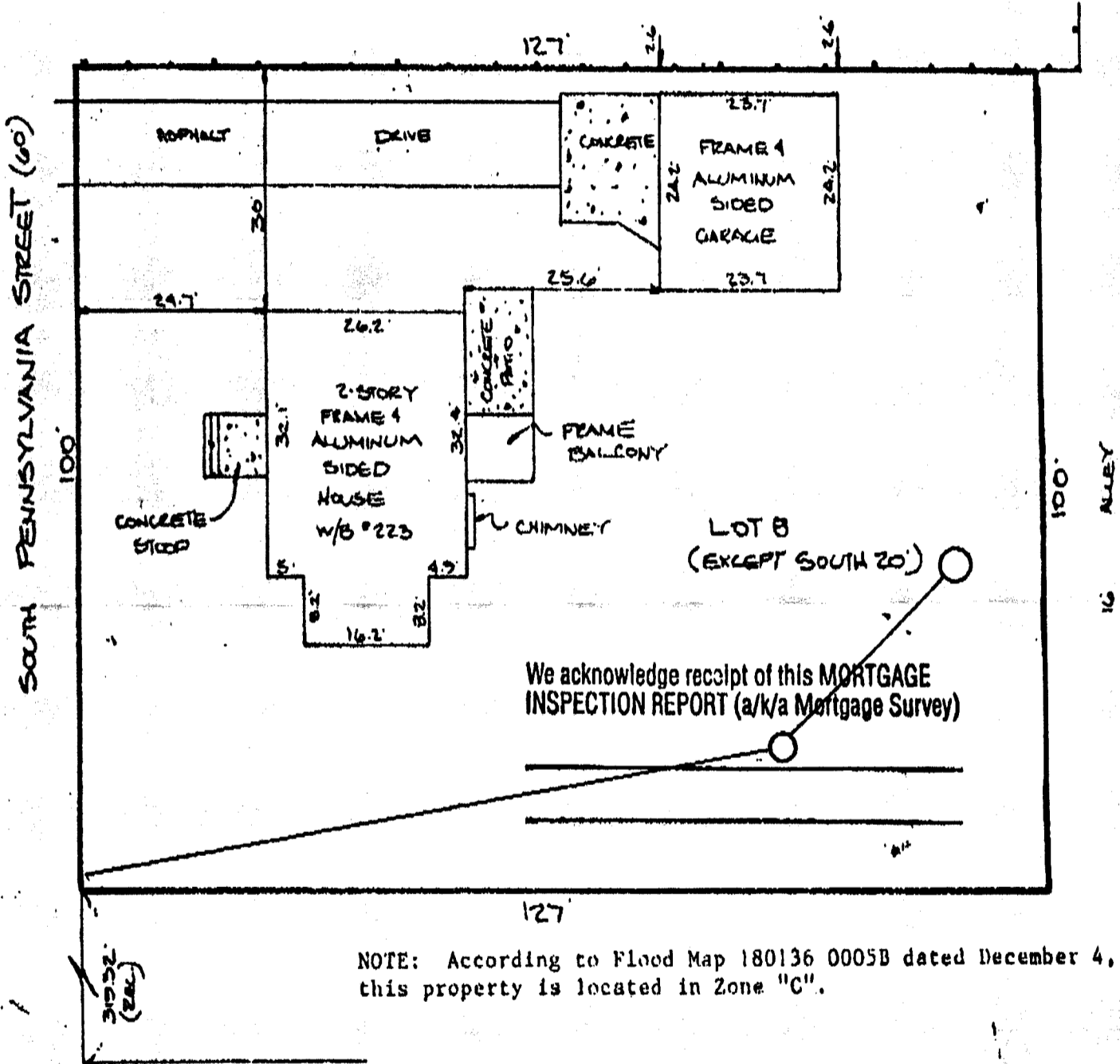

We acknowledge receipt of this MORTGAGE INSPECTION REPORT (a/k/a Mortgage Survey)

NOTE: According to Flood Map 180136 0005B dated December 4, 1979 this property is located in Zone "C".

THIRD STREET

Fence locations shown are approximate.
 For an exact determination a stake survey must be performed.

TO: CALUMET NATIONAL BANK

I hereby certify to the party named above that the real estate described herein was inspected under my supervision on the date indicated and that, to the best of my knowledge and belief, this report conforms with the requirements contained in sections 42 through 44 of 864 IAC 1.1-13 for a surveyor location report. The accuracy of any flood hazard statement shown on this report is subject to map scale uncertainty and to any other uncertainty in location or elevation on the referenced flood insurance rate map. This report is designed for use by a title insurance company with residential loan policies. No corner markers were set and the location data herein is based on limited accuracy measurements. Therefore, no liability will be assumed for any use of this data for construction of new improvements or fences.

The legal description noted on this plat was provided by the client and must be compared with deed and/or title policy. For building restrictions and/or easements refer to your deed, contract, title policy, and/or zoning regulations. This plat is valid only if it contains the original signature and embossed seal of the surveyor. Boundary dimensions are based on the public records and/or description provided. This plat is valid for six (6) months from date shown and should not be relied on thereafter. No dimensions should be assumed by scale measurements upon the plat.

SCALE 1 in. = 20 Ft.

DATE SEPTEMBER 5 1995

BOOK 102415 PAGE 1

ORDERED BY: CALUMET NATIONAL BANK

Radu M. S. Anghin

Indiana Professional Land Surveyor 29500023