

When Recorded Return To:
Nationwide Recording Service
17911 Von Karman Ave. Ste#230
Irvine, CA 92614

97020812

97 APR -7 PM 12:21

MONITOR CENTER
RECORDER

Loan No. 1853043- 

ASSIGNMENT OF MORTGAGE

KNOW ALL MEN BY THESE PRESENTS That LONG BEACH MORTGAGE COMPANY

organized and existing under the laws of the United States of America, party of the first part, for value received, has granted, bargained, sold, assigned, transferred and set over, and by these presents does grant, sell, assign, transfer and set over unto Bankers Trust Company of California, N.A., as Trustee of AMRESCO Residential Securities Corporation Mortgage Loan Trust 1996-1 under the Pooling and Servicing Agreement dated as of January 1, 1996

organized and existing under the laws of _____, party of the second part, its successors and assigns, a certain indenture of mortgage dated the 27th day of October A.D. 1995, made by JOHN SPRUIELL, A MARRIED MAN

to it, securing the payment of one promissory note therein described for the sum of Nineteen Thousand Five Hundred and no/100----- Dollars (\$ 19,500.00), and all its rights, title and interest in and to the premises situated in the county of LAKE, State of Indiana, and described in said mortgage as follows, to-wit: THE EAST 40 FEET OF LOTS 1 AND 2 IN BLOCK 27 IN GARY LAND COMPANY'S FIRST SUBDIVISION, IN THE CITY OF GARY, AS PER PLAT THEREOF, RECORDED IN PLAT BOOK 6, PAGE 15, IN THE OFFICE OF THE RECORDER OF LAKE COUNTY, INDIANA, IN LAKE COUNTY, IN INDIANA.

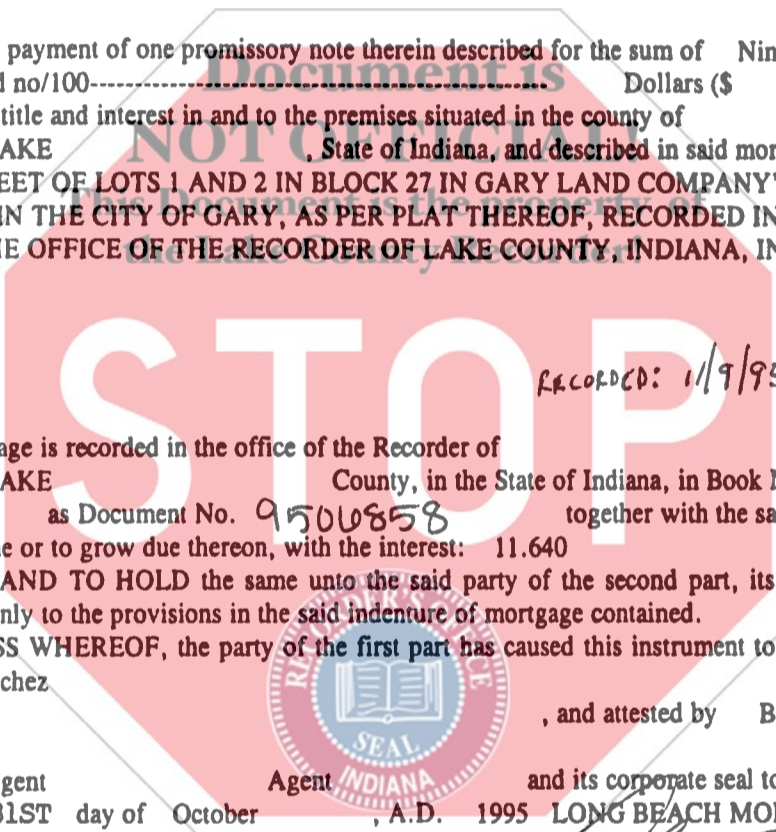

RECORDED: 11/9/95

which said mortgage is recorded in the office of the Recorder of LAKE County, in the State of Indiana, in Book No. _____ at Page _____ as Document No. 9506858 together with the said note therein described and the money due or to grow due thereon, with the interest: 11.640

TO HAVE AND TO HOLD the same unto the said party of the second part, its successors and assigns, forever; subject only to the provisions in the said indenture of mortgage contained.

IN WITNESS WHEREOF, the party of the first part has caused this instrument to be executed in its name by Agnes Sanchez, its Agent, and attested by Betty Johnson, its Agent, and its corporate seal to be hereunto affixed this 31ST day of October, A.D. 1995 LONG BEACH MORTGAGE COMPANY

ATTEST:

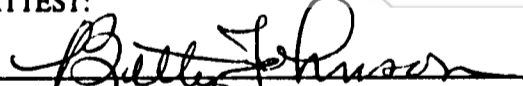
Betty Johnson, AGENT
State of California
County of ORANGE
On October 31, 1995

By: 
Agnes Sanchez - AGENT
before me Ronald L. Dove, personally appeared

Betty Johnson and Agnes Sanchez, personally known to me (or proved to me on the basis of satisfactory evidence) to be the person(s) whose name(s) is/are subscribed to the within instrument and acknowledged to me that he/she/they executed the same in his/her/their authorized capacity(ies), and that by his/her/their signature(s) on the instrument the person(s), or the entity upon behalf of which the person(s) acted, executed the Assignment.

Ronald L. Dove

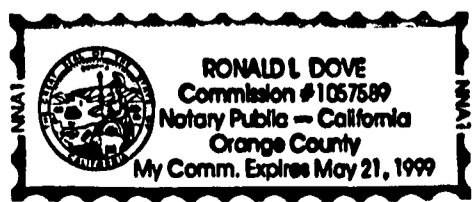

1000
27507688