

# Real Estate Mortgage

3

This Indenture Witnesseth, That Robert L. Tuley and Mary E. Tuley, Husband and Wife  
246 Inverness Lane, Schererville, IN 46375

of Lake County, in the State of Indiana

Mortgage and Warrant to Karen Schwei  
112 Brookfield Place, Combined Locks, WI 54113

of County, in the State of , the following described

Real Estate in Lake County, in the State of Indiana, as follows, to-wit:

The unit designated as Unit 2 in Springwood Condominiums Horizontal Property Regime, recorded as Document no.'s 652819 and 652821 under date of December 7, 1981, in the Office of the Recorder of Lake County Indiana and as further amended and recorded as Documents no.'s 870593 and 870594 under date of August 20, 1986, in the Office of the Recorder of Lake County, Indiana, together with the undivided interest in the common areas appertaining thereto. Commonly know as: 246 Inverness Lane, Schererville, IN Tax Key No.: 13-341-2

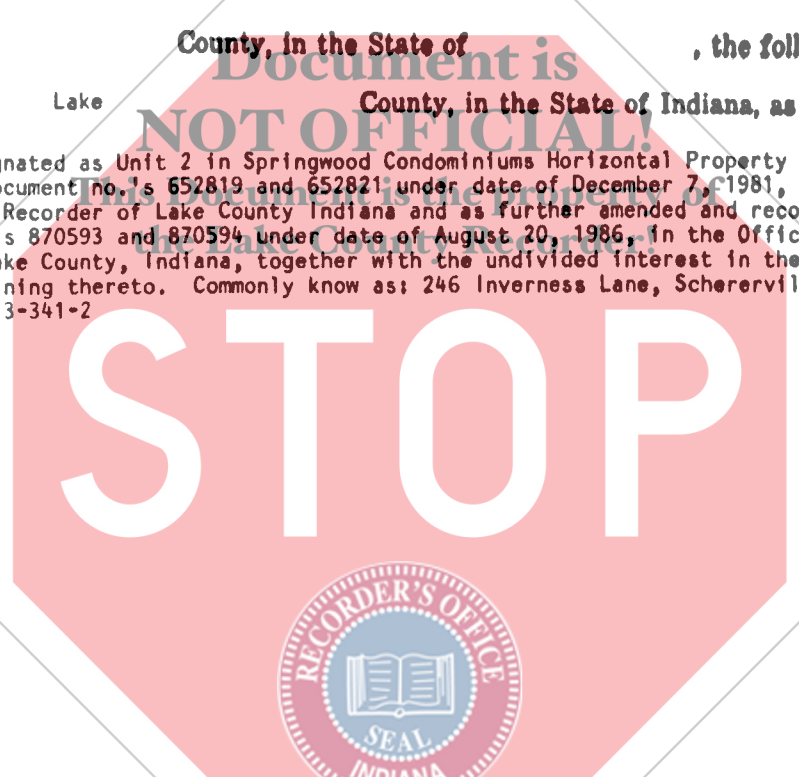

MORTGAGE  
RECORDER  
MORTGAGE  
RECORDER

97 FEB 11 AM 10:56

97008413

and the mortgagor expressly agree to pay the sum of money above secured, without relief from valuation or appraisal laws, and upon failure to pay any one of said notes, or any part thereof, at maturity, or the interest thereon, or any part thereof, when due, or the taxes or insurance as hereinafter stipulated, then all of said notes are to be due and collectible, and this mortgage may be foreclosed accordingly. And it is further expressly agreed, that until all of said notes are paid, said mortgagor will keep all legal taxes and charges against said premises paid as they become due, and will keep the buildings thereon insured for the benefit of the mortgagee, as how interest may appear and the policy duly assigned to the mortgagee, to the amount of \$1,000 Dollars, and failing to do so, said mortgagee, may pay said taxes or insurance, and the amount so paid, with per cent interest thereon, shall be a part of the debt secured by this mortgage.

In Witness Whereof, the said mortgagor ha hereunto set hands and  
seal this 11<sup>th</sup> day of February 19 97  
Robert L. Tuley (Seal) \_\_\_\_\_ (Seal)  
Mary E. Tuley (Seal) \_\_\_\_\_ (Seal)  
\_\_\_\_\_ (Seal) \_\_\_\_\_ (Seal)

This instrument prepared by: Laurie A. Ferris, 2 Hawthorne, Prospect Heights, IL 60070

MLU

STATE OF INDIANA, Lake COUNTY, ss:

Before me, the undersigned, a Notary Public in and for said County, this 16th day of January, 1997, came Robert L. Tuley Mary E. Tuley

and acknowledged the execution of the foregoing instrument. Witness my hand and official seal.

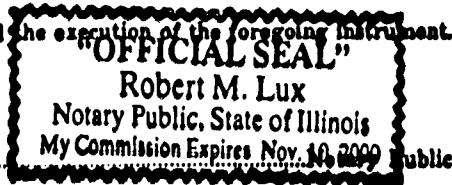

Robert M. Lux

My Commission expires Resident of Cook County

Document is NOT OFFICIAL!

ASSIGNMENT OF MORTGAGE

FOR VALUE RECEIVED, the annexed Mortgage to which is recorded in the office of the Recorder of County, Indiana, in Mortgage Record page, and the notes described therein which it secures are hereby assigned and transferred to without recourse upon the mortgage.

Witness the hand and seal of said mortgagee, this day of 19 (SEAL)

STATE OF INDIANA, County, ss: :

Before me, the undersigned, a Notary Public in and for said county, this day of 19, came and acknowledged the execution of the annexed assignment of mortgage.

IN WITNESS WHEREOF, I have hereunto subscribed my name and affixed my official seal.

My Commission expires Notary Public

RELEASE OF MORTGAGE

THIS CERTIFIES that the annexed Mortgage to which is recorded in the office of the Recorder of County, Indiana, in Mortgage Record page, has been fully paid and satisfied and the same is hereby released.

Witness the hand and seal of said mortgagee, this day of 19 (SEAL)

STATE OF INDIANA, County, ss: :

Before me, the undersigned, a Notary Public in and for said county, this day of 19, came and acknowledged the execution of the annexed release of mortgage.

IN WITNESS WHEREOF, I have hereunto subscribed my name and affixed my official seal.

My Commission expires Notary Public

# PROMISSORY NOTE



Document is  
**NOT OFFICIAL!**

This Document is the property of  
the Lake County Recorder!

\$ 1,000.00 \_\_\_\_\_ January 1 \_\_\_\_\_ 19 97

Robert L. and Mary E. Tuley *after date* on demand *promise to pay to*

*the order of* Karen Schwei \_\_\_\_\_

One Thousand (\$1,000.00) Dollars \_\_\_\_\_ 100 *Dollars*

at Such place as payee may designate \_\_\_\_\_

*Value received with interest at the rate of* -0- *per cent per annum.*

*No.* \_\_\_\_\_ *Due* on demand



Robert L Tuley  
Mary E. Tuley

Robert L. Tuley and Mary E. Tuley

