

MONEY STORE Box 160128  
VA#: 26400022908 NAME: J. DOTSON Sacramento  
NMC#1354631 PROP: 5019 WASHINGTON ST CA  
GARY, IN 46408 45814

2  
THIS INDENTURE WITNESSETH THAT Bank of America, National Trust and Savings Association, a National Banking Association, not in its individual capacity but solely as trustee or its successors and assigns on behalf of Vendee Mortgage Trust Series 1992-1, 555 Anton Blvd., Costa Mesa, CA 92626, CONVEYS AND WARRANTS to JAMES DOTSON

\_\_\_\_\_ for and in consideration of the sum of Ten and 00/100-  
-----Dollars (\$10.00) and other valuable consideration the receipt whereof is hereby acknowledged, the following described property situated in the County of LAKE, Indiana, to wit:

Lot 4, Block 24, Junedale Subdivision, City of Gary, as shown in Plat Book 19, page 3, Lake County, Indiana.

DULY ENTERED FOR TAXATION SUBJECT TO FINAL ACCEPTANCE FOR TRANSFER.

FEB 10 1997

SAM ORLICH  
AUDITOR LAKE COUNTY

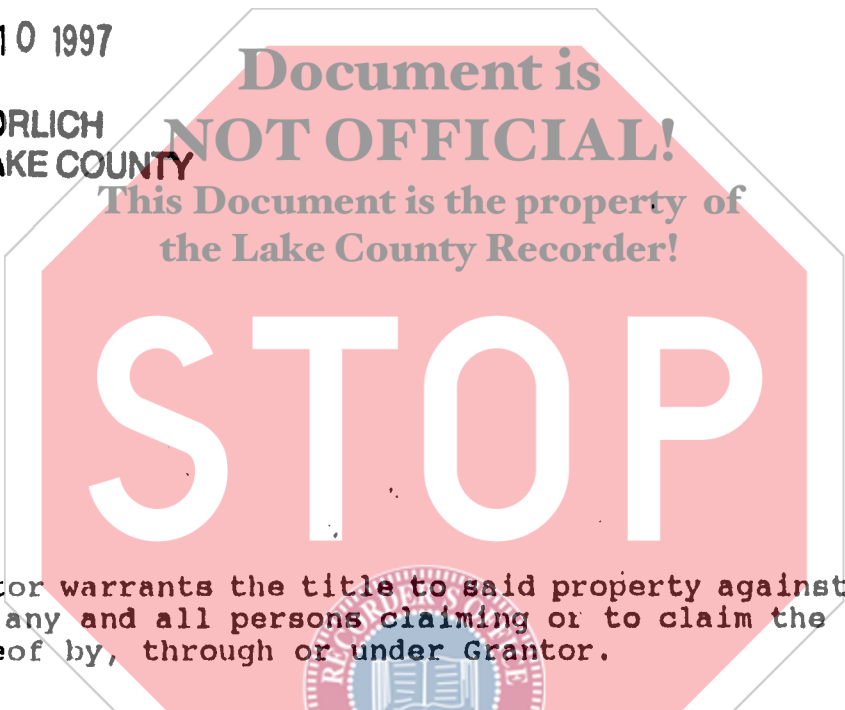

97008061

97 FEB 10 PM 12:01

STATE OF INDIANA  
LAKE COUNTY  
FILED FOR RECORD

45-1-5  
MOPRIS W. CARTER  
RECORDER

Grantor warrants the title to said property against the lawful claims of any and all persons claiming or to claim the same or any part thereof by, through or under Grantor.

IN WITNESS WHEREOF, Grantor on this the 10 day of JAN, 1997, has caused this instrument to be signed and sealed on the Grantor's behalf by the undersigned, being thereunto duly appointed and qualified, and who is authorized to execute this instrument.

BANK OF AMERICA NATIONAL TRUST AND SAVINGS ASSOCIATION, A NATIONAL BANKING ASSOCIATION, NOT IN ITS INDIVIDUAL CAPACITY BUT SOLELY AS TRUSTEE FOR

Signed, Sealed and Delivered In the presence of:

VENDEE MORTGAGE TRUST  
SERIES 1992-1

[Signature] BRUCE FARACON

[Signature] KATHY VEITH  
Vice President

[Signature] MADGE ALSTON

By: [Signature] JUDY PEI  
Assistant Secretary

000410  
1200  
m

10185  
FPE

OK# 2300 10186

**CALIFORNIA ALL-PURPOSE ACKNOWLEDGMENT**

State of California

County of Los Angeles

On January 10, 1997 before me, The Undersigned

personally appeared Kathy Veitch and Judy Pei

personally known to me - OR -  proved to me on the basis of satisfactory evidence to be the person(s) whose name(s) is/are subscribed to the within instrument and acknowledged to me that he/she/they executed the same in his/her/their authorized capacity(ies), and that by his/her/their signature(s) on the instrument the person(s), or the entity upon behalf of which the person(s) acted, executed the instrument.

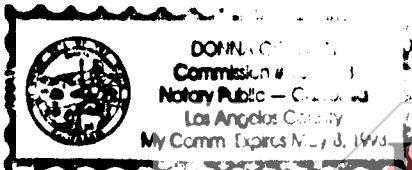

WITNESS my hand and official seal.

Donna Gordon  
Signature of Notary Public

Document is NOT OFFICIAL!  
This Document is the property of the Lake Recorder!

Though the information below is not required by law, it may prove valuable to persons relying on the document and could prevent fraudulent removal and reattachment of this form to another document.

**Description of Attached Document**

Title or Type of Document: \_\_\_\_\_

Document Date: \_\_\_\_\_ Number of Pages: \_\_\_\_\_

Signer(s) Other Than Named Above: \_\_\_\_\_

**Capacity(ies) Claimed by Signer(s)**

Signer's Name: \_\_\_\_\_ Signer's Name: \_\_\_\_\_

- Individual
- Corporate Officer
- Title(s): \_\_\_\_\_
- Partner  Limited  General
- Attorney-in-Fact
- Trustee
- Guardian or Conservator
- Other: \_\_\_\_\_

- Individual
- Corporate Officer
- Title(s): \_\_\_\_\_
- Partner  Limited  General
- Attorney-in-Fact
- Trustee
- Guardian or Conservator
- Other: \_\_\_\_\_

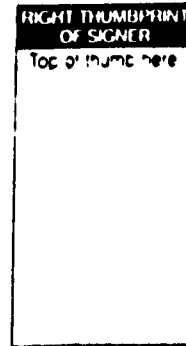
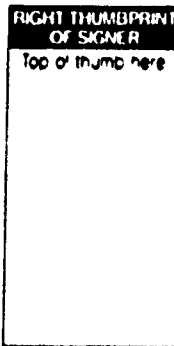

Signer Is Representing: \_\_\_\_\_

Signer Is Representing: \_\_\_\_\_