

HOLD FOR LYND MCKRAY EX 3760  
THAMM

# Real Estate Mortgage

This Indenture Witnesseth, That **DZUROVACK ROBERT A & BEVERLY J HUSBAND & WIFE**

of **LAKE** County, in the State of **INDIANA**  
Mortgage and Warrant to **MARY ANN KEPPERLING**

of **LAKE** County, in the State of **INDIANA**, the following described  
Real Estate in **LAKE** County, in the State of Indiana, as follows, to-wit:

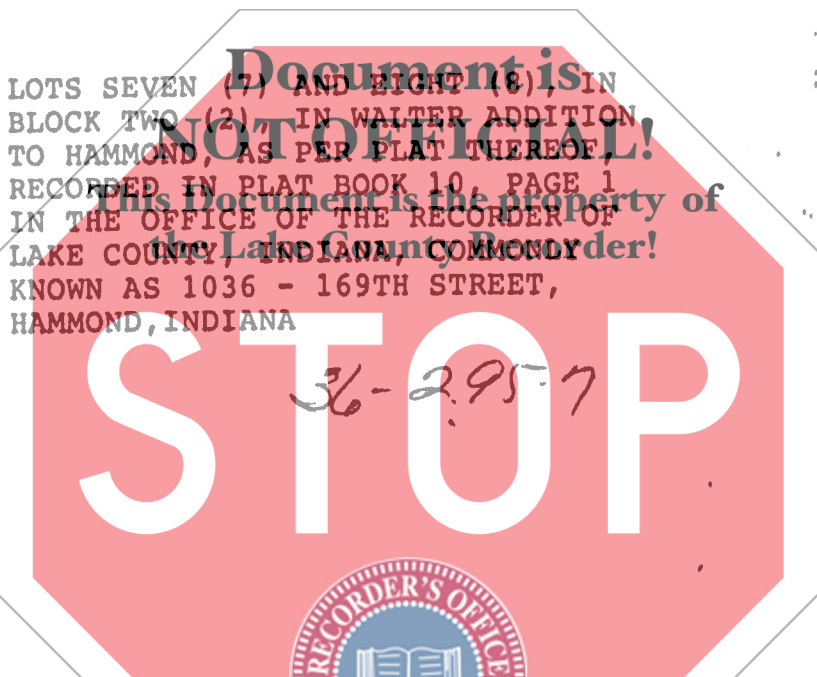

LOTS SEVEN (7) AND EIGHT (8), IN  
BLOCK TWO (2), IN WALTER ADDITION  
TO HAMMOND, AS PER PLAT THEREOF,  
RECORDED IN PLAT BOOK 10, PAGE 1  
IN THE OFFICE OF THE RECORDER OF  
LAKE COUNTY, INDIANA, COMMON  
KNOWN AS 1036 - 169TH STREET,  
HAMMOND, INDIANA

96084798

95 DEC 25 11 18:55  
MARGARETTE CLEBLAND  
RECORDER  
LAKE COUNTY  
FILED FOR RECORD

and the mortgagor expressly agree to pay the sum of money above secured, without relief from valuation or appraisal laws; and upon failure to pay any one of said notes, or any part thereof, at maturity, or the interest thereon, or any part thereof, when due, or the taxes or insurance as hereinafter stipulated, then all of said notes are to be due and collectible, and this mortgage may be foreclosed accordingly. And it is further expressly agreed, that until all of said notes are paid, said mortgagor will keep all legal taxes and charges against said premises paid as they become due, and will keep the buildings thereon insured for the benefit of the mortgagee, at **16%** interest may appear and the policy duly assigned to the mortgagee, to the amount of **\$6000.00 (SIX THOUSAND and NO CENTS)** Dollars, and failing to do so, said mortgagee, may pay said taxes or insurance, and the amount so paid, with per cent interest thereon, shall be a part of the debt secured by this mortgage.

In Witness Whereof, the said mortgagor has hereunto set their hands and seal this first day of November 19 96

Robert A. Dzurovack (Seal) Beverly J. Dzurovack (Seal)  
(ROBERT A. DZUROVACK) (BEVERLY J. DZUROVACK)  
\_\_\_\_\_  
(Seal) \_\_\_\_\_ (Seal)

STATE OF INDIANA, **LAKE** COUNTY, ss:

Before me, the undersigned, a Notary Public in and for said County, this...**FIRST**...  
.....day of **NOVEMBER** 19...**96** came.....  
**MARY ANN KEPPERLING**  
**ROBERT & BEVERLY DZUROVACK (husband & wife)**

....., and acknowledged the execution of the foregoing instrument.  
Witness my hand and official seal.

My Commission expires.....**5/6/2000**..

Lynne M. McKray  
**LYNNE MCKRAY** Notary Public  
900 KS