

THIS FORM HAS BEEN PREPARED FOR USE IN THE STATE OF INDIANA BY LAWYERS ONLY. THE SELECTION OF A FORM OF INSTRUMENT, FILLING IN BLANK SPACES, STRIKING OUT PROVISIONS, AND INSERTION OF SPECIAL CLAUSES, MAY CONSTITUTE THE PRACTICE OF LAW WHICH SHOULD ONLY BE DONE BY A LAWYER.

MAIL TAX BILLS TO:

QUITCLAIM DEED

DULY ENTERED FOR TAXATION SUBJECT TO FINAL ACCEPTANCE FOR TRANSFER.

THIS INDENTURE WITNESSETH, that OLGA FAYE MILLER

(NOV 27 1996)

GRANTOR(S) of WHITE County in the State of INDIANA

SAMUEL H. BIRCH
AUDITOR, LAKE COUNTY

QUITCLAIM(S) to FRED SCOTT

GRANTEE(S) of LAKE County in the State of INDIANA

In consideration of One Dollar (\$1.00) and other valuable consideration, the receipt and sufficiency of which are hereby acknowledged, the following described real estate in LAKE County, in the State of Indiana:

LOTS 9 AND 10, BLOCK 6.
FRANKLIN ADDITION TO THE CITY OF HAMMOND
AS SHOWN IN PLAT BOOK 41, PAGE 16,
LAKE COUNTY, INDIANA.
KEY # 2633-0155-0007, 01773

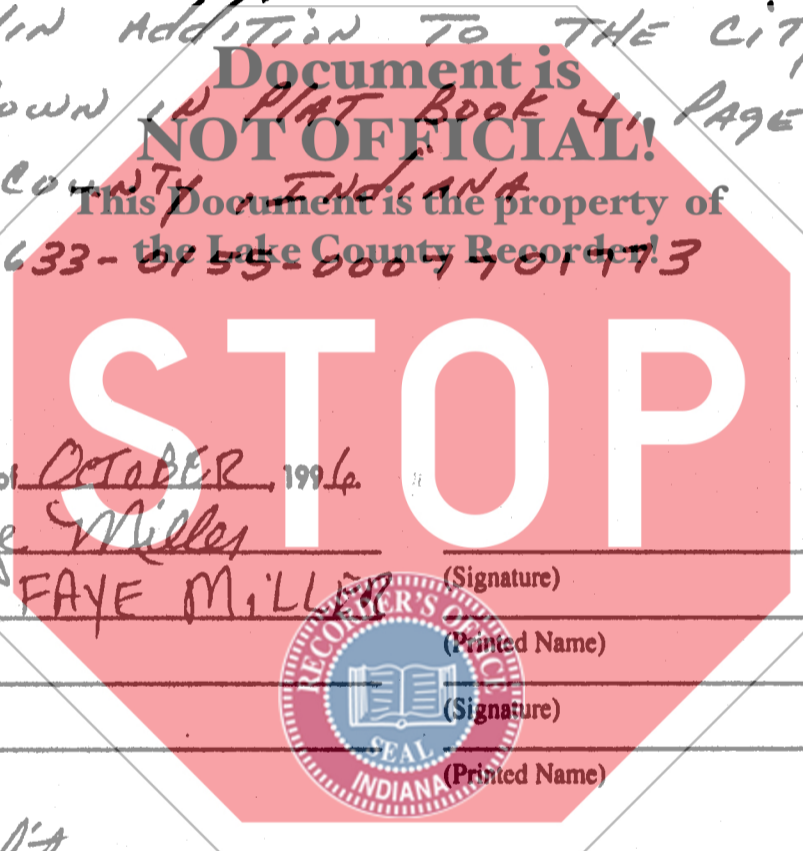

96078445

STATE OF INDIANA
LAKE COUNTY
FILED FOR RECORDING
96 NOV 27 PM 1:11
MARGARET E. WILLIAMS
RECORDER

Dated this 24th day of OCTOBER, 1996.
Olga Faye Miller (Signature)
OLGA FAYE MILLER (Printed Name)

(Signature)

(Printed Name)

STATE OF INDIANA
COUNTY OF White SS:

Before me, the undersigned, a Notary Public in and for said County and State, this 24th day of October, 1996, personally appeared: _____ and acknowledged the execution of the foregoing deed. In witness whereof, I have hereunto subscribed my name and affixed my official seal.

My commission expires: 6-8-99 Signature Leabee E. Williamson
Resident of White County Printed LEABEE E WILLIAMSON, Notary Public

STATE OF _____
COUNTY OF _____ SS:

Before me, the undersigned, a Notary Public in and for said County and State, this _____ day of _____, 199____, personally appeared: _____ and acknowledged the execution of the foregoing deed. In witness whereof, I have hereunto subscribed my name and affixed my official seal.

My commission expires: _____ Signature _____
Resident of _____ County Printed _____, Notary Public

This instrument prepared by _____ Attorney at Law
Attorney Identification No. _____

MAIL TO: Padove, 5625 Holman Avenue
Hammond, IN. 46320

00153
CCH 1220