

THIS FORM HAS BEEN PREPARED FOR USE IN THE STATE OF INDIANA BY LAWYERS ONLY. THE SELECTION OF A FORM OF INSTRUMENT, FILLING IN BLANK SPACES, STRIKING OUT PROVISIONS, AND INSERTION OF SPECIAL CLAUSES, MAY CONSTITUTE THE PRACTICE OF LAW WHICH SHOULD ONLY BE DONE BY A LAWYER.

Mail tax bills to:
2332 Flint Court
Dyer, IN 46311

WARRANTY DEED

THIS INDENTURE WITNESSETH, That Thomas P. Guzek and Sheree L. Guzek,
husband and wife

("Grantor") of Lake County in the State of Indiana
CONVEYS AND WARRANTS TO Thomas A. Pinkowski and Pamela J. Pinkowski,
husband and wife

of Lake County in the State of Indiana
in consideration of One Dollar and other valuable consideration, the receipt and sufficiency of which are hereby acknowledged, the following described real estate in Lake County, in the State of Indiana:

Lot 61 in Pinewood Estates Addition Unit 1, to the Town of Dyer, as per plat thereof, recorded in Plat Book 48 page 98, in the Office of the Recorder of Lake County, Indiana.

Key No. 14-165-61.

Subject to real estate taxes for 1996, due and payable in 1997, and thereafter.

Subject to all covenants, conditions, liens, restrictions and easements of record.

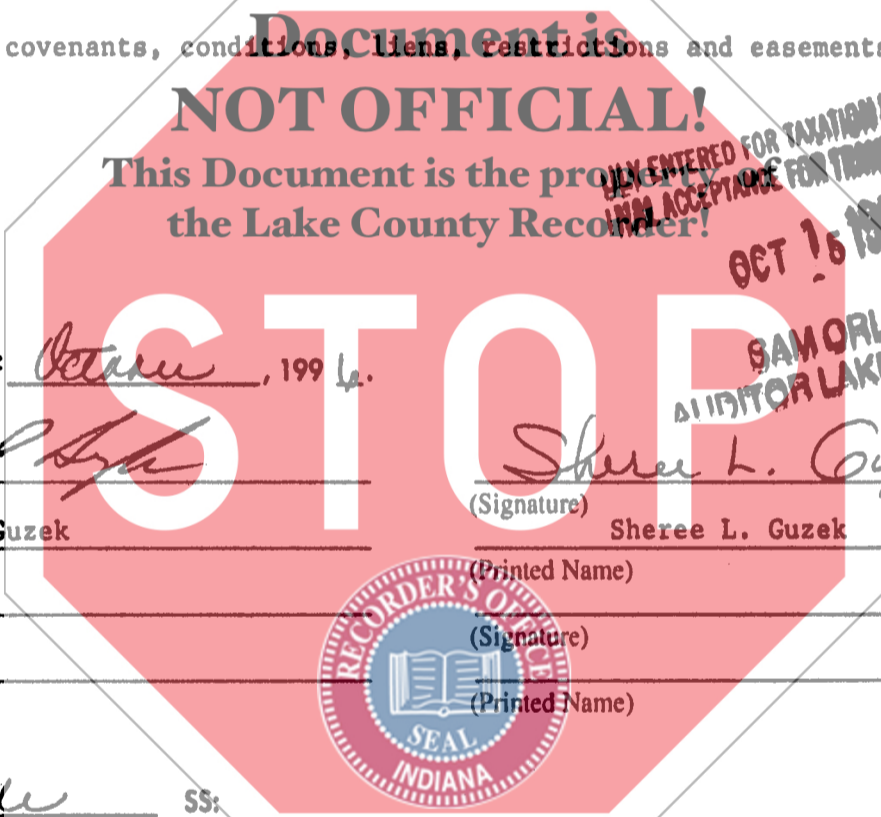

FILED FOR TAXATION INDEX
LEGAL ACCEPTANCE FOR TRANSFER
OCT 16 1996
SAM ORLICH
AUDITOR LAKE CO.

96068788

Dated this 5th day of October, 1996.

Thomas P. Guzek
(Signature) Thomas P. Guzek
(Printed Name)

Sheree L. Guzek
(Signature) Sheree L. Guzek
(Printed Name)

(Signature)
(Printed Name)

(Signature)
(Printed Name)

STATE OF INDIANA
COUNTY OF Allen SS:

Before me, the undersigned, a Notary Public in and for said County and State, this 11th day of October 1996 personally appeared: Thomas P. Guzek and acknowledged the execution of the foregoing deed. In witness whereof, I have hereunto subscribed my name and affixed my official seal.

My commission expires: 1-26-99 Signature *Danni McBride*
Resident of Allen County Printed DANNI J. MCBRIDE, Notary Public

STATE OF Texas
COUNTY OF BEXAR SS:

Before me, the undersigned, a Notary Public in and for said County and State, this 5th day of October, 1996 personally appeared: Sheree L. Guzek

and acknowledged the execution of the foregoing deed. In witness whereof, I have hereunto subscribed my name and affixed my official seal.
My commission expires: 02-20-2000 Signature *Danny E. Tinsley*
Resident of HAYS County Printed DANNY E. TINSLEY, Notary Public

This instrument prepared by Mark Lucas, Lucas, Holcomb & Medrea, 300 E. 90th Drive, Attorney at Law
Attorney Identification No. _____ Easton Court, Merrillville, IN 46410
MAIL TO:

001005
1000
Su