

3

25-10-20

Grant of Easement

This indenture Witnesseth that Susan E. Elder and Thomas A. Elder, owners of the following described property to wit:

See attached legal and survey of Parcel "B",

Hereby give and grant to Susan E. Elder and Thomas A. Elder for the sum of one dollar (\$1.00), the receipt of which is hereby acknowledged, an easement in perpetuity for sanitary sewer purposes through, under and across the above described real property according to the following described course to wit:

That Part of Parcel "B", See legal and survey attached. A 20 foot sewer easement with center line described as follows.

See legal of easement attached.

In Witness Whereof, the said Grantors have affixed their hands and seals this 28 of September, 1996.

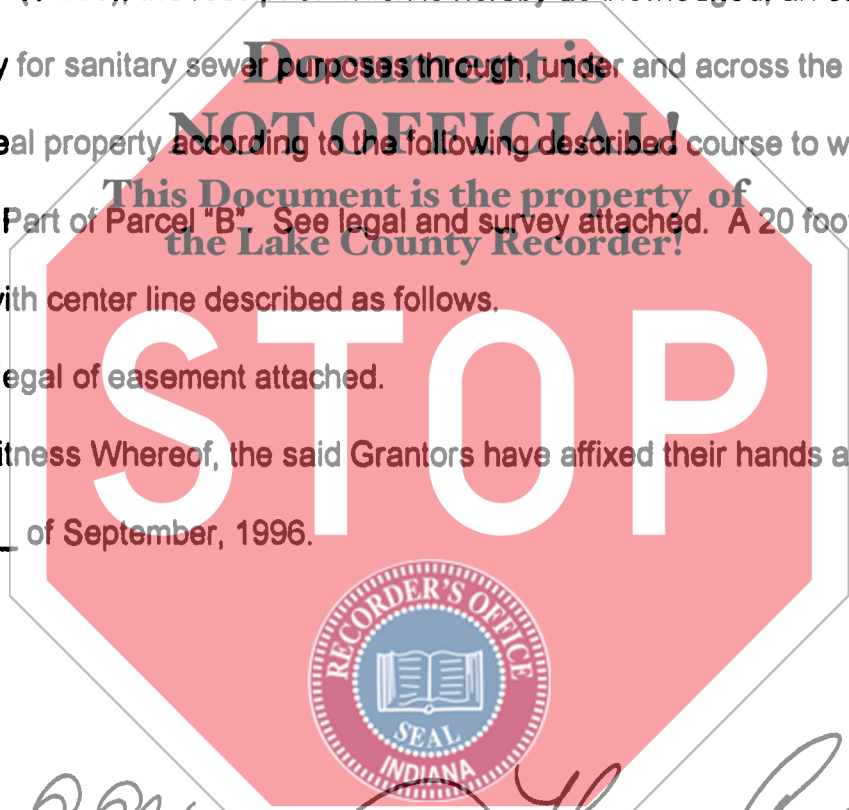

Susan E. Elder

Susan E. Elder

Thomas A. Elder

Thomas A. Elder

96064973

STATE OF INDIANA
LAKE COUNTY
FILED FOR RECORD
96 SEP 30 PM 3:52
MARGARET L. CLAY
RECORDER

FILED

SEP 30 1996

SAM ORLICH
AUDITOR LAKE COUNTY

Fleming Realty P.O. Box 907 C.P. 46307

001752

*1380
CS*

STATE OF INDIANA)
COUNT OF LAKE)

Before me the undersigned, a Notary Public in and for Lake County, Indiana,
personally appeared Susan E. Elder and Thomas A. Elder who signed the above
request.

Witness my hand and seal this 18 day of September, 1996.

My Commission Expires: _____

Document is
NOT OFFICIAL!
VICTORIA MARCUMOV
This Document is the property of
the Lake County Recorder!
My Commission Expires November 23, 1997
Recorder of Lake County, Indiana

Victoria Marcumov

Jean E. Freelove, Notary Public

County of Residence: _____

STOP



Torrenge Engineering, Inc.

REGISTERED PROFESSIONAL ENGINEERS & LAND SURVEYORS

907 RIDGE ROAD

MUNSTER, INDIANA 46321

Office (219) 836-8918

Fax (219) 836-1138

LEGAL DESCRIPTION OF A 20 FOOT SEWER EASEMENT

DESCRIPTION: Part of the Southeast Quarter of Section 35, Township 34 North, Range 9 West of the Second Principal Meridian, being a 20 foot sewer easement whose centerline is more particularly described as follows: Commencing at the Southeast corner of the Southeast Quarter of said Section 35; thence West, along the South line of said Southeast Quarter a distance of 515.0 feet; thence North $0^{\circ} 08' 00''$ West, a distance of 87.59 feet, to the point of beginning of said centerline of 20 feet sewer easement; thence continuing North $0^{\circ} 08' 00''$ West, a distance of 412.41 feet, to the point of termination of said centerline, all in Cedar Creek Township, Lake County, Indiana.

Prepared for:
Prepared by:
Date:

Lew Lain
Torrenge Engineering, Inc.
September 25, 1996

