

THIS FORM HAS BEEN APPROVED BY THE INDIANA STATE BAR ASSOCIATION FOR USE BY LAWYERS ONLY. THE SELECTION OF A FORM OF INSTRUMENT, FILLING IN BLANK SPACES, STRIKING OUT PROVISIONS AND INSERTION OF SPECIAL CLAUSES, CONSTITUTES THE PRACTICE OF LAW AND MAY ONLY BE DONE BY A LAWYER.

Mail tax bills to:
1568 Grant St.
Gary, IN 46404

Tax Key No.: 47-159-24

WARRANTY DEED

→ This indenture witnesseth that Malty M. Earvin

of Lake County in the State of Indiana

Convey and warrant to Melvin Thomas, III and Arnella Thomas, Husband and Wife

96064928

of Lake County in the State of Indiana
for and in consideration of Ten Dollars, (\$10.00), and other good and valuable considerations
the receipt whereof is hereby acknowledged, the following Real Estate in Lake County
in the State of Indiana, to wit:

Lots 23 and 24, Block 1, Tolleston Land Company's
Second Addition to Tolleston, as shown in Plat,
Book 7, page 36, Lake County, Indiana.

Commonly known as: 1568 Grant Street
Gary, Indiana 46404

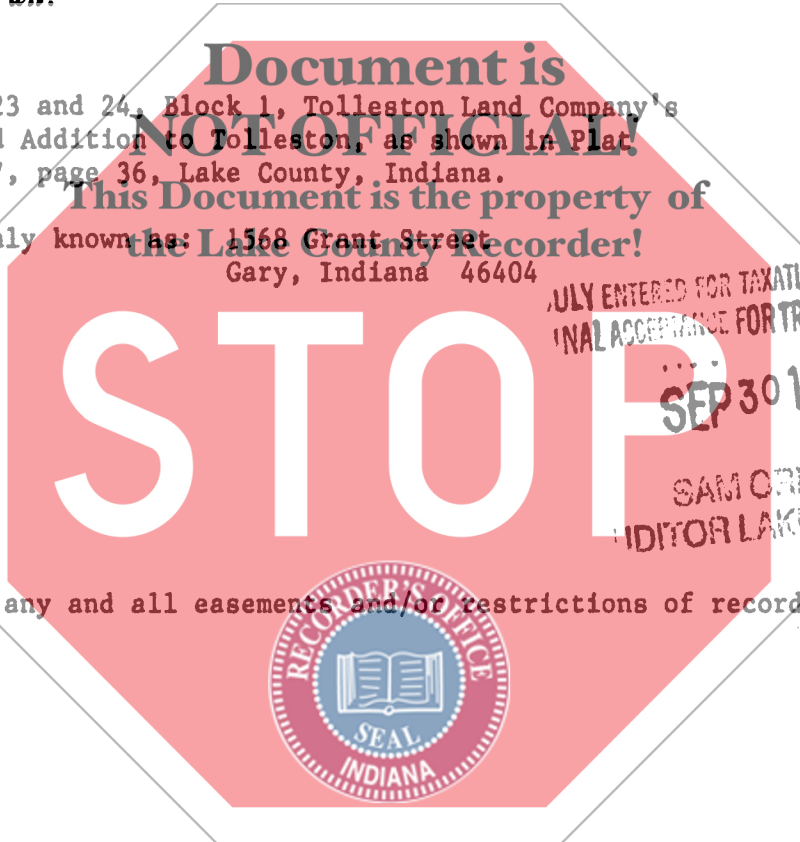

Subject to any and all easements and/or restrictions of record.

State of Indiana, Lake County, ss:

Before me, the undersigned, a Notary Public in and for said County and State, this 23rd day of September 1996 personally appeared:

Malty M. Earvin and Winnes Frazier
(Power of Attorney)

Dated this 23rd Day of September 1996

Malty M. Earvin
Malty M. Earvin

Winnes Frazier
POWER OF ATTORNEY

And acknowledged the execution of the foregoing deed. In witness whereof, I have hereunto subscribed my name and affixed my official seal. My commission expires 12-28-96 1996

Terry C. Gray
Notary Public

Resident of Lake County.

This instrument prepared by Terry C. Gray, 2210 W. 11th Ave.; Gary, IN 46404 Attorney at Law

001744

ck 7517
es 201
10