

Mail to  
→ Pascal W. Abel  
4608 Pierce St.  
Gary, Ind. 46408

# WARRANTY DEED

THIS INDENTURE WITNESSETH, That **CURTIS E. WOODFAULK** (GRANTOR)

of **LAKE** County, in the State of **INDIANA**

Convey and Warrant to **PASCAL W. ABEL** (GRANTEE)

of **LAKE** County, in the State of **INDIANA** for and in consideration  
of **EIGHT THOUSAND FIVE HUNDRED & NO/100**-----Dollars

the receipt whereof is hereby acknowledged, the following described Real Estate in **LAKE** County  
in the State of Indiana, to-wit:

**LEGAL DESCRIPTION: LOT 18 AND THE WEST 1/2 FEET OF LOT 19 IN  
BLOCK 1 IN JEFFERSON LAND & REALTY COMPANY SUBDIVISION NO. 1  
TO TOLLESTON, AS PER PLAT THEREOF, RECORDED IN PLAT BOOK 6,  
PAGE 48, IN THE OFFICE OF THE RECORDER OF LAKE COUNTY, INDIANA.**

**ALSO COMMONLY KNOWN AS 2922 W. 12TH AVE. GARY, IND.**

**GRANTEE HEREIN AGREE TO ASSUME AND PAY 1995 TAXES PAYABLE IN 1996  
AND ALL TAXES THEREAFTER.**

**SUBJECT TO ALL EASEMENTS, CONVENANTS, RIGHT OF WAY, AGREEMENTS  
AND RESTRICTIONS OF RECORD, IF ANY.**

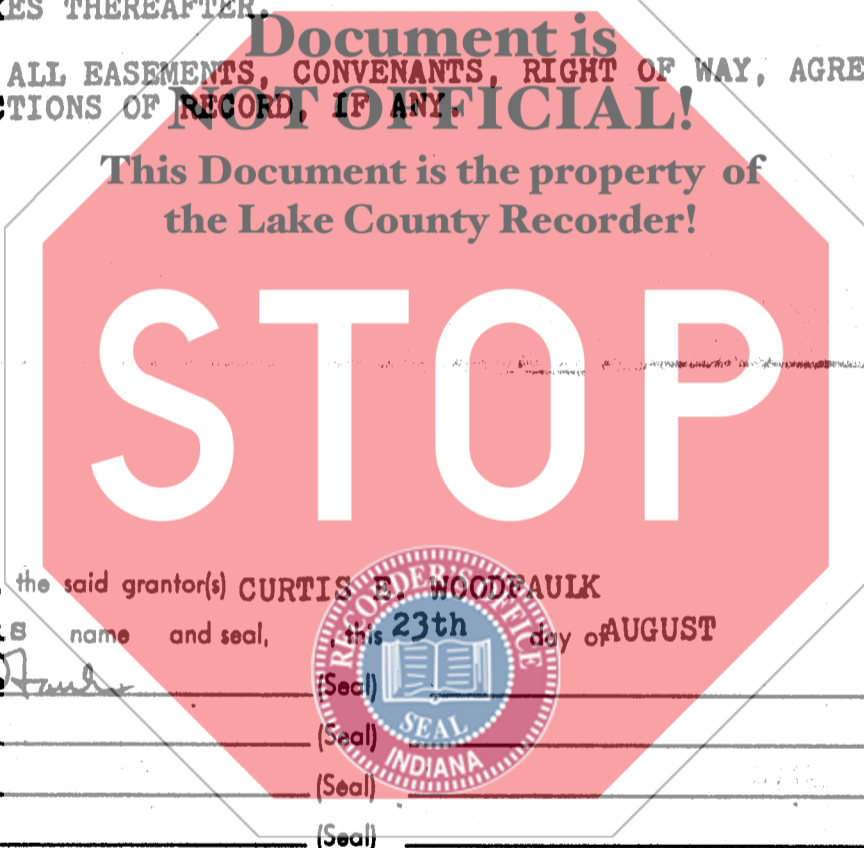

96064015

MARGARETE CLEVELAND  
RECORDER

96 SEP 25 PM 1:44

STATE OF INDIANA  
LAKE COUNTY  
Sign in BLUE INK/Red Ink/Red Copies

IN WITNESS WHEREOF, the said grantor(s) **CURTIS E. WOODFAULK**  
has hereunto affixed his name and seal, this 23th day of AUGUST 1996.  
Curtis E. Woodfaulk (Seal) \_\_\_\_\_ (Seal)  
\_\_\_\_\_  
\_\_\_\_\_  
\_\_\_\_\_  
(Seal) \_\_\_\_\_ (Seal)



Notary Seal STATE OF INDIANA, LAKE County, ss: Corporate Seal

Before me, the undersigned, a Notary Public in and for said County and State,  
this 23rd day of AUGUST, 1996,  
personally appeared CURTIS E. WOODFAULK

and acknowledged the execution of the foregoing deed.  
\_\_\_\_\_  
Notary Public  
WANDA CASTRO MARCH 15, 1999  
My Commission expires

Auditor Stamp JULY ENTERED FOR TAXATION SUBJECT TO RECORD  
FINAL ACCEPTANCE FOR TRANSFER  
SEP 25 1996  
SAM ORLICH  
AUDITOR LAKE COUNTY

001419

This Document Prepared by PASCAL W. ABEL

es  
w  
10/13

(Do not record this side unless affidavits are used)

Notary Seal

STATE OF INDIANA, \_\_\_\_\_ County, ss:

Before me, the undersigned, a Notary Public in and for said County and State,

this \_\_\_\_\_ day of \_\_\_\_\_, 19\_\_\_\_,

personally appeared \_\_\_\_\_

\_\_\_\_\_

\_\_\_\_\_

and acknowledged the execution of the annexed deed.

\_\_\_\_\_ Notary Public

My Commission expires \_\_\_\_\_

Sign in BLACK INK for better Micro copies

Notary Seal

STATE OF INDIANA, \_\_\_\_\_ County, ss:

Before me, the undersigned, a Notary Public in and for said County and State,

this \_\_\_\_\_ day of \_\_\_\_\_, 19\_\_\_\_,

personally appeared \_\_\_\_\_

\_\_\_\_\_

\_\_\_\_\_

and acknowledged the execution of the annexed deed.

\_\_\_\_\_ Notary Public

My Commission expires \_\_\_\_\_

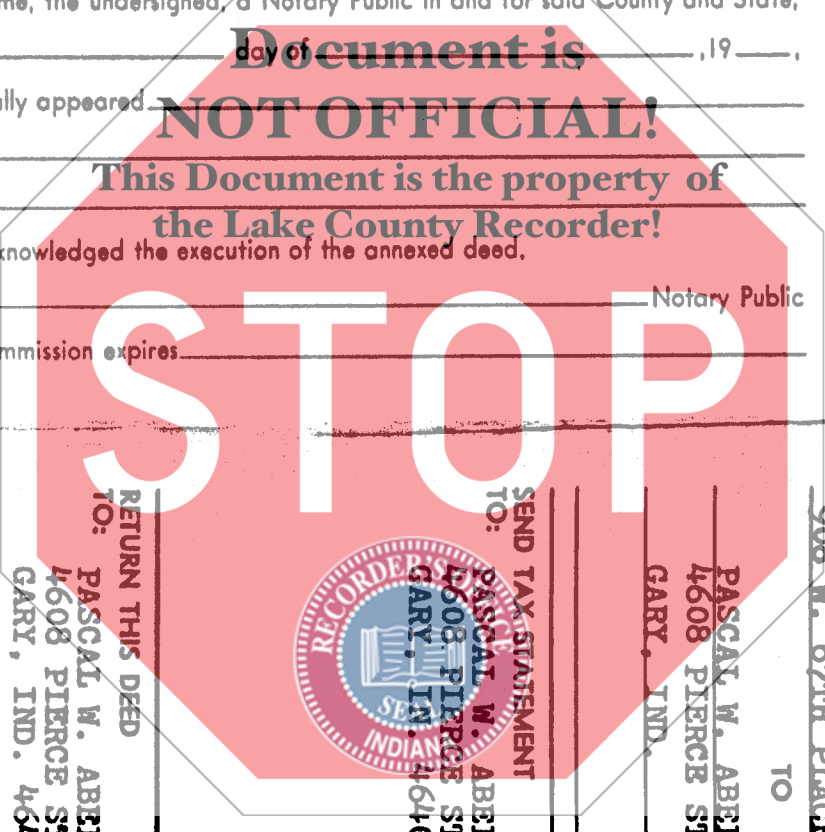

RETURN THIS DEED TO: PASCAL W. ABEL 4608 PIERCE ST. GARY, IND. 46408



SEND TAX STATEMENT TO: PASCAL W. ABEL 4608 PIERCE ST. GARY, IN. 46408

PASCAL W. ABEL 4608 PIERCE ST. GARY, IND.

908 W. 627TH PLACE MERRILLVILLE, IN TO

WARRANTY DEED FROM CURTIS E. WOODFAULK

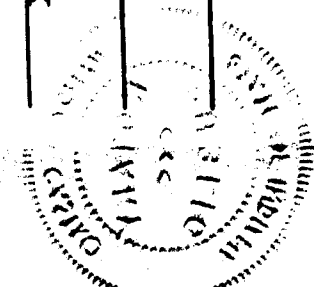

LEGAL FORMS BY STATIONERS INC. 36 N. PENNSYLVANIA ST. INDIANAPOLIS