

488319
MARK CONST

Chicago Title Insurance Company

PARTIAL RELEASE OF MORTGAGE

THIS INDENTURE WITNESSETH, for and in consideration of Ten Dollars (\$10.00) and other good and valuable consideration, the receipt of which is hereby acknowledged, the REX CONSTRUCTION COMPANY, INC., hereinafter "the mortgage company" does hereby release and forever quit any claim it may have under a certain mortgage dated March 10, 1995, and recorded on March 27, 1995 as Document Number 95016030, made by Mesa Limited Partnership, an Illinois limited partnership, to the mortgage to secure payment of a promissory note in the sum of Two Thousand Six Hundred Thirty One and 58/100 (\$2,631.58) to the extent said mortgage affects or encumbers the following described real property in Lake County, Indiana, to-wit:

Parcel 1: Lot 104, Sedona Addition Unit One, as shown in Plat Book 75, Page 70 and as amended by Plat recorded June 10, 1994, in Plat Book 76, Page 67, Lake County, Indiana.

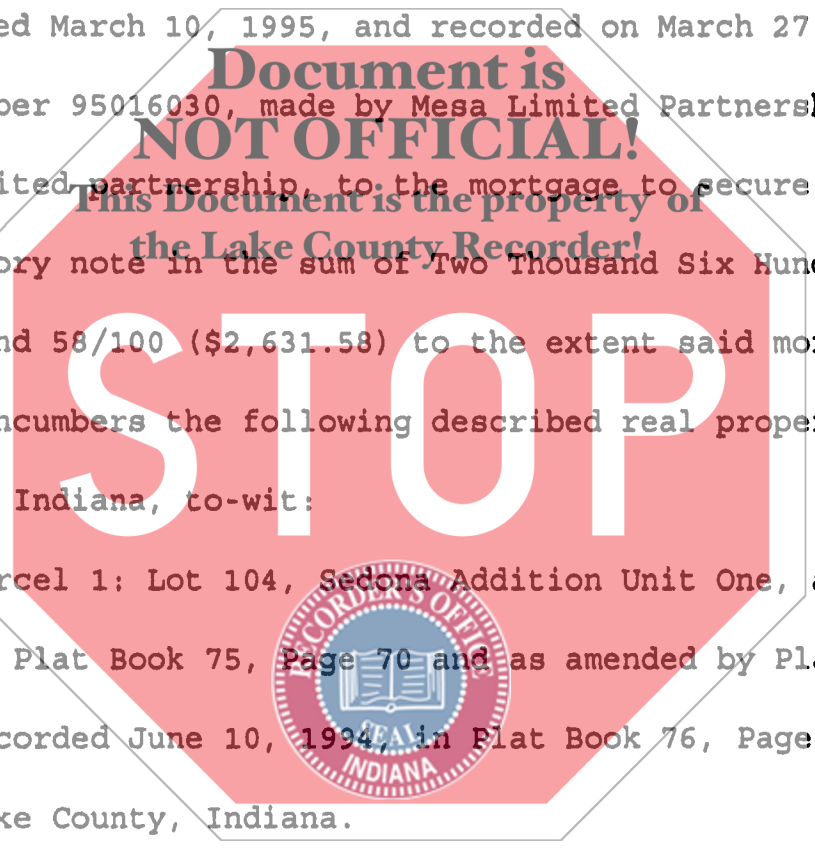

96063073

96 SEP 29 PM 1:09

STATE OF INDIANA
LAKE COUNTY
FILED FOR RECORD

MARGARETTE CLEVELAND
RECORDER

IN WITNESS WHEREOF, the undersigned, duly authorized offices of said Rex Construction Co., Inc., has executed this Partial Release of Mortgage this 9TH day of September, 1996.

12 of 23 AB

Rex Construction Co., Inc.

BY:

Ronald A. Rex

Ronald A. Rex, President

ATTEST:

Olivia A. Perez

STATE OF INDIANA

COUNTY OF LAKE

Document is
NOT OFFICIAL!
This Document is the property of
the Lake County Recorder!

Before me, a Notary Public in and for said County and State, personally appeared Ronald A. Rex, the duly empowered and authorized President of Rex Construction Co., Inc. who acknowledge the execution of the foregoing Partial Release of Mortgage as his voluntary act and deed, for the purposes stated therein, and with full power and authority to so do.

WITNESS my hand and Notarial Seal this 9th day of September, 1996.

My commission Expires:

10-22-96

Resident of Lake County

Olivia A. Perez
Olivia A. Perez, Notary Public

