

2

STATE OF INDIANA)
COUNTY OF LAKE)

SS: MAY 10 11 2 00

IN THE LAKE CIRCUIT
COURT SITTING IN CROWN
POINT, INDIANA

45C0196050P00000

ROBERT C. TURNER)
PATRICIA M. TURNER,)
HUSBAND AND WIFE)

Plaintiffs

vs

CONSOLIDATED RAIL)
CORPORATION, A PENNSYLVANIA)
CORPORATION AND THE UNKNOWN)
HEIRS REPRESENTATIVES,)
DEVISEES, WIDOWS, WIDOWERS,)
LEGATEES, EXECUTORS,)
ADMINISTRATORS, HUSBAND AND)
WIVES, RECEIVORS, LESSORS)
SUCCESSORS AND ASSIGNS OF)
JAMES T. HOLTON AND)
CATHERINE J. HOLTON, HIS)
WIFE.)

Defendants

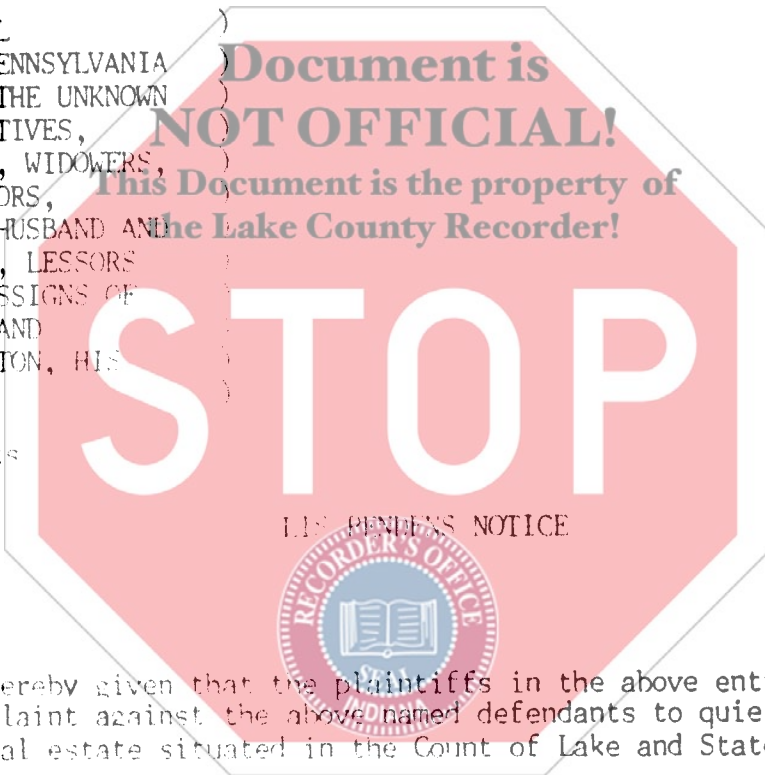

Notice is hereby given that the plaintiffs in the above entitled cause have filed their complaint against the above named defendants to quiet title to the following described real estate situated in the Count of Lake and State of Indiana, viz:

96029484

96 MAY -3 PM 2:52

RECORDED

1013

Part of the NW $\frac{1}{4}$ Section 5, Township 34 North, Range 8 West of the 2nd P.M., described as: Beginning at a point on the South line of said NW $\frac{1}{4}$ and 401.44 feet West of the Southeast corner thereof; thence North 89°20'40" West along the South line of said NW $\frac{1}{4}$ a distance of 190.00 feet; thence North 00°00'00" West parallel to the East line of the NW $\frac{1}{4}$ of said Section 5 a distance of 193.31 feet more or less to the Southwesterly right-of-way of the PCC and St. Louis R.R.; thence Southeasterly along said right-of-way 272.76 feet more or less to the point of beginning.

DESCRIPTION OF RAILROAD RIGHT-OF WAY Part of the SE $\frac{1}{4}$, NW $\frac{1}{4}$ Section 5, Township 34 North Range 8 West of the 2nd P.M., described as follows: Commencing at a point on the South line of said NW $\frac{1}{4}$ and 591.44 feet West of the Southeast corner thereof; thence North 00°00'00" West parallel to the East line of said NW $\frac{1}{4}$ a distance of 193.31 feet more or less to the Southwesterly right-of-way line of the PCC and St. Louis RR; thence Northeasterly at right angles to said Southwesterly right-of-way 50' 00 feet; thence Southeasterly along the center line of said right-of-way to the North line of Summit Street (60 feet wide); thence South 89°20'40" West along the North line of Summit Street, 70.55 feet more or less to the Southwesterly line of said railroad; thence Northwesterly along said Southwesterly line, 230.54 feet more or less to the point of beginning.



This Document is the property of the Lake County Recorder!

Richard A. Parks
Richard A. Parks
Attorney No 5620-45
Attorney for Plaintiffs
P.O. Box 549
Crown Point, IN 46307
(219) 663-0099

Filed and recorded this 5 day of May, 1996

Anna M. Hinton
Clerk, Lake Circuit Court
Judith A. Perola
By: