

THIS FORM HAS BEEN PREPARED FOR USE WITHIN THE STATE OF INDIANA. THE SELECTION OF A FORM OF INSTRUMENT, FILLING IN BLANK SPACES, STRIKING OUT PROVISIONS, AND INSERTION OF SPECIAL CLAUSES, MAY CONSTITUTE THE PRACTICE OF LAW AND SHOULD ONLY BE DONE BY A LAWYER.

Mail tax bills to:  
3177 W. 20th Place  
Gary, IN 46404

Tax Key No.: 45-217-25

# WARRANTY DEED

This indenture witnesseth that Charles W. Jackson and Hope I. Jackson,  
husband and wife

of Lake County in the State of Indiana

Convey and warrant to Michael A. Beckham

of Lake County in the State of Indiana  
for and in consideration of Ten Dollars (\$10.00) and other good and valuable consideration  
the receipt whereof is hereby acknowledged, the following Real Estate in Lake County  
in the State of Indiana, to wit:

Lots 25 and 26 in Block 4 in Keystone Land Co's Addition to Gary, as per plat thereof, recorded in Plat Book 9 page 33, in the Office of the Recorder of Lake County, Indiana.

Subject to real estate taxes for 1995, due and payable in 1996, and thereafter

Subject to all covenants, conditions, liens, restrictions and easements of record.

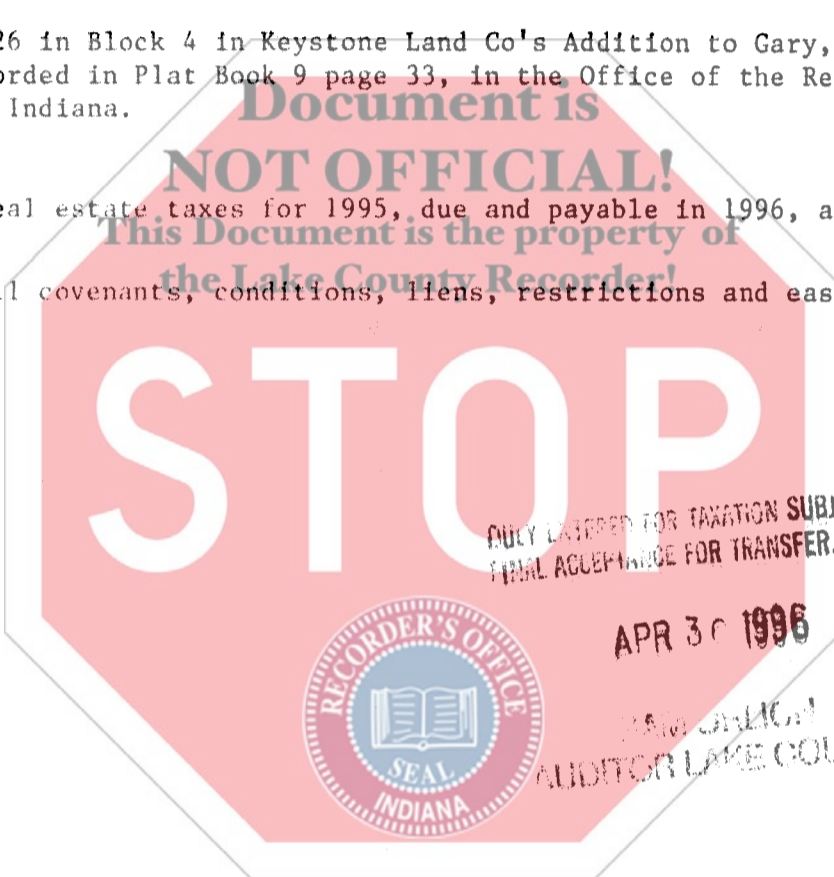

STATE OF INDIANA  
LAKE COUNTY  
FILED FOR RECORD  
96 MAY - 1 AM 10:01  
RECORDER

NOTULY ENTERED FOR TAXATION SUBJECT TO FINAL ACCEPTANCE FOR TRANSFER.

APR 30 1996

AUDITOR LAKE COUNTY

State of Indiana, Lake County, ss:  
Before me, the undersigned, a Notary Public in and for said County and State, this 25th day of April 19 96 personally appeared:

Charles W. Jackson and Hope I. Jackson,  
husband and wife

Dated this 25th Day of April 1996  
*Charles W. Jackson*  
Charles W. Jackson  
*Hope I. Jackson*  
Hope I. Jackson

And acknowledged the execution of the foregoing deed. In witness whereof, I have hereunto subscribed my name and affixed my official seal. My commission expires January 26 19 99

*Linda J. McBride*  
Linda J. McBride Notary Public

Resident of Lake County.

This instrument prepared by Mark Lucas, Lucas, Holcomb & Medrea, 300 E. 90th Drive, Attorney at Law  
Easton Court, Merrillville, IN 46410

12.00  
27  
m