

2

2653 High Sierra  
Valpo 46383

When Recorded Mail To:  
INDIANA FEDERAL BANK  
ATTN: SHARON O'DELL  
808 VALE PARK ROAD  
VALPARAISO, IN 46383  
LOAN# 8938409/G20/MM  
PIF: 3/19/96

96026211

**RELEASE OF MORTGAGE BY CORPORATION**

KNOW ALL MEN BY THESE PRESENTS, that Dovenmuehle Mortgage Company LP, a Delaware limited partnership by, Dovenmuehle Mortgage, Inc. (f/k/a Percy Wilson Mortgage and Finance Corporation and f/k/a Gildorn Mortgage Midwest Corporation), a Corporation of the State of Delaware, its sole general partner, whose address is 1501 Woodfield Road, Suite 400 East, Schaumburg, Illinois 60173-4982, in consideration of ONE DOLLAR and other good and valuable consideration, the receipt of which is hereby acknowledged, does hereby REMISE, RELEASE, CONVEY AND QUIT CLAIM unto MARK A VAN ZUIDAM AND KARYN A VAN ZUIDAM

STATE OF INDIANA  
LAKE COUNTY  
FILED FOR RECORD

96 APR 22 AM 11:08  
REC'D  
CLERK

HUSBAND AND WIFE  
and his/her/their/its successors and assigns, all of the right, title, interest, claim or demand whatsoever which the undersigned may have acquired in, through or by that certain Mortgage dated NOVEMBER 18TH, 1993, and recorded in the Recorder's Office of LAKE County, in the State of INDIANA, in Book \_\_\_\_\_, Page \_\_\_\_\_, as Document Number 93079137, together with all appurtenances and privileges thereunto belonging or appertaining. A legal description of the real estate encumbered thereby is as follows: LOT 252 IN UNIT 4, FOXWOOD ESTATES, AN ADDITION TO THE TOWN OF SCHERERVILLE, AS PER PLAT THEREOF, RECORDED IN PLAT BOOK 71 PAGE 53 IN THE OFFICE OF THE RECORDER OF LAKE COUNTY, INDIANA.

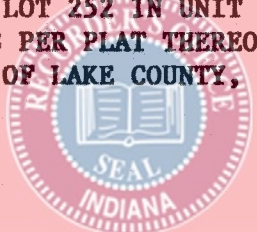

Property Address: 4918 CARDINAL CT  
SCHERERVILLE, INDIANA 46375

Parcel Identification Number:

IN WITNESS WHEREOF, Dovenmuehle Mortgage Company LP, a Delaware limited partnership by, Dovenmuehle Mortgage, Inc., a Corporation of the State of Delaware, its sole general partner, has caused these presents to be executed and attested by its duly authorized officers and its Corporate Seal to be hereunto affixed this 4TH day of APRIL, 1996.

Dovenmuehle Mortgage Company LP, a Delaware limited partnership by, Dovenmuehle Mortgage, Inc., a Corporation of the State of Delaware, its sole general partner,

Toni M. Dipper  
BY: Toni M. Dipper  
Its Assistant Secretary

Joyce K. Mantve  
BY: Joyce K. Mantve  
Its Assistant Vice President

1200  
203  
CP

STATE OF ILLINOIS }  
COUNTY OF COOK }

I, Kayt E. DelBoccio, a Notary Public in and for said County in the State aforesaid, **DO HEREBY CERTIFY** that Joyce K. Manfre, personally known to me to be the Assistant Vice President of Dovenmuehle Mortgage, Inc., a Delaware Corporation, sole general partner of Dovenmuehle Mortgage Company, L.P., a Delaware limited partnership and Toni M. Dipper, personally known to me to be the Assistant Secretary of said Corporation, whose names are subscribed to the within Instrument, appeared before me this day in person and severally acknowledged that as such Assistant Vice President and Assistant Secretary, they respectively signed and delivered the said Instrument of writing as Assistant Vice President and Assistant Secretary of said Corporation, and caused the corporate seal of said Corporation to be thereunto affixed, as their free and voluntary act and as the free and voluntary act and deed of said Corporation and limited partnership, for the uses and purposes therein set forth.

GIVEN under my hand and Notarial Seal this 4TH day of APRIL, A.D., 1999.



Kayt E. Delboccio, Notary Public  
Commission Expiration: 09-01-99



This instrument was prepared by: Dovenmuehle Mortgage, Inc.  
1501 Woodfield Road, Schaumburg, IL 60173

**FOR THE PROTECTION OF THE OWNER, THIS RELEASE SHALL BE FILED WITH THE RECORDER OF DEEDS IN WHOSE OFFICE THE MORTGAGE OR DEED OF TRUST WAS FILED.**