



TICOR TITLE INSURANCE

Return To: TICOR TITLE/CROWN POINT

200221

WARRANTY

This Indenture Witnesseth

That ~~CHRISTOPHER R. FISHER AND SILVIJA FISHER, HUSBAND AND WIFE~~

of ~~LAKE~~ County, and State of ~~INDIANA~~

CONVEY AND WARRANT

To ~~MIRJANA GRUEVSKI~~

of ~~LAKE~~ County, in the State of ~~INDIANA~~

for the sum of ~~TEN DOLLARS AND OTHER VALUABLE CONSIDERATION~~

the following described REAL ESTATE in ~~LAKE~~ County, in the

State of Indiana, to-wit:

LOT 1 IN INDIAN RIDGE ADDITION UNIT 4, BLOCK 2, IN THE CITY OF CROWN POINT, AS PER PLAT THEREOF, RECORDED IN PLAT BOOK 67 PAGE 45, IN THE OFFICE OF THE RECORDER OF LAKE COUNTY, INDIANA.

COMMONLY KNOWN AS: 1401 W. 97TH AVE., CROWN POINT, IN 46307

SUBJECT TO PAST AND CURRENT YEAR REAL ESTATE TAXES.

SUBJECT TO EASEMENTS, RESTRICTIONS AND COVENANTS OF RECORD, IF ANY.

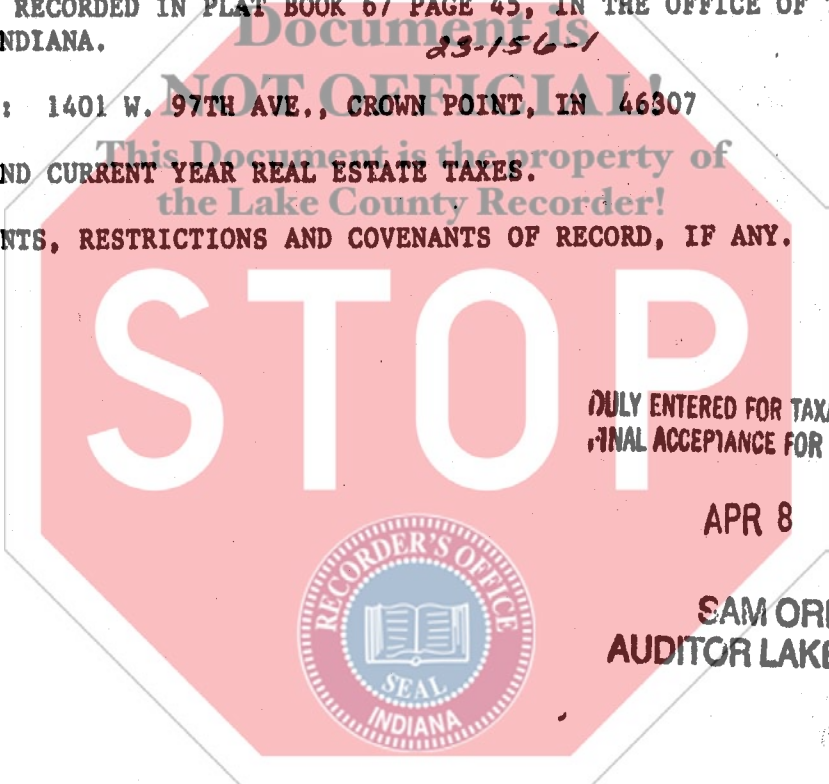

STATE OF INDIANA
LAKE COUNTY
FILED FOR RECORD
96 APR -9 AM 9:52
MARGARETTE CLELAND
RECORDER

DULY ENTERED FOR TAXATION SUBJECT TO FINAL ACCEPTANCE FOR TRANSFER.

APR 8 1996

SAM ORLICH
AUDITOR LAKE COUNTY

IN WITNESS WHEREOF, The said ~~CHRISTOPHER R. FISHER AND SILVIJA FISHER, HUSBAND AND WIFE~~

Have hereunto set THEIR Hand S and seal this 2ND day of APRIL 19-96

Christopher R. Fisher (SEAL) *Silvija Fisher* (SEAL)
CHRISTOPHER R. FISHER SILVIJA FISHER

____ (SEAL) _____ (SEAL)
____ (SEAL) _____ (SEAL)

STATE OF INDIANA, ~~LAKE~~ County, ss:

Before me, the undersigned, a Notary Public in and for said County and State, personally appeared the within named ~~CHRISTOPHER R. FISHER AND SILVIJA FISHER, HUSBAND AND WIFE~~ who acknowledged the execution of the foregoing Deed to be THEIR voluntary act and deed.

WITNESS, my hand and Seal this 2ND day of APRIL 19-96
My commission expires SEPTEMBER 12 19-99
Karen Kane
KAREN KANE Notary Public

County of Residence PORTER

Mail Tax Statements to 1401 W. 97TH AVE., CROWN POINT, IN 46307

This instrument prepared by ATTNY. THOMAS K. HOFFMAN

