

24855110

THIS FORM HAS BEEN PREPARED FOR USE IN THE STATE OF INDIANA BY LAWYERS ONLY. THE SELECTION OF A FORM OF INSTRUMENT, FILLING IN BLANK SPACES, STRIKING OUT PROVISIONS, AND INSERTION OF SPECIAL CLAUSES, MAY CONSTITUTE THE PRACTICE OF LAW WHICH SHOULD ONLY BE DONE BY A LAWYER.

Mail tax bills to:

KEY NO.: 45-179-10
TAX UNIT NO. 25

Carolyn R. Durr
4855 Washington Street
Gary, Indiana 46408

WARRANTY DEED

THIS INDENTURE WITNESSETH, That JESSE SOTO and TERRACENA TEMPLE SOTO, husband and wife,

("Grantor") of Lake County in the State of Indiana
CONVEYS AND WARRANTS TO CAROLYN R. DURR

of Lake County in the State of Indiana
in consideration of One Dollar and other valuable consideration, the receipt and sufficiency of which are hereby acknowledged the following described real estate in Lake County, in the State of Indiana:

Lot 10, Block 15, Junedale Subdivision, in the City of Gary, as shown in Plat Book 19, Page 3, in Lake County, Indiana.

SUBJECT, NEVERTHELESS, TO THE FOLLOWING:

1. Taxes for 1995 payable in 1996 and all taxes thereafter.
2. Covenants, easements and restrictions of record.

ADDRESS OF REAL ESTATE: 4855 Washington Street, Gary, Indiana 46408.

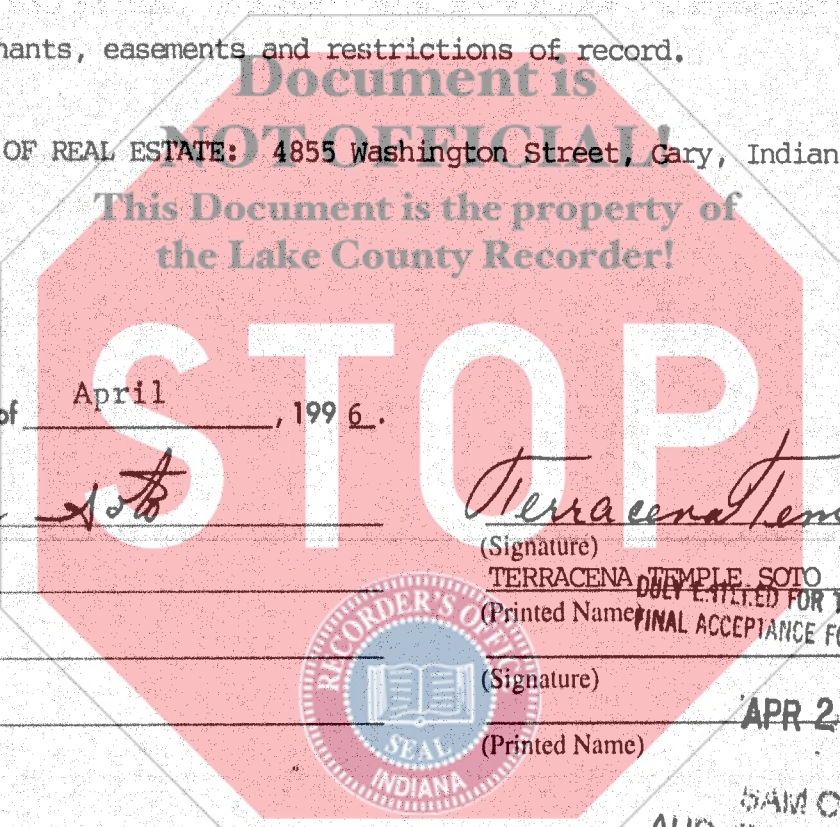

Dated this 1st day of April, 1996.

Jesse Soto
 (Signature)
 JESSE SOTO
 (Printed Name)

Terracena Temple Soto
 (Signature)
 TERRACENA TEMPLE SOTO
 (Printed Name)

(Signature)
 (Printed Name)

(Signature)
 (Printed Name)

STATE OF INDIANA
COUNTY OF LAKE SS:

APR 2 1996
 SAM OPLICH
 AUDITOR LAKE COUNTY

Before me, the undersigned, a Notary Public in and for said County and State, this 1st day of April, 1996, personally appeared: JESSE SOTO and TERRACENA TEMPLE SOTO, husband and wife, and acknowledged the execution of the foregoing deed. In witness whereof, I have hereunto subscribed my name and affixed my official seal.

My commission expires: 12-17-97 Signature *Roberta S. Tate*
 Resident of Porter County Printed Roberta S. Tate Notary Public

STATE OF _____
COUNTY OF _____ SS:

Before me, the undersigned, a Notary Public in and for said County and State, this _____ day of _____, 199____, personally appeared: _____ and acknowledged the execution of the foregoing deed. In witness whereof, I have hereunto subscribed my name and affixed my official seal.

My commission expires: _____ Signature *000196*
 Resident of _____ County Printed _____, Notary Public

This instrument prepared by Edward L. Burke, 8585 Broadway, Suite 600, Merrillville, Attorney at Law
Attorney Identification No. 3004-45 Indiana 46410

MAIL TO:

Chicago Title Insurance Company
96021032

STATE OF INDIANA
LAKE COUNTY
FILED FOR RECORD
96 APR -2 PM 1:44
MARGARETE OLIVELAND
RECORDER

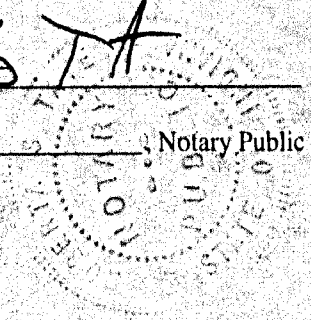
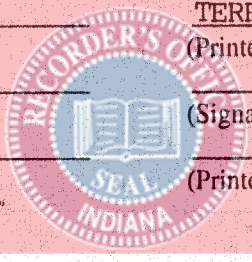

Handwritten initials and date