

THIS FORM HAS BEEN PREPARED FOR USE WITHIN THE STATE OF INDIANA. THE SELECTION OF A FORM OF INSTRUMENT, FILLING IN BLANK SPACES, STRIKING OUT PROVISIONS, AND INSERTION OF SPECIAL CLAUSES, MAY CONSTITUTE THE PRACTICE OF LAW AND SHOULD ONLY BE DONE BY A LAWYER.

Mail tax bills to:

Tax Key No.: 26-276-11

George N. Grahovac and Janis M. Grahovac
1411 North Elmer Avenue
Griffith, IN 46319

WARRANTY DEED

This indenture witnesseth that ALBERT R. TOOLEY and FRANCES TOOLEY,
Husband and Wife

of Lake County in the State of Indiana, Convey and warrant to

GEORGE N. GRAHOVAC and JANIS M. GRAHOVAC,
Husband and Wife

of Lake County in the State of Indiana, for and in consideration of the receipt whereof is hereby acknowledged, the following Real Estate in Lake County in the State of Indiana, to wit:

Lot 51 in the Park 2nd Addition to the Town of Griffith, as per plat thereof, recorded June 21, 1965 in Plat Book 37 page 6, in the Office of the Recorder of Lake County, Indiana. More commonly known as 1411 North Elmer Avenue, Griffith, Indiana.

Subject to:

1. All real estate taxes and assessments due or payable and hereafter;
2. Covenants, easements, restrictions, conditions, rights-of-way and other matters of record.
3. Applicable building codes and zoning ordinances.

COMMUNITY TITLE COMPANY
FILE NO. 77620

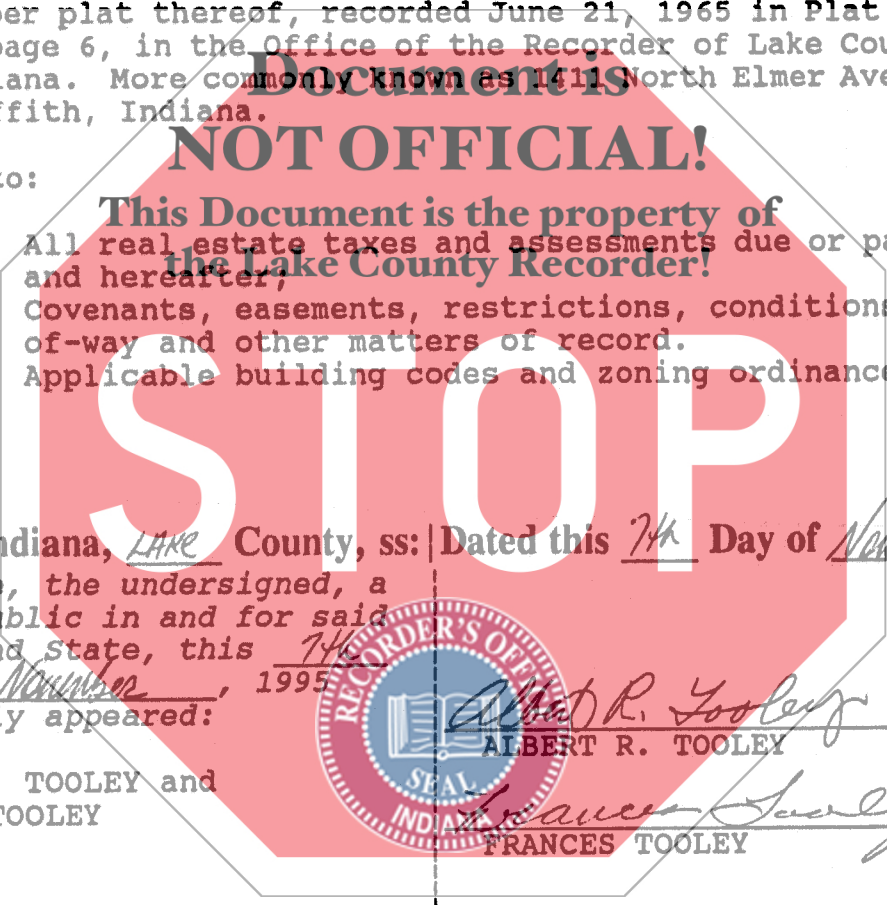

95069337

95 NOV 14 AM 8:54

STATE OF INDIANA
LAKE COUNTY
FILED FOR RECORD

State of Indiana, LAKE County, ss: Dated this 7th Day of November, 1995.

Before me, the undersigned, a Notary Public in and for said County and State, this 7th day of November, 1995, personally appeared:



Albert R. Tooley
ALBERT R. TOOLEY

Frances Tooley
FRANCES TOOLEY

ALBERT R. TOOLEY and
FRANCES TOOLEY

And acknowledged the execution of the foregoing deed. In witness whereof, I have hereunto subscribed my name and affixed my official seal. My commission expires 8/3 1996

FULLY ENTERED FOR TAXATION SUBJECT TO FINAL ACCEPTANCE FOR TRANSFER.

NOV 13 1995

SAM ORLICH
AUDITOR LAKE COUNTY

Daniel W. Slusser
DANIEL W. SLUSSER Notary Public

Resident of LAKE County.

This instrument prepared by John G. Donner, Attorney at Law, T. CLIFFORD FLEMING & ASSOCIATES, P.C., 99 East 86th Avenue, Suite E, Merrillville, Indiana 46410 (219) 769-0420

Mail to: George N. Grahovac and Janis M. Grahovac
1411 North Elmer Avenue
Griffith, IN 46319

000753

10.00
SR