

CORRECTED DEED # 9202 6877

THIS FORM HAS BEEN APPROVED BY THE INDIANA STATE BAR ASSOCIATION FOR USE BY LAWYERS ONLY. THE SELECTION OF A FORM OF INSTRUMENT, FILLING IN BLANK SPACES, STRIKING OUT PROVISIONS AND INSERTION OF SPECIAL CLAUSES, CONSTITUTES THE PRACTICE OF LAW AND MAY ONLY BE DONE BY A LAWYER.

Mail tax bills to:
3999 139th Avenue
Crown Point, IN 46307

Tax Key No. 10-37-36

WARRANTY DEED

This indenture witnesseth that WILLIAM T. PATTON AND REBECCA R. PATTON,

of LAKE County in the State of INDIANA

Convey and warrant to WILLIE T. PATTON AND REBECCA R. PATTON
husband and wife

of LAKE County in the State of INDIANA

for and in consideration of Ten Dollars (\$10.00) and other good and valuable consideration the receipt whereof is hereby acknowledged, the following Real Estate in LAKE County in the State of Indiana, to wit:

THE NORTH 300 FEET OF THE EAST 320 FEET OF THE SOUTH HALF
THE SOUTHWEST QUARTER OF SECTION 25, TOWNSHIP 34 NORTH, RANGE
8 WEST OF THE 2ND P.M., IN LAKE COUNTY, INDIANA
Commonly known as: 3999 139th Avenue
Crown Point, Indiana
Subject to past and current year real estate taxes.
Subject to easements, restrictions, and covenants of record,
if any.

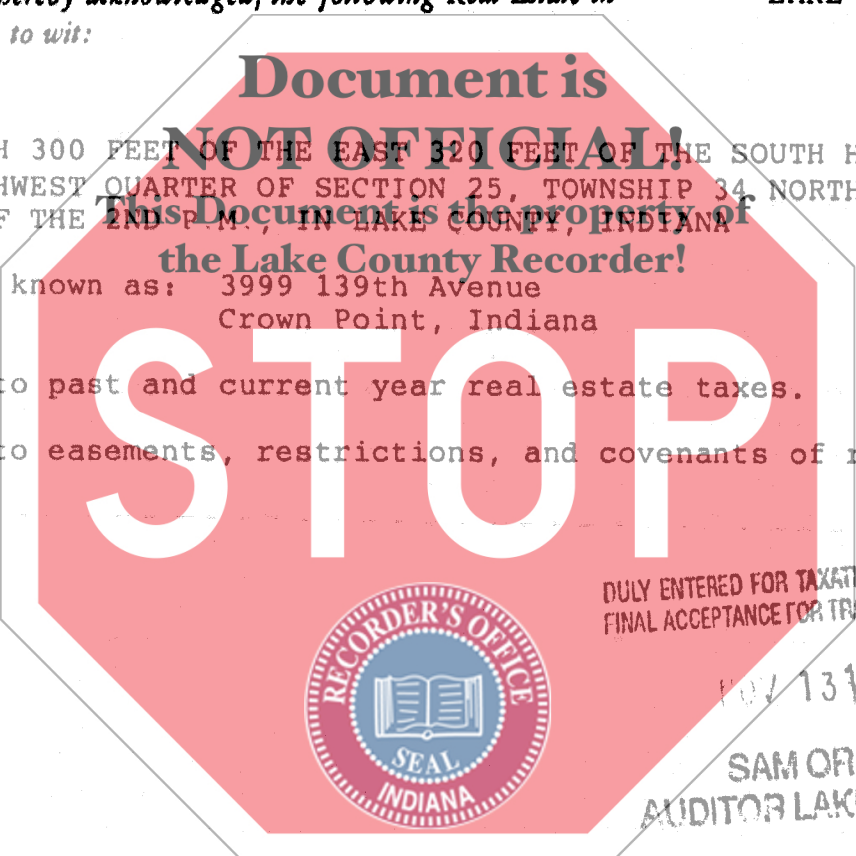

95069159
STATE OF INDIANA
LAKE COUNTY
FILED FOR RECORD
95 NOV 13 AM 10:48
MARGARET E. ORLICH
RECORDER

State of Indiana, LAKE County, ss:
Before me, the undersigned, a Notary Public in and for said County and State, this 8th day of November 1995 personally appeared:

Dated this 8th Day of November 1995

William T. Patton
WILLIAM T. PATTON
Rebecca R. Patton
REBECCA R. PATTON

WILLIAM T. PATTON and REBECCA R. PATTON

And acknowledged the execution of the foregoing deed. In witness whereof, I have hereunto subscribed my name and affixed my official seal. My commission expires 8/2 1997

Janet E. Jikwart
JANET E. JIKWART Notary Public

Resident of Lake County.

This instrument prepared by Mark K. Gruenlinden, 1524 W. 96th, Crown Point, IN Attorney at Law

MAIL TO:

COPYRIGHT THE ALLEN COUNTY INDIANA BAR ASSOCIATION, INC.